



8 Hog Green, Elham - CT4 6TU

Guide Price **£450,000**

Approximate Gross Internal Area = 95 sq m / 1027 sq ft
Garage = 16 sq m / 167 sq ft

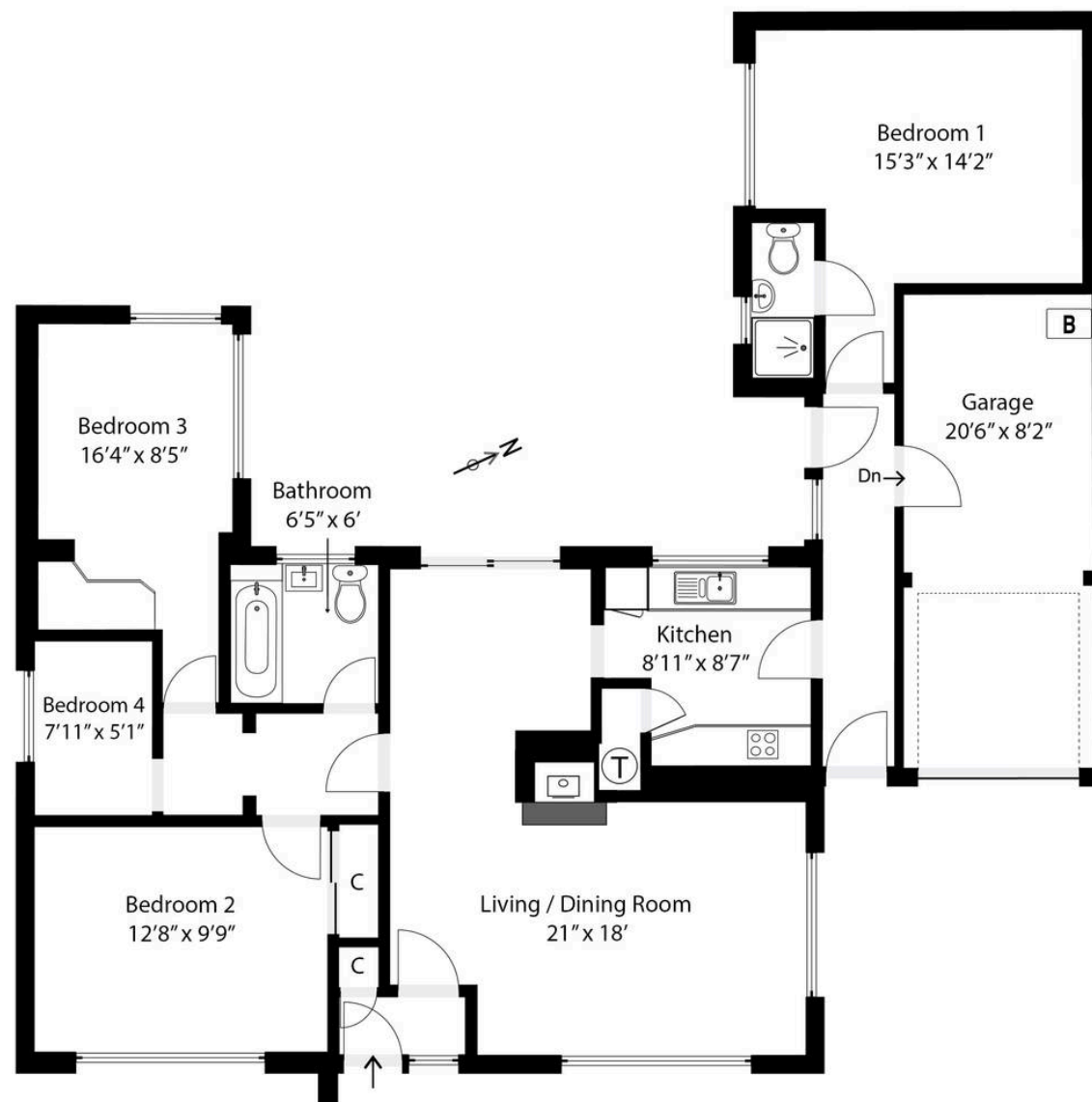

Illustration for Identification purposes only. Measurements are approximate. Dimensions given are between the widest points.
Not to scale. Outbuildings are not shown in actual location.

© Unauthorised reproduction prohibited - chriskemps@hotmail.com



8 Hog Green

Elham, Canterbury

Price range: £450,000 to £465,000. Situated in a quiet cul-de-sac in the picturesque village of Elham, this four-bedroom detached bungalow offers spacious and versatile living. The accommodation includes an entrance porch, a bright living/dining room, a well-fitted kitchen, four bedrooms, an en suite shower room, and a main bathroom. Outside, the property features a front garden, a driveway providing parking, a garage, and an enclosed rear garden offering privacy and outdoor space. Offered with no forward chain, this charming bungalow presents an excellent opportunity to enjoy village living in a sought-after location.

Council Tax band: E

Tenure: Freehold

EPC Energy Efficiency Rating: D

EPC Environmental Impact Rating: E



Laing Bennett

Laing Bennett Ltd, The Estate Office, 8 Station Road – CT18 8HP

01303 863393

info@laingbennett.co.uk

www.laingbennett.co.uk/

DISCLAIMER – These details are for guidance only and do not form part of an offer or contract. Measurements are approximate. Laing Bennett Ltd and the Vendor/Landlord accept no liability. Services and appliances are untested. Applicants must make their own checks. Items shown may not be included. No staff have authority to give warranties.