



29 Oakley Close, Holbury
£329,950

ANTHONY JAMES
PROPERTIES



29 Oakley Close

Holbury, Southampton

This spacious and versatile semi-detached home is located within a popular area and benefits from a two-storey rear extension as well as a garage conversion. The enhanced accommodation now provides up to five bedrooms, an ensuite, a bathroom, a generous lounge/dining room, a kitchen/breakfast room and a ground-floor fifth bedroom or family/play room. Outside of the property there is a full-width driveway to the front and a low-maintenance, enclosed rear garden. Further features include UPVC double glazing, skimmed ceilings and gas central heating. We strongly advise an internal viewing to fully appreciate the generous proportions on offer within this appealing property.

Council Tax band: C



Energy Efficiency Rating		
	Current	Potential
Very energy efficient - lower running costs		
(92+) A		85
(81-91) B		
(69-80) C	70	
(55-68) D		
(39-54) E		
(21-38) F		
(1-20) G		
Not energy efficient - higher running costs		
England, Scotland & Wales		EU Directive 2002/91/EC



1 Southward House
Dibden Purlicu SO45 4PT



T: 02380 844405
info@anthonyjamesproperties.co.uk



GROUND FLOOR

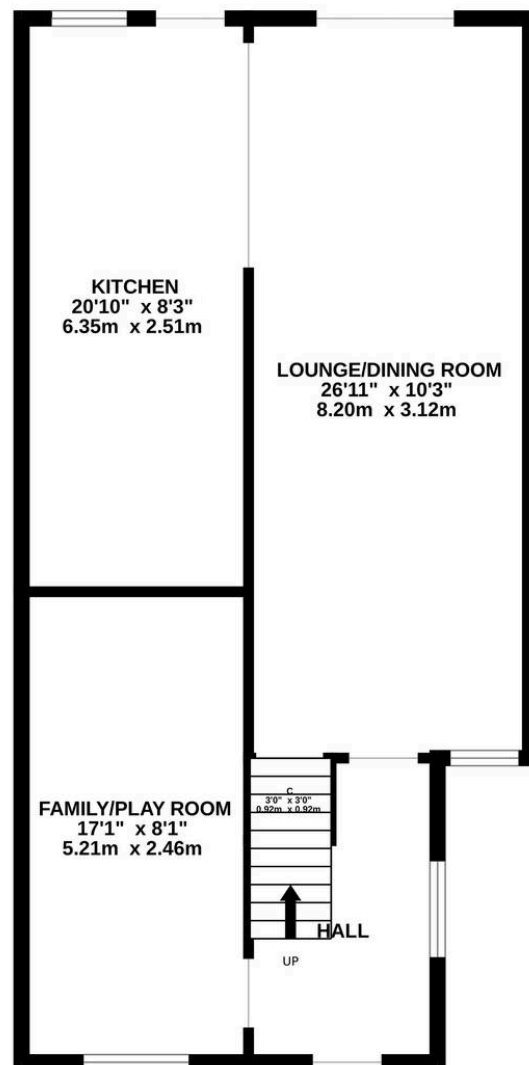

1ST FLOOR

