



5 Shrewsbury Avenue, Torquay – TQ2 8AE

Guide Price **£195,000**





5 Shrewsbury Avenue

Torquay, Torquay

Well presented 2-bed terrace house, featuring lounge/dining room with wood burning stove, modern kitchen, conservatory, and open outlook. Front garden with lawn, patio, and rear courtyard garden.

Council Tax band: B

Tenure: Freehold

- A well presented two bed terraced house
- Ideal first time buyer or investment property
- Communal parking
- Front and rear gardens
- Gas central heating and uPVC double glazing
- Lounge/dining room with feature wood burning stove
- Modern fitted kitchen and conservatory
- Two double bedrooms
- Modern fitted bathroom/WC



5 Shrewsbury Avenue

Torquay, Torquay

The property occupies a popular residential position within close proximity to local schools and shops and approximately 1.5 miles from Torquay sea front and town centre with its array of shops, facilities and amenities. There is also easy access to both Grammar schools, Torbay Hospital and the ring road which connects to Newton Abbot, Exeter and beyond. An internal inspection is highly recommended to appreciate the size and position the accommodation boasts.

Absolute Sales & Lettings

Absolute Sales & Lettings Ltd, 13 Ilsham Road - TQ1 2JG

01803 214214

torquay@movewithabsolute.co.uk

movewithabsolute.co.uk/



Ground Floor

Approx. 50.4 sq. metres (542.2 sq. feet)

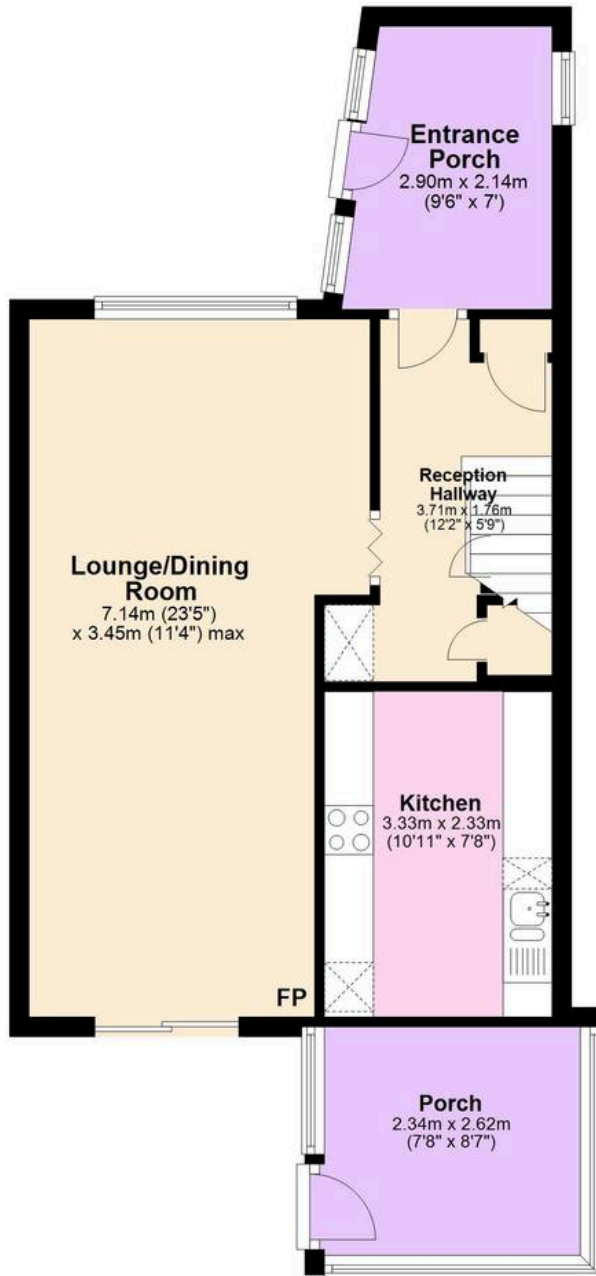

First Floor

Approx. 38.2 sq. metres (410.7 sq. feet)

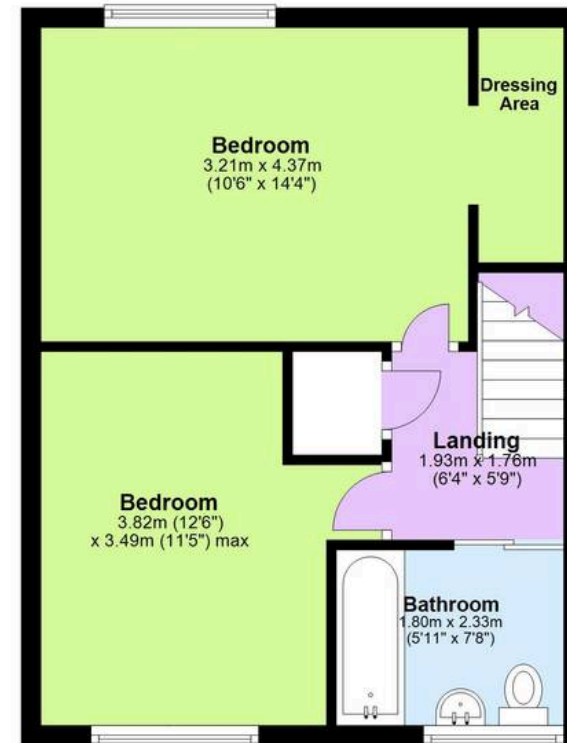

Total area: approx. 88.5 sq. metres (952.9 sq. feet)

Approx
Plan produced using PlanUp.

