

TO LET



Monmouth Close CHANDLERS FORD

4 Bedrooms, 1 Bathroom, House

£1,400 pcm



Monmouth Close CHANDLERS FORD

4 Bedrooms, 1 Bathroom

£1,400 pcm

Date available: 10th May 2025

Deposit: £1,615.38

Unfurnished

Council Tax band: C

- Available 10th May 2025
- Not suitable for Pets
- Kitchen/breakfast room
- Cloakroom
- Sitting room/dining room
- 4 Bedrooms - three double and one single
- Deposit £ 1,615.38

PORCH - door to

HALLWAY

CLOAKROOM low level wc wash basin

SITTING ROOM 15'9" x 14'1" staircase. Double glazed window to front elevation.

KITCHEN/DINING ROOM 12'4" x 10'4" range of wall and floor units, stainless steel sink with mixer tap, gas hob and electric oven, fridge/freezer, washing machine and dishwasher. Double glazed window overlooking rear garden. Door to rear garden.

LANDING slatted shelved airing cupboard with hot water tank. Hanging cupboard.

BEDROOM 1 12'1" x 8'0" full length range of mirror fronted built in wardrobes. double glazed window.

BEDROOM 2 11'9" x 8'3" double glazed window

BEDROOM 3 9'1" x 8'2" built in wardrobe. Double





glazed window.

BEDROOM 4 8'10" x 5'6" double glazed window.

BATHROOM Panel fronted bath - with shower, wc, wash basin

GARDENS TO THE FRONT is laid to lawn with shrub borders.

TO THE REAR lawn with panel fencing and side gate.

OFF ROAD PARKING

EASTLEIGH BOROUGH COUNCIL

GAS CENTRAL HEATING





Energy Efficiency Rating

	Current	Potential
Very energy efficient - lower running costs		
(92+) A		
(81-91) B		88
(69-80) C	70	
(55-68) D		



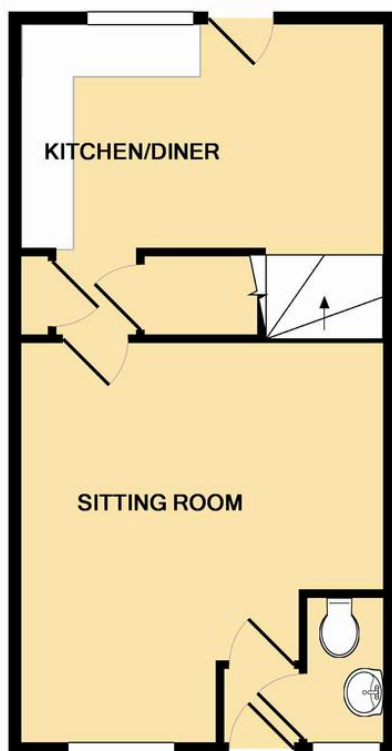

GROUND FLOOR
APPROX. FLOOR
AREA 36.5 SQ.M.
(393 SQ.FT.)



1ST FLOOR
APPROX. FLOOR
AREA 44.1 SQ.M.
(475 SQ.FT.)

TOTAL APPROX. FLOOR AREA 80.6 SQ.M. (868 SQ.FT.)

Whilst every attempt has been made to ensure the accuracy of the floor plan contained here, measurements of doors, windows, rooms and any other items are approximate and no responsibility is taken for any error, omission, or mis-statement. This plan is for illustrative purposes only and should be used as such by any prospective purchaser. The services, systems and appliances shown have not been tested and no guarantee as to their operability or efficiency can be given
Made with Metropix ©2012

Martin & Co Chandler

46 London Road • Southampton • SO15 2AH

T: 02380 390012 • E: chandlersford@martinco.com <http://www.martinco.com>

02380 390012



Accuracy: References to the Tenure of a Property are based on information supplied by the Seller. The Agent has not had sight of the title documents. A Buyer is advised to obtain verification from their Solicitor. Items shown in photographs including but not limited to carpets, fixtures and fittings are not included unless specifically mentioned within the sales particulars. They may however be available by separate negotiation. Buyers must check the availability of any property and make an appointment to view before embarking on any journey to see a property. No person in the employment of the agent has any authority to make any representation about the property, and accordingly any information given is entirely without responsibility on the part of the agents, sellers(s) or lessors(s). Any property particulars are not an offer or contract, nor for part of one. **Sonic / laser Tape:** Measurements taken using a sonic / laser tape measure may be subject to a small margin of error. **All Measurements:** All Measurements are Approximate. **Services Not tested:** The Agent has not tested any apparatus, equipment, fixtures and fittings or services and so cannot verify that they are in working order or fit for the purpose. A Buyer is advised to obtain verification from their Solicitor or Surveyor.