



Kingsford Street

Salford

HILLS

£180,000



# Kingsford Street

Salford

**\*\*Within Walking Distance of Weaste Tram Stop\*\***

Take a look at this two bedroom terraced property, boasting a convenient location the property is also within walking distance of Buile Hill Park  
Council Tax band: A

Tenure: Freehold

- Two Bedroom Terraced Property
- Lounge and a Separate Dining Room
- Fitted Kitchen and a Three-Piece Bathroom
- Two Well-Proportioned Bedrooms
- Low-Maintenance Courtyard Garden to the Rear
- Within Walking Distance of Weaste Tram Stop, which Provides Direct Access into Salford Quays, Media City and Manchester City Centre
- Just a Short Walk from Buile Hill Park
- Ideal First Time Home or Investment
- Viewing is Highly Recommended!



HILLS





### Entrance Hallway

### Lounge

11' 2" x 9' 10" (3.40m x 3.00m)

### Dining Room

13' 2" x 13' 1" (4.01m x 3.99m)

### Kitchen

10' 8" x 5' 10" (3.26m x 1.79m)

### Landing

### Bedroom One

13' 2" x 11' 3" (4.01m x 3.42m)

### Bedroom Two

13' 1" x 7' 0" (3.99m x 2.14m)

### Bathroom

7' 8" x 5' 9" (2.33m x 1.76m)



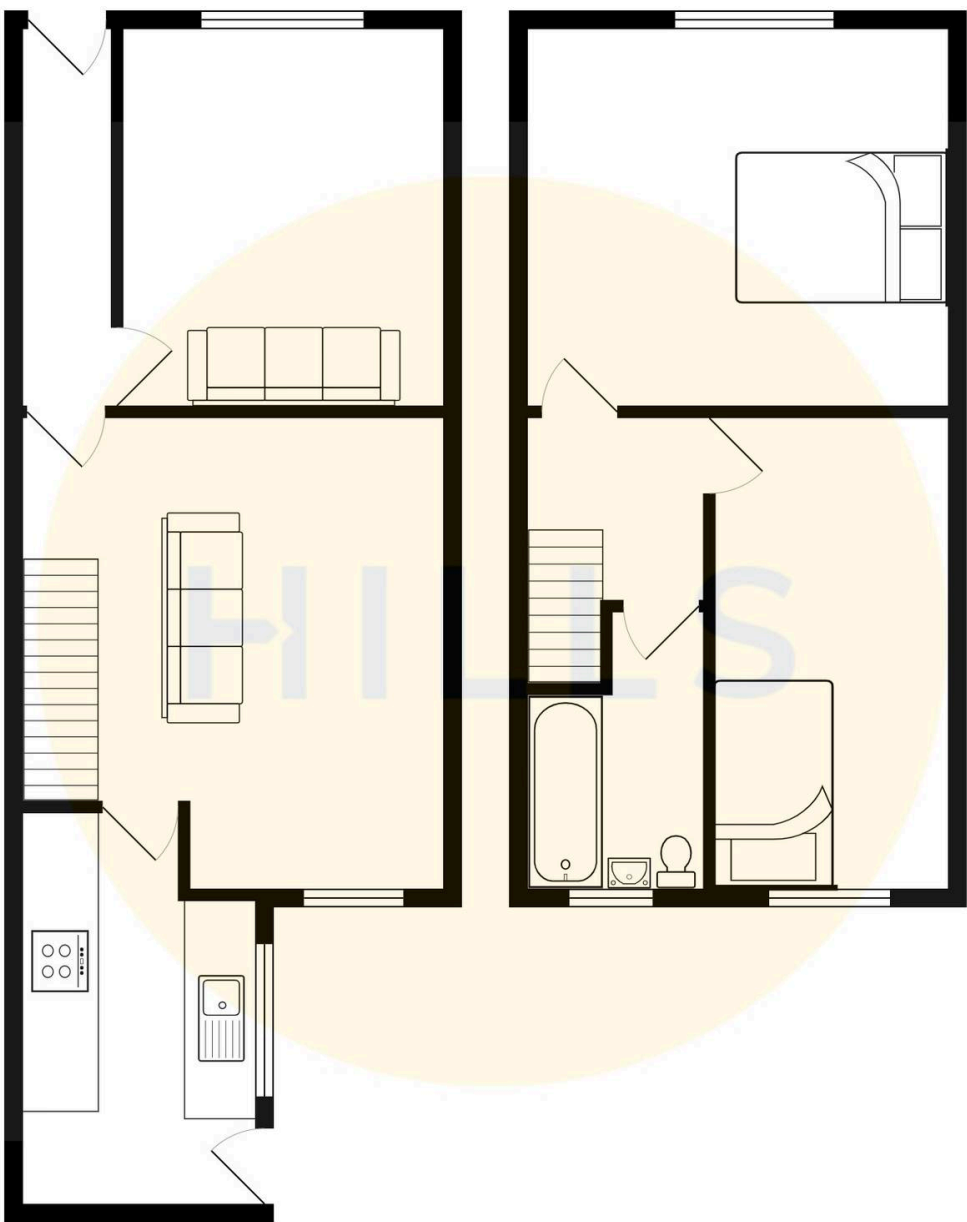





## Hills | Salfords Estate Agent

Hills Residential, Sentinel House Albert Street – M30 0SS

0161 707 4900

[sales@hills.agency](mailto:sales@hills.agency)

[www.hills.agency/](http://www.hills.agency/)



THE PROPERTY MISDESCRIPTIONS ACT 1991 The Agent has not tested any apparatus, equipment, fixtures and fittings or services and so cannot verify that they are in working order or fit for the purpose. A Buyer is advised to obtain verification from their Solicitor or Surveyor. References to the Tenure of a Property are based on information supplied by the Seller. The Agent has not had sight of the title documents. A Buyer is advised to obtain verification from their Solicitor. You are advised to check the availability of this property before travelling any distance to view. Every effort and precaution has been made to ensure these particulars are correct and not misleading but their accuracy is not guaranteed nor do they form part of any contract. If there is any point which is of particular importance to you, please contact us and we will provide any information you require. This is advisable, particularly if you intend to travel some distance to view the property. The mention of any appliances and services within these details does not imply that they are in full and efficient working order. These particulars are in draft form awaiting Vendors confirmation of their accuracy. These details must therefore be taken as a guide only.