



12 Churchill House, Park Heights, Old St. Johns Road, St. Helier

Guide Price £825,000

BROADLANDS

FINDING YOU A HOME SINCE 1972

12 Churchill House, Park Heights, Old St. Johns Road

St. Helier, Jersey

- No Housing Qualifications required
- 2nd Floor luxury apartment
- Balcony with far reaching views
- Lift access from garage
- 2 covered parking spaces
- Immediate vacant possession
- Share transfer
- Sole Agent
- Please contact Nigel on 07797 718233 or nigel@broadlandsjersey.com



12 Churchill House, Park Heights, Old St. Johns Road

St. Helier, Jersey

Unqualified property, available to any persons who do not hold the usually required residential status to live in Jersey.

A second floor purpose built apartment in a well maintained block on the outskirts of St Helier. The accommodation is bright and spacious with wood floors throughout and neutral decor. Currently tenanted until May 2025 when the new owner can take vacant possession.

The block sits in an elevated location on a quiet “access only” quiet road with very little passing traffic and benefits from panoramic views across the capital to the sea beyond.

There is lift access meaning that you can park in the underground secure car parking spaces and take the lift to your front door. The proximity to St Helier centre means that you can easily wander down to all the shops and restaurants without needing the car.

Ready to go, book your appointment to view with Broadlands.





Living

Spacious lounge with separate dining area and access to balcony. Separate kitchen with all integrated appliances including washing machine.

Sleeping

2 double bedrooms with the main being en suite, plus house bathroom.

Services

All mains (no gas) electric heating and full double glazing

Service charge

Approx £275 per month to include buildings insurance, lift maintenance, caretaker, communal lighting, cleaning, rates and sinking fund .





12 CHURCHILL
795 sq.ft. (73.9 sq.m.) approx.

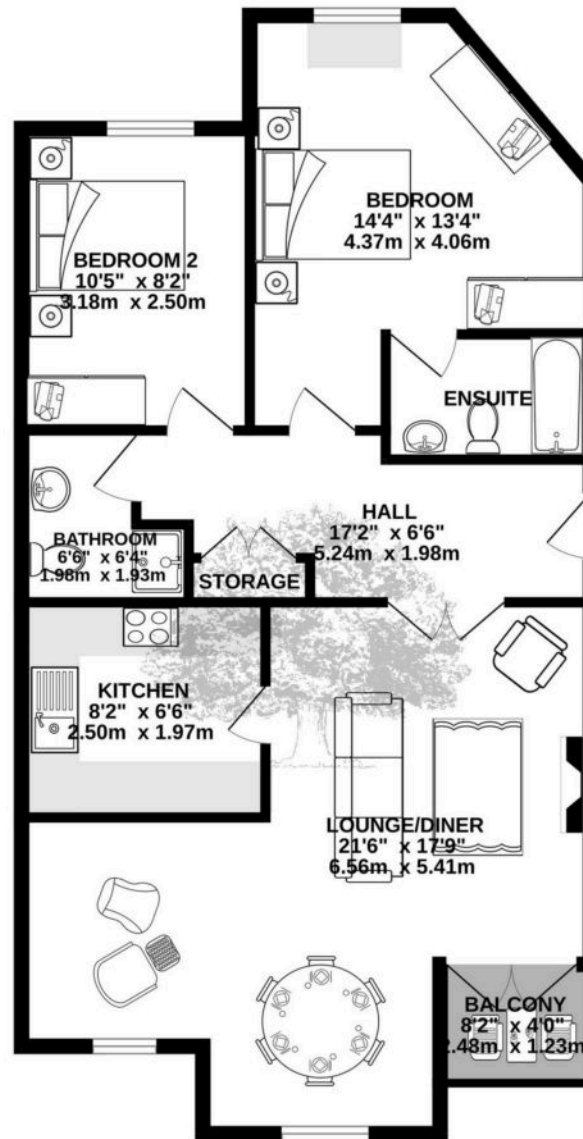

TOTAL FLOOR AREA : 795 sq.ft. (73.9 sq.m.) approx.

Whilst every attempt has been made to ensure the accuracy of the floorplan contained here, measurements of doors, windows, rooms and any other items are approximate and no responsibility is taken for any error, omission or mis-statement. This plan is for illustrative purposes only and should be used as such by any prospective purchaser. The services, systems and appliances shown have not been tested and no guarantee as to their operability or efficiency can be given.
Made with Metropix ©2025



Broadlands

Broadlands Estates, Library Place - JE2 3NL

01534 880770 • enquiries@broadlandsjersey.com • www.broadlandsjersey.com/

BROADLANDS

FINDING YOU A HOME SINCE 1972