

Ambleside Close Wellingborough

richard james

www.richardjames.net

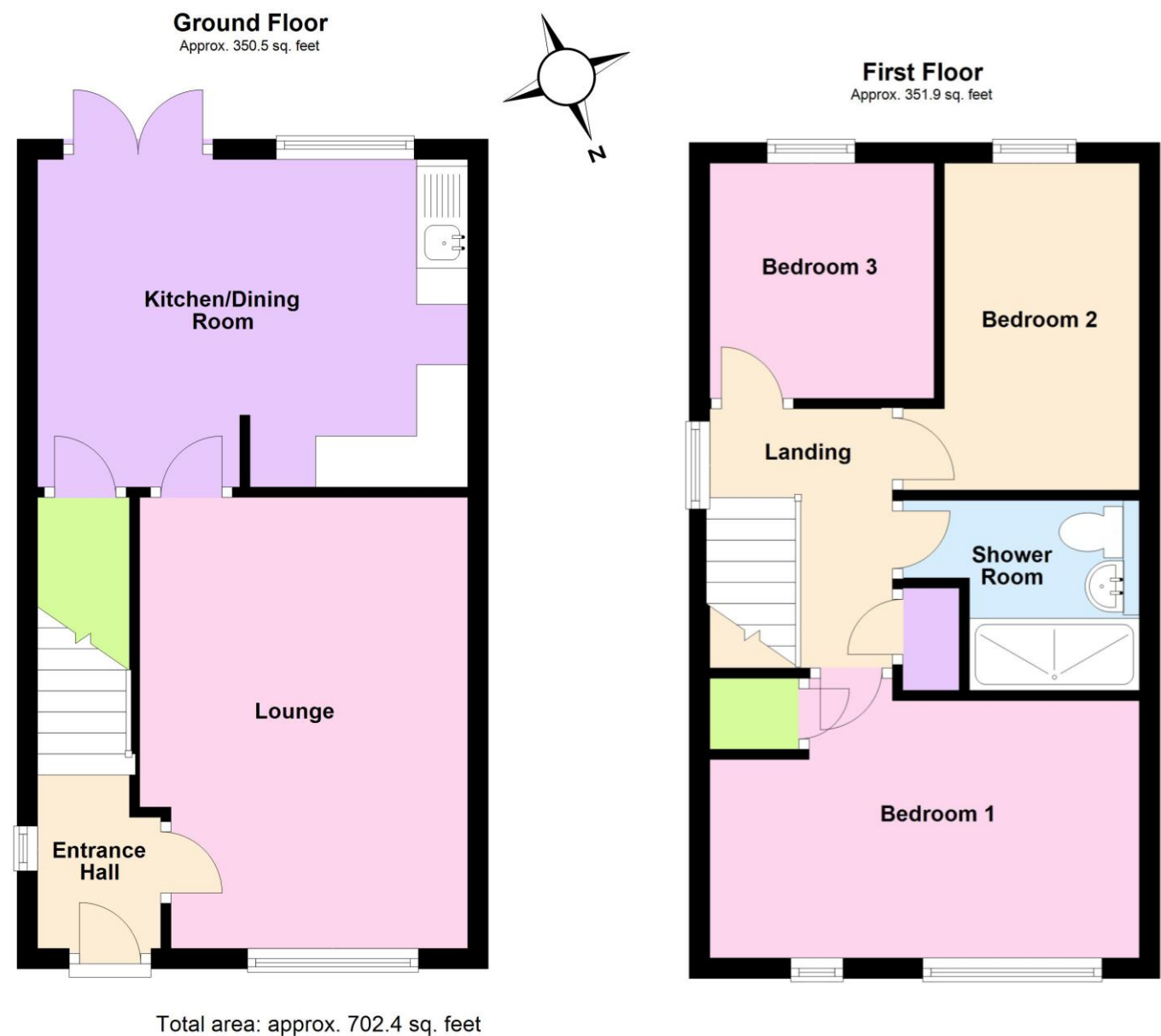

Ambleside Close Wellingborough NN8 3ZH Freehold Price £230,000

Wellingborough Office ☐
27 Sheep Street Wellingborough
Northants NN8 1BS
01933 224400

Irthlingborough Office ☐
28 High Street Irthlingborough
Northants NN9 5TN
01933 651010

Rushden Office ☐
74 High Street Rushden
Northants NN10 0PQ
01933 480480



The information given in these particulars is intended to help you decide whether you wish to view this property and to avoid wasting your time in viewing unsuitable properties. We have tried to make sure that these particulars are accurate, but to a large extent we have to rely on what the seller tells us about the property. We do not check every single piece of information ourselves as the cost of doing so would be prohibitive and we do not wish to unnecessarily add to the cost of moving house. Once you find the property you want to buy, you will need to carry out more investigations into the property than it is practical or reasonable for an estate agent to do when preparing sales particulars. For example, we have not carried out any kind of survey of the property to look for structural defects and would advise any homebuyer to obtain a surveyor's report before exchanging contracts. If you do not have your own surveyor, we would be pleased to recommend one. We have not checked whether any equipment in the property (such as central heating) is in working order and would advise homebuyers to check this. You should also instruct a solicitor to investigate all legal matters relating to the property (e.g. title, planning permission etc) as these are specialist matters in which estate agents are not qualified. Your solicitor will also agree with the seller what items (e.g. carpets, curtains etc) will be included in the sale.

A three bedroom semi detached house situated in a cul de sac that benefits from uPVC double glazed doors and windows, gas radiator central heating, a refitted kitchen and a refitted shower room. The property has had majority replacement internal doors, re-decoration and replacement flooring in recent years. The accommodation briefly comprises entrance hall, lounge, kitchen/dining room, three bedrooms, shower room, gardens to front and rear and off road parking.

Enter via entrance door with obscure glazed insert to.

Entrance Hall

Obscure glazed window to side aspect, radiator, wooden effect laminate floor, stairs to first floor landing, glazed door to.

Lounge

14' 8" x 9' 6" (4.47m x 2.9m)

Window to front aspect, radiator, wooden fire surround with log effect electric fire fitted, T.V. point, wood effect laminate floor, dado rail, glazed door to.

Kitchen/Dining Room

13' 9" x 10' 7" (4.19m x 3.23m) (This measurement includes the area occupied by the kitchen units)

Refitted to comprise single drainer stainless steel sink unit with cupboards under, range of base and eye level units providing work surfaces, tiled splash areas, freestanding gas cooker with extractor hood over, plumbing for washing machine, space for fridge/freezer, radiator, understairs storage cupboard, wood effect floor, window to rear aspect, French doors to rear garden.

First Floor Landing

Window to side aspect, access to loft space, coving to ceiling, airing cupboard housing gas fired combination boiler serving central heating and domestic hot water, doors to.

Bedroom One

13' 9" x 8' 1" narrowing to 6' 6" (4.19m x 2.46m)

Window to front aspect, further obscure glazed window to front aspect, radiator, overstairs storage cupboard.

Bedroom Two

10' 6" x 6' 3" plus door recess (3.2m x 1.91m)

Window to rear aspect, radiator.

Bedroom Three

7' 6" x 7' 2" (2.29m x 2.18m)

Window to rear aspect, radiator.

Shower Room

Refitted white suite comprising double width walk in shower, low flush W.C., wash basin with vanity cupboards under, splash areas, chrome effect towel radiator, electric extractor vent, wood effect floor.

Outside

Rear garden - Patio, lawn, ornamental stone/shingle area, conifer, wooden deck with fitted gazebo, two wooden sheds, one currently used as a workshop with power and light connected, outside light and tap, wooden fence, gated access to front.

Front - Open canopy porch, gravel and driveway providing parking overall for three cars.

Energy Performance Rating

This property has an energy rating of C. The full Energy Performance Certificate is available upon request.

Council Tax

We understand the council tax is band B (£1,749 per annum. Charges for 2025/2026).

Agents Note

Please be aware that some photographs used in our particulars are obtained using a wide-angle lens.

Conveyancing

We are able to offer a free quotation for your conveyancing from a panel of local solicitors or licensed conveyancers.

Offers

For offers to be submitted in the best light, the majority of vendors require us to confirm buyers have been financially qualified. We will require a Mortgage Certificate or Agreement In Principle (A.I.P.) and proof of deposit or cash. This information will be treated confidentially and will not be seen by any other party. We are obliged by law to pass on all offers to the vendors until contracts have been exchanged.

Money Laundering Regulations 2017 & Proceeds of Crime Act 2002

In order to comply with the above Regulations, an intending purchaser will be required to provide official I.D; proof of address, evidence of funding and source of deposit clearly showing the name of the account holder. If funds are being provided by a third party i.e. family, we will require the same from them too. We will verify clients identity electronically from the details provided. The information will be checked against various databases. This is not a credit check of any kind and does not affect credit history. We will retain a record on file.

General Data Protection Regulations 2018

Should you view or offer on this property, we will require certain pieces of personal information in order to provide a professional service to you and our client.

The personal information provided by you may be shared with the seller, but it will not be shared with any other third parties without your consent.

More information on how we hold and process your data is available on our website - www.richardjames.net

Mortgages

We are able to offer our clients mortgage advice through our association with an independent mortgage advisor. Written quotations are available on request. A life policy may be required.

YOUR HOME MAY BE REPOSSESSED IF YOU DO NOT KEEP UP REPAYMENTS ON YOUR MORTGAGE.

