

FOR SALE

2 Bed Mid Terraced House in Harrow Road, Leicester LE3 0JZ
£190,000

Substantial two bedroom town house for sale on the popular Harrow Road in Leicester's West End. Sold with no upward chain, the property is packed with the original features and quirks a discerning buyer will be looking for from this kind of property. Comprising entrance hall with Minton tiled floor, two reception rooms and spacious kitchen downstairs, together with two large double bedrooms and generous bathroom upstairs. The property also benefits from a low maintenance yard and outhouse to the rear and convenient access to local amenities.



GROUND FLOOR
524 sq.ft. (48.7 sq.m.) approx.

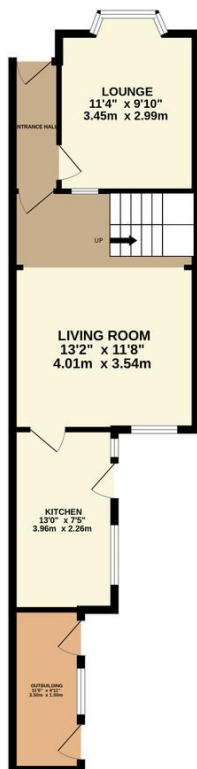

1ST FLOOR
519 sq.ft. (48.2 sq.m.) approx.

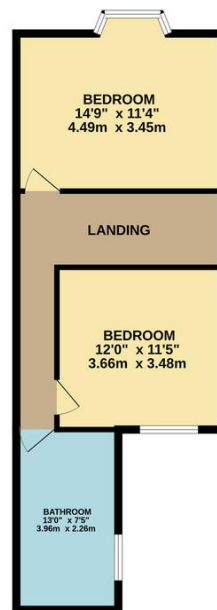

Energy Efficiency Rating		
	Current	Potential
Very energy efficient - lower running costs		
(92+) A		
(81-91) B		83
(69-80) C		
(55-68) D	60	
(39-54) E		
(21-38) F		
(1-20) G		
Not energy efficient - higher running costs		
England & Wales		EU Directive 2002/91/EC
WWW.EPC4U.COM		

- Sold With No Upward Chain
- Substantial Size For Type
- Terraced Home
- Entrance Hall
- Two Reception Rooms
- Two Double Bedrooms
- Large Bathroom & Kitchen
- Packed with Original Features

Agents Note: Whilst every care has been taken to prepare these sales particulars, they are for guidance purposes only. All measurements are approximate and are for general guidance purposes only and whilst every care has been taken to ensure their accuracy, they should not be relied upon and potential buyers are advised to recheck the measurements.

