



Ground Floor Apartment

CHECK OUT this Ground Floor Apartment! Victorian Grade II Listed Building. 2 Bedrooms, Spacious Open Plan Live/Eat, with Living Dining Room, Kitchen area, Bathroom, South Facing Garden & On Street Parking. Traditional Victorian Features such as Cornice & Sash Windows. Long Lease NO CHAIN

6 Barnpark Terrace | Teignmouth | TQ14 8PS





PROPERTY TYPE

Ground Floor Apartment



SIZE

506 sq ft



LOCATION

Town Centre



AGE

Victorian (1837 - 1901)



BEDROOMS

2



RECEPTION ROOMS

1



BATHROOMS

1



WARMTH

Gas Central Heating



PARKING

On Road Parking



OUTSIDE SPACE

Garden



EPC RATING

72 C



COUNCIL TAX BAND

A



in a nutshell...

- Grade II Listed Building
- 2 Bedrooms
- Lounge / Dining room
- Open Plan Kitchen
- Rear South Facing Garden + Shared Access
- CHAIN FREE!
- On Street Parking
- Ideal First Time Buy
- Convenient location





the details...

CHECK OUT this Ground Floor Apartment with South Facing Garden!

Centrally located in the Seaside Town of Teignmouth, with all local Amenities, Shops, Pubs, Bars & Restaurants. Local Bus Service & Train Station to Exeter & London.

A well-presented space, with large Open Plan Live/Eat. Modern Kitchen Area with ample work surfaces, storage cupboards, space for washing machine, fridge freezer & gas/electric cooker point. Wood effect flooring throughout this area, HIGH Ceilings, Ornate Victorian style ceiling Cornice, traditional style Victorian skirting boards & French Doors open out to the rear South facing Gardens, so lots of light!

There are 2 Bedrooms, with floor to ceiling timber sash window, the other also with sash window & a modern Bathroom.

Would benefit from some redecorating & personalisation.

A great space central to the Town with NO ONWARD CHAIN.

On street Parking & local Permit Parking available.

AGENTS NOTE: Some restrictive covenants may apply. Shared access via the rear Gardens

English Heritage Listing

TEIGNMOUTH BARNPARK TERRACE (south side) 2-12, 12A, 14, 15 and 16

(Formerly listed as BARN PARK TERRACE (South side), Nos.1-12, 12A AND 15 (Consecutive), previously listed as: BARN PARK TERRACE Nos.2-12A (Consecutive) and Barnpark Hotel)

21/06/77 II Terrace of twelve houses and hotel, now flats, some considerably altered. c1850s. Painted stucco, slate roofs with rendered stacks to party walls (mostly truncated). Double-depth plans.

EXTERIOR: three storeys with attics and basements; each house is two window range, the terrace being stepped downhill. Wide bracketed eaves with pendants to the brackets flanking the three/three-pane attic windows have a moulded cornice at sill level. Moulded architraves and six/six-pane sash windows to the lower floors. Each house has a two-storey projecting porch to the left with a semicircular-arched stair window above. The porches have segmental-arched doorways with voussoirs dying into banded rustication, half-glazed double doors with three panes to each leaf below paired three-pane semicircular-arched windows with an impost band (to a mezzanine stair landing) and a modillion cornice below a panelled parapet. Some houses have an added storey to the porch, some retain original area railings between the porches, and some porches have lost original stucco detail. The rears have similar windows to the fronts with a cornice over the second floor and sill bands below. No.6 has French windows and a cast-iron balcony to the ground floor.

Leasehold

Ground Rent & Service Charge TBC

the floorplan...



Barnpark Terrace, Teignmouth, TQ14

Approximate Area = 506 sq ft / 47 sq m

For identification only - Not to scale

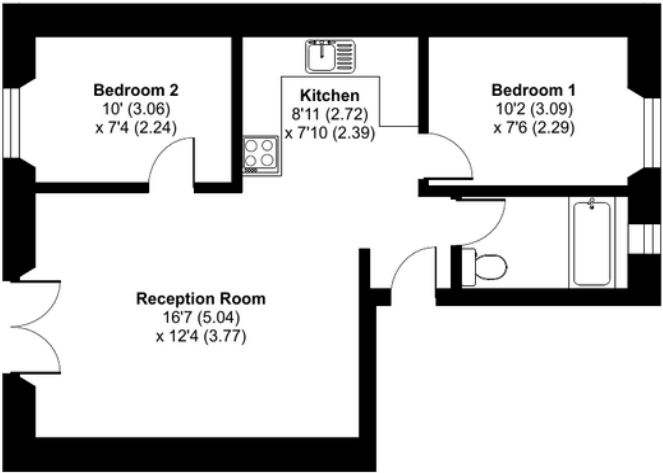

Floor plan produced in accordance with RICS Property Measurement 2nd Edition, Incorporating International Property Measurement Standards (IPMS2 Residential). © nchecom 2025. Produced for Ashtons Complete (Complete Property). REF: 1269552



Our note. For clarification we have prepared these sales particulars as a general guide and have not carried out a detailed survey nor tested the services, appliances or fittings. Room sizes should not be relied upon for carpets or furnishings. If there are any important matters which are likely to affect your decision to buy, please contact us before viewing this property. These particulars, whilst believed to be accurate, are set out as a general outline only for guidance and do not constitute any part of an offer or contract. Intending purchasers should not rely on them as statements of representation of fact, but must satisfy themselves by inspection or otherwise as to their accuracy. No person in the employment of Complete Property Services has the authority to make or give any representation or warranty in respect of the property.

SKETCH PLAN FOR ILLUSTRATIVE PURPOSES ONLY. All measurements and sizes and locations of walls, doors, window fittings and appliances are shown conventionally and are approximate only and cannot be regarded as being a representation either by the Seller or his Agent. We hope that these plans will assist you by providing you with a general impression of the layout of the accommodation. The plans are not to scale nor accurate in detail. © Unauthorised reproduction prohibited.

As part of the service we offer we may recommend ancillary services to you which we believe will help with your property transaction. We wish to make you aware that should you decide to proceed we will receive a referral fee. This could be a fee, commission, payment or other reward. We will not refer your details unless you have provided consent for us to do so. You are not under any obligation to provide us with your consent or to use any of these services, but where you do you should be aware of the following referral fee information. You are also free to choose an alternative provider. To find out more about this, please speak to a member of the team.

the location...

Please check Google maps for exact distances and travel times.

Property postcode: TQ14 8PS





Need a more complete
picture? Get in touch with
your local branch...

Tel 01626 870 870
Email teignmouth@completeproperty.co.uk
Web completeproperty.co.uk

Complete
13 Wellington Street
Teignmouth
Devon
TQ14 8HW

Are you selling a property too? Call us to get a set of property details like these...

selling

letting

land &
new homes

signature
homes

complete.