



1 Godolphin Road, Seer Green

Guide Price £995,000

Ashington Page

One Godolphin Road is a substantial family home situated within the highly sought-after Chiltern village of Seer Green, conveniently located within walking distance to Seer Green station with direct access to London Marylebone, village shops, pubs and local school. This impressive detached five-bedroomed property benefits from a double-storey extension, making it one of the more generously proportioned homes on the road. The property is well presented and enjoys a corner plot position that benefits from excellent natural light.

Freehold

EPC C

Council Tax Band G

These particulars are for guidance only. They are prepared and issued in good faith and are intended to give a fair summary of the property. Any description should not be relied on as a statement or representation of fact or that the property, or its services, are in good condition. The photographs show only certain parts of the property at the time they were taken. Any areas, measurements or distance given are approximate only. Any reference to alterations to, or use of, any part of the property is not a statement that any necessary planning, building regulations or other consent has been obtained. These matters must be verified by an intending purchaser. All statements contained in these particulars in relation to the property are made without responsibility of Ashington Page or its clients. Neither Ashington Page (nor any joint agents) nor any of their employees has any authority to make or give any representation or warranty whatsoever in relation to the property

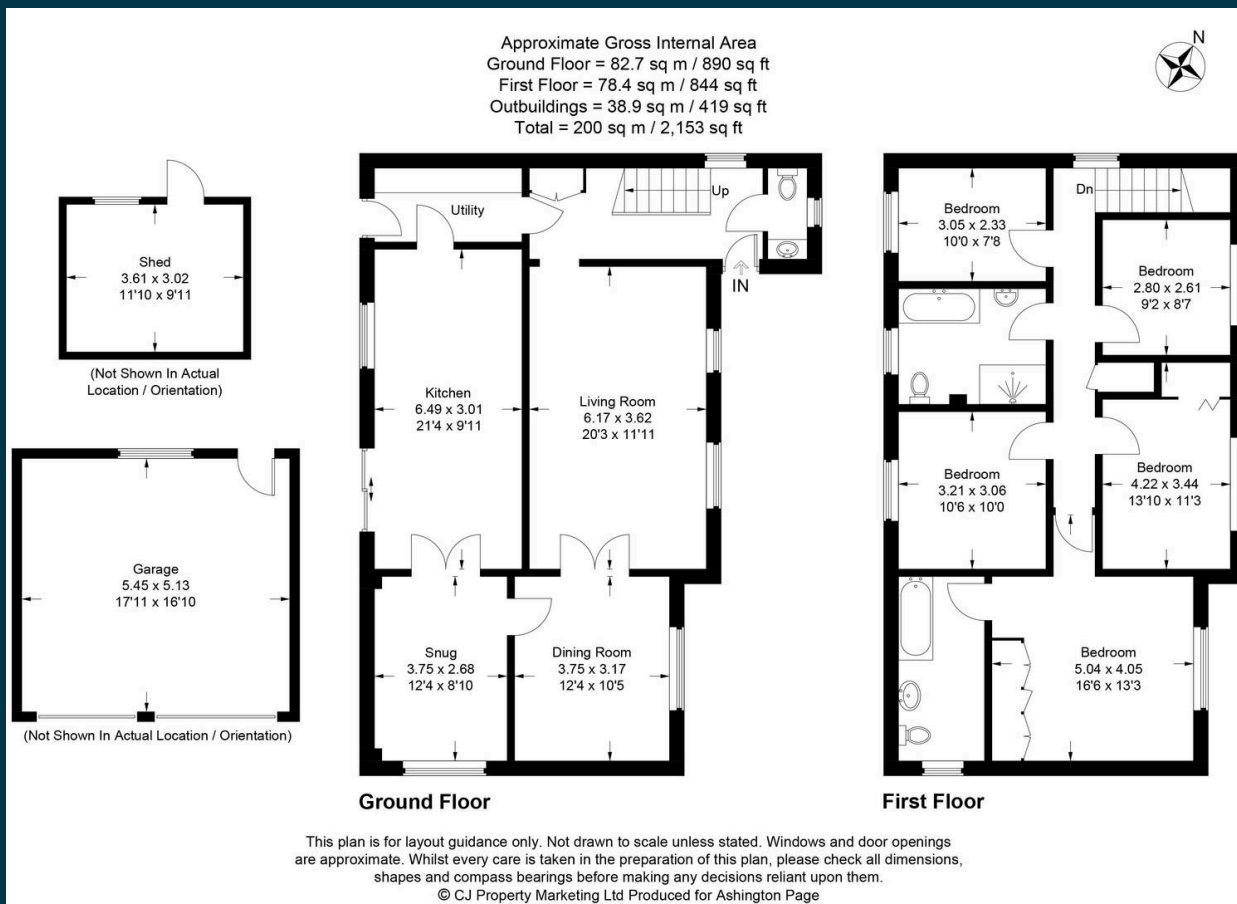

01494 680018
info@ashingtonpage.co.uk
www.AshingtonPage.co.uk