



20 Catmint Close, Woodhall Park, Swindon, SN2 2TB

Guide Price £220,000-£230,000

richard james



Catmint Close

Woodhall Park

Freehold | EPC Rating - C



Richard James are delighted to welcome to the market this extremely well presented two bedroom home situated in a quiet cul-de-sac in the ever popular Woodhall Park.

Upon entry you are greeted by the porch leading through to a spacious and bright living room and modern kitchen with integrated oven, electric hob and breakfast bar. To the rear is a low maintenance garden with a stylish decking area and convenient rear gate access.

The first floor provides a rear facing master bedroom with neutral decor and fitted wardrobes complete with mirrors.

A decent sized second bedroom with plenty of room for both a bed and further furnishings. The family bathroom also located on this floor is bright and modern, complete with shower over bath.

The property is in a prime location, close to both North and West Swindon shopping parks. It is also ideally located near Moulton Hill Country Park; great for dog walks, strolls or fishing.

For families looking for activities such as bowling, laser quest and trampoline parks they're all within a 15 minute radius.



Catmint Close also benefits from close by schools and nurseries/ preschools with great Ofsted reports.











Floorplan

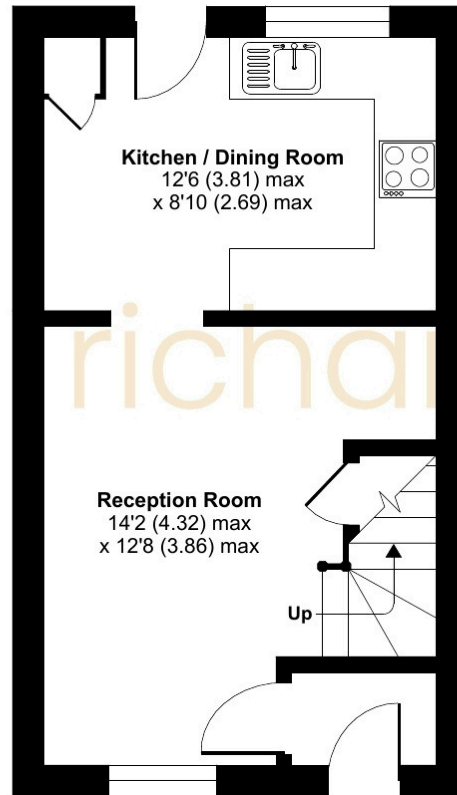

GROUND FLOOR

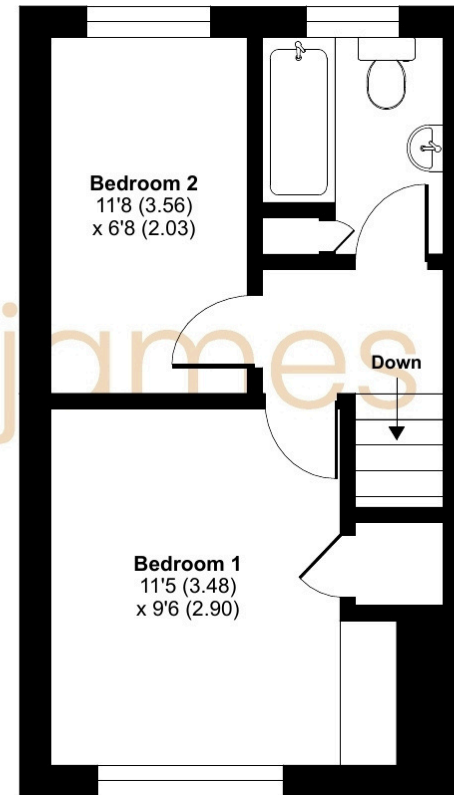

FIRST FLOOR

01793 311 049

jordancobb@richardjames.uk

101 Victoria Road | Swindon | SN1 3BD

richard james

richardjames.uk