



TURNER ROAD
CANTON
CARDIFF CF5 1HS

ASKING PRICE OF
£395,000



MID TERRACED HOUSE



3



1



2



1

INCREDIBLY PRESENTED, THREE BEDROOM, MID TERRACED HOUSE NEAR VICTORIA PARK MGY are delighted to bring to market this beautifully presented, three double bedroom, mid-terraced house which has been recently refurbished throughout to a very high specification. The accommodation briefly comprises entrance hallway, lounge/diner, kitchen/breakfast room, downstairs WC, three double bedrooms and family bathroom. The property further benefits from being rewired throughout, has a new central heating system, and all windows front and back are double glazed. ***Viewing highly recommended***

ENTRANCE HALL

Entered via front door leading from street. Herringbone style LVT flooring. Vertical radiator. Pendant light fitting. Doors to lounge/diner, kitchen/breakfast room, downstairs WC and under stairs storage. Stairs rising to first floor.

LOUNGE/DINER

24' 2" x 9' 2" (7.39m x 2.80m)

Continuation of Herringbone style LVT flooring. Pendant light fittings. Double glazed uPVC window to front aspect with fitted shutter blinds. Feature fireplace. Alcoves. Fitted storage cupboards and shelving. Coving. Black crittal door leading to rear garden. Power points. Radiators.

KITCHEN/BREAKFAST ROOM

18' 9" x 9' 3" (5.72m x 2.84m)

Continuation of Herringbone style LVT. Modern fitted Shaker style 'Wren' kitchen with a range of wall, base and drawer units with 'Valenza' worktops over incorporating inset sink with instant hot water tap over and four ring induction hob the extractor above. Integrated appliances such as dishwasher, fridge/freezer, oven and microwave. Space and plumbing for washing machine. Splashback. Spotlights and pendant light fitting. Vertical radiator. Power points. Triple glazed black crittal doors leading to rear garden. Double glazed window to side aspect.

WC

3' 11" x 2' 4" (1.20m x 0.72m)

Tiled flooring and partially tiled walls. Wall mounted wash hand basin with mixer tap over. WC. Pendant light fitting. Extractor.

TENURE: FREEHOLD

COUNCIL TAX BAND: D

FLOOR AREA APPROX: 1,055 SQ FT

VIEWING: STRICTLY BY APPOINTMENT

FIRST FLOOR

Carpet runner upstairs. Split level landing. Pendant light fitting. Power points. Loft hatch. Doors to all bedrooms and family bathroom.

BEDROOM ONE

15' 1" x 9' 10" (4.60m x 3.00m)

Carpet to floor. Two large double glazed uPVC windows to front with fitted shutter blinds. Pendant light fitting with additional wall lighting. Vertical radiator. Alcoves. Power points.

BEDROOM TWO

9' 2" x 11' 1" (2.81m x 3.38m)

Carpet to floor. Double glazed uPVC window to rear aspect. Pendant light fitting. Feature fireplace. Alcoves. Power points. Vertical radiator.

BATHROOM

Tiled flooring and partially tiled walls. Heated towel rail. Bath with hot and cold tap over and mains powered shower above with additional handheld shower attachment. WC. Vanity wash hand basin with mixer tap over and storage beneath and tiled splashback. Obscure double glazed uPVC window to rear aspect. Spotlights. Extractor.

BEDROOM THREE

9' 5" x 9' 0" (2.89m x 2.75m)

Carpet to floor. Double glazed uPVC window to rear aspect. Pendant light fitting. Power points. Vertical radiator.

OUTSIDE

Rear - Laid to shingled area. Fence and wall border. Lawn area. Gate for rear access. Outside tap. Electrical sockets.

TENURE

MGY have been advised that the property is FREEHOLD.



TURNER ROAD, CANTON, CARDIFF CF5 1HS



TURNER ROAD, CANTON, CARDIFF CF5 1HS

GROUND FLOOR

1ST FLOOR

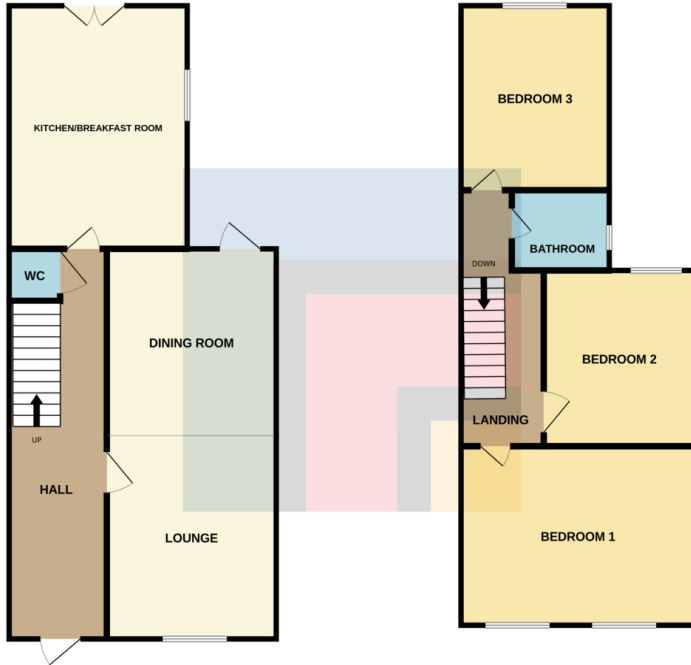

Whilst every attempt has been made to ensure the accuracy of the floorplan contained here, measurements of doors, windows, rooms and any other items are approximate and no responsibility is taken for any error, omission or mis-statement. This plan is for illustrative purposes only and should be used as such by any prospective purchaser. The services, systems and appliances shown have not been tested and no guarantee as to their operability or efficiency can be given.
Made with Homestyler C2023

Score	Energy rating	Current	Potential
92+	A		
81-91	B		88 B
69-80	C	70 C	
55-68	D		
39-54	E		
21-38	F		
1-20	G		

PONTCANNA 02920 397152

95 Pontcanna Street, Pontcanna, Cardiff, South
Glamorgan, CF11 9HS



Important Notice: These particulars are prepared for guidance only and do not form whole or any part of any offer or contract. Whilst the particulars are given in good faith, they are not to be relied upon as being a statement or representation of fact. They are made without responsibility on the part of MGY Ltd or Vendor/lessor and the prospective purchaser/lessee should satisfy themselves by inspection or other wise as to their accuracy. Neither MGY Ltd nor anyone in their employ, or the vendor/lessor, imply, make or give any representation/warranty whatsoever in relation to this property.

MGY.CO.UK