

Woodroffe Way

East Leake, Loughborough, LE12 6AL

John German



John German



Woodroffe Way

East Leake, Loughborough, LE12 6AL

£475,000

An absolutely stunning home occupying a fantastic position in a highly popular residential development, close to amenities and beautifully presented throughout, with large private rear garden, double garage and driveway for up to six vehicles.

This home would make a perfect purchase for growing or established families, executive couples or retired professionals.

The property is located within one mile of the village centre where a wide variety of shops and amenities can be found including doctor's surgery, dental practice, chemist, opticians and library. There is also a Co-op supermarket, bakery, greengrocers, as well as several coffee shops, pubs and eateries.

Nearby conurbations of Loughborough (4m), Nottingham (8m), Derby (13m) and Leicester (13m) are easily accessible by car and regular bus service. Main line rail services are available from East Midlands Parkway (4m) and Loughborough (4m). East Midlands Airport is approximately 20 minutes away by car and commuter access to the M1 and A46 is excellent.

Accommodation comprises; four double bedrooms, two en-suites, family bathroom, ground floor W.C., utility room, kitchen/diner, formal dining room, lounge and home office/playroom.

Externally, the property is situated on a quiet cul-de-sac and a good size plot, with a low maintenance private rear garden, patio seating area, double garage and ample driveway.

To view this beautifully presented property, please contact John German East Leake office.

Tenure: Freehold (purchasers are advised to satisfy themselves as to the tenure via their legal representative).

Please note: It is quite common for some properties to have a Ring doorbell and internal recording devices.

Property construction: Standard

Parking: Driveway & double garage

Electricity supply: Mains

Water supply: Mains

Sewerage: Mains

Heating: Mains gas

(Purchasers are advised to satisfy themselves as to their suitability).

Broadband type: Fibre

See Ofcom link for speed: <https://checker.ofcom.org.uk/>

Mobile signal/coverage: See Ofcom link <https://checker.ofcom.org.uk/>

Local Authority/Tax Band: Rushcliffe Borough Council / Tax Band F

Useful Websites: www.gov.uk/government/organisations/environment-agency

Our Ref: JGA07052025

The property information provided by John German Estate Agents Ltd is based on enquiries made of the vendor and from information available in the public domain. If there is any point on which you require further clarification, please contact the office and we will be pleased to check the information for you, particularly if contemplating travelling some distance to view the property. Please note if your enquiry is of a legal or structural nature, we advise you to seek advice from a qualified professional in their relevant field.

We are required by law to comply fully with The Money Laundering Regulations 2017 and as such need to complete AML ID verification and proof / source of funds checks on all buyers and, where relevant, cash donors once an offer is accepted on a property. We use the Checkboard app to complete the necessary checks, this is not a credit check and therefore will have no effect on your credit history. With effect from 1st March 2025 a non-refundable compliance fee of £30.00 inc. VAT per buyer / donor will be required to be paid in advance when an offer is agreed and prior to a sales memorandum being issued.







Ground Floor Building 1

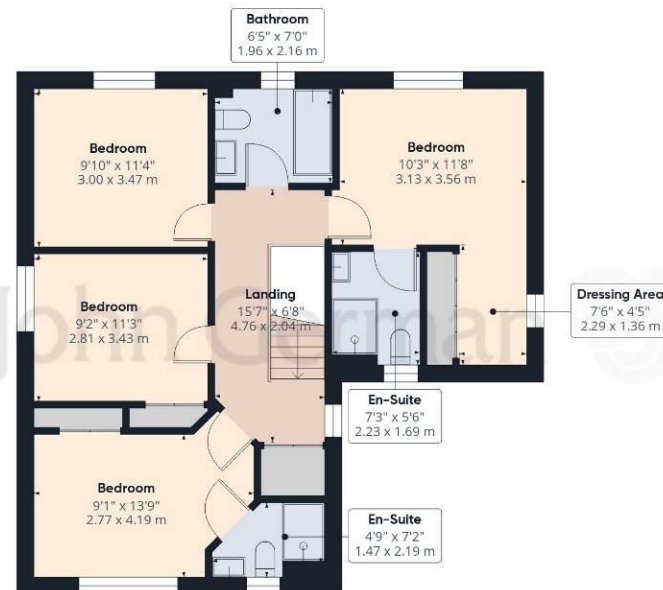

Floor 1 Building 1



Ground Floor Building 2

Approximate total area⁽¹⁾

1763 ft²

163.8 m²

(1) Excluding balconies and terraces

While every attempt has been made to ensure accuracy, all measurements are approximate, not to scale. This floor plan is for illustrative purposes only.

Calculations were based on RICS IPMS 3C standard. Please note that calculations were adjusted by a third party and therefore may not comply with RICS IPMS 3C.

GIRAFFE360



Agents' Notes

These particulars do not constitute an offer or a contract neither do they form part of an offer or contract. The vendor does not make or give and Messrs. John German nor any person employed has any authority to make or give any representation or warranty, written or oral, in relation to this property. Whilst we endeavour to make our sales details accurate and reliable, if there is any point which is of particular importance to you, please contact the office and we will be pleased to check the information for you, particularly if contemplating travelling some distance to view the property. None of the services or appliances to the property have been tested and any prospective purchasers should satisfy themselves as to their adequacy prior to committing themselves to purchase.

Referral Fees

Mortgage Services - We routinely refer all clients to APR Money Limited. It is your decision whether you choose to deal with APR Money Limited. In making that decision, you should know that we receive on average £60 per referral from APR Money Limited.

Conveyancing Services - If we refer clients to recommended conveyancers, it is your decision whether you choose to deal with this conveyancer. In making that decision, you should know that we receive on average £150 per referral.

Survey Services - If we refer clients to recommended surveyors, it is your decision whether you choose to deal with this surveyor. In making that decision, you should know that we receive up to £90 per referral.

Score	Energy rating	Current	Potential
92+	A		
81-91	B		88 B
69-80	C	79 C	
55-68	D		
39-54	E		
21-38	F		
1-20	G		



John German

75 Main Street, East Leake, Loughborough, Leicestershire, LE12 6PS

01509 856006

eastleake@johnngerman.co.uk



Ashbourne | Ashby de la Zouch | Barton under Needwood
Burton upon Trent | Derby | East Leake | Lichfield
Loughborough | Stafford | Uttoxeter

JohnGerman.co.uk Sales and Lettings Agent

