



5 Queen Elizabeth Crescent, Beaconsfield

Guide Price £1,457,600

*Ashington Page*



An exceptional 5-bedroom town house constructed by Berkeley St James to a very high standard. Situated within walking distance of both Beaconsfield Old and New Towns. The area is well-served by excellent educational institutions and commuters will appreciate the swift access to London Marylebone via the fast-track train line in Beaconsfield New Town, as well as the proximity to the M40 for easy connections to Heathrow Airport.

Tenure: Freehold

EPC: B

Council Tax: F

These particulars are for guidance only. They are prepared and issued in good faith and are intended to give a fair summary of the property. Any description should not be relied on as a statement or representation of fact or that the property, or its services, are in good condition. The photographs show only certain parts of the property at the time they were taken. Any areas, measurements or distance given are approximate only. Any reference to alterations to, or use of, any part of the property is not a statement that any necessary planning, building regulations or other consent has been obtained. These matters must be verified by an intending purchaser. All statements contained in these particulars in relation to the property are made without responsibility of Ashington Page or its clients. Neither Ashington Page (nor any joint agents) nor any of their employees has any authority to make or give any representation or warranty whatsoever in relation to the property

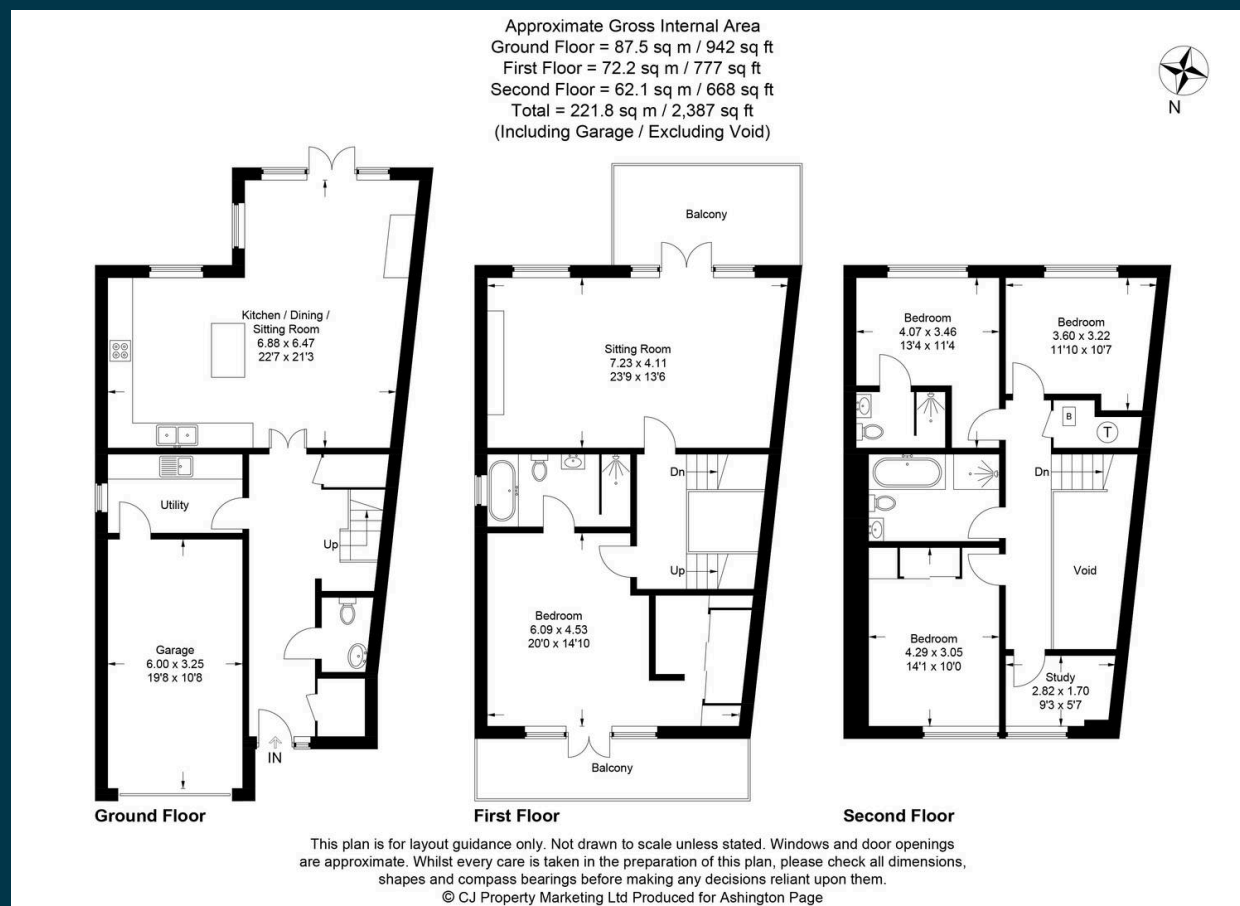

01494 680018  
[info@ashingtonpage.co.uk](mailto:info@ashingtonpage.co.uk)  
[www.AshingtonPage.co.uk](http://www.AshingtonPage.co.uk)

