



75 Studley Avenue, Holbury
£310,000

ANTHONY JAMES
PROPERTIES



75 Studley Avenue

Holbury, Southampton

Impressive Three/Four Bedroom House in Holbury offering versatile living accommodation. The property boasts an impressive living room leading to a conservatory, a refitted kitchen, and bathroom, as well as three reception rooms. The house also benefits from double glazing and gas fired central heating. Outside, the low maintenance rear garden features a large storage shed and artificial lawn area, ideal for relaxing. The property further offers gated storage space to the front, along with driveway parking for multiple cars.

The property is set within a favoured road of similar, purpose built homes and is positioned on the edge of The New Forest National Park. There are a wide range of local amenities nearby including shops, restaurants, bars and a supermarket along with schools catering for all age groups. Gang Warily recreation centre, Calshot Beach and Activity Centre, Lepe Country Park and Dibden Golf Course are all in proximity allowing many further outside interests to be enjoyed.

Council Tax band: C

Tenure: Freehold



1 Southward House
Dibden Purlieu SO45 4PT



T: 02380 844405

info@anthonyjamesproperties.co.uk



GROUND FLOOR
665 sq.ft. (61.8 sq.m.) approx.

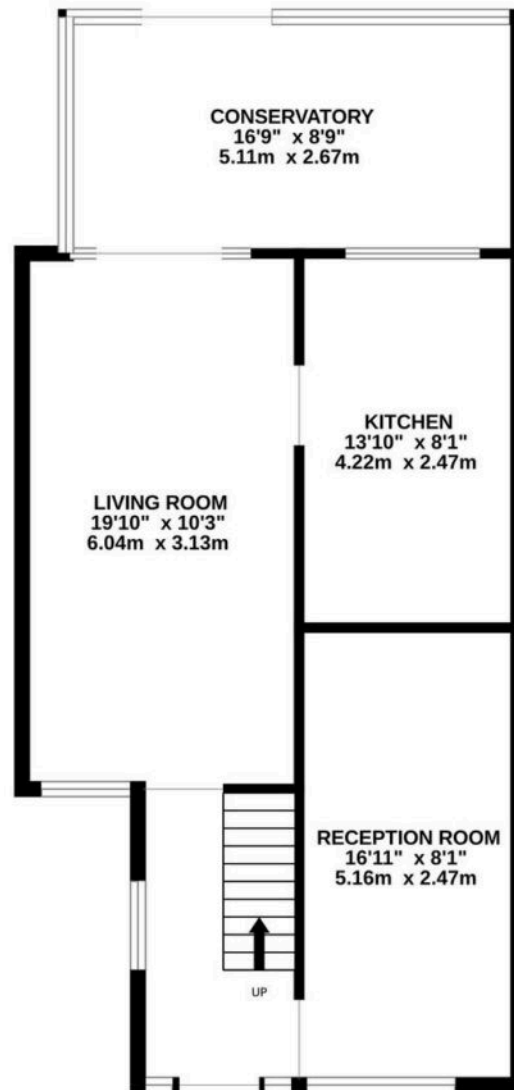

1ST FLOOR
450 sq.ft. (41.8 sq.m.) approx.

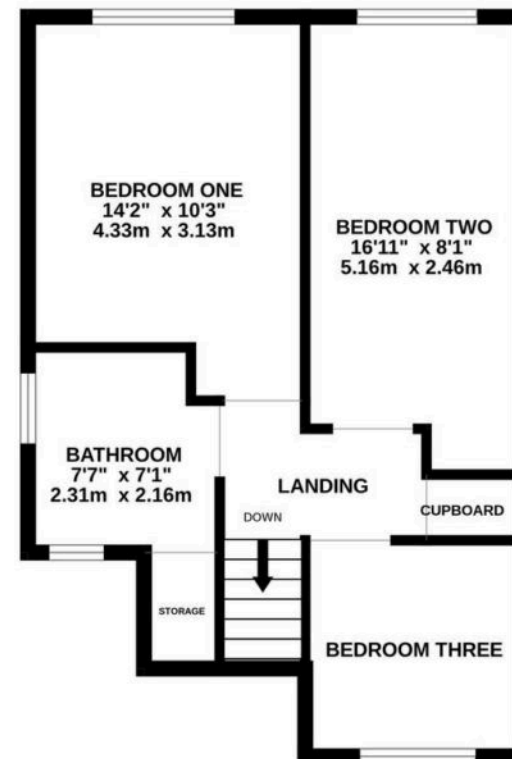

TOTAL FLOOR AREA : 1115 sq.ft. (103.6 sq.m.) approx.

Whilst every attempt has been made to ensure the accuracy of the floorplan contained here, measurements of doors, windows, rooms and any other items are approximate and no responsibility is taken for any error, omission or mis-statement. This plan is for illustrative purposes only and should be used as such by any prospective purchaser. The services, systems and appliances shown have not been tested and no guarantee as to their operability or efficiency can be given.
Made with Metropix ©2025