



1 bedroom Apartment located in Colchester.

Guide Price
£140,000 - £160,000

Find us on..



JOHN ALEXANDER
ESTATE AGENTS

Grosvenor Place Colchester Essex CO1 2ZD

FULL DESCRIPTION

OVERVIEW

GUIDE PRICE OF £140,000 - £160,000

John Alexander is proud to present a beautiful one-bedroom first floor apartment within Grosvenor Place positioned at the bottom of East Hill within a short walk of Colchester's bustling city centre and historic Castle Park. The property benefits from a spacious kitchen/living area, bedroom and bathroom and has the addition of an allocated parking space.

STEP INSIDE

This beautifully appointed first floor apartment can be accessed via a lift. Step inside to be greeted by a modern designed interior. The spacious living areas are bathed in natural light, exuding warmth and welcoming ambiance. A delightful Juliette balcony provides a seamless connection with the outdoors, allowing gentle breezes to sweep through the room. It's an ideal spot for enjoying a morning coffee or an evening sunset, enhancing the overall ambiance of the living space with its scenic views .

This well-proportioned residence benefits from gas radiator heating, double glazing, a contemporary fitted kitchen with an allocated parking space. The development also benefits from an indoor 10 metre heated pool which is solely for the use of the residents.

STEP OUTSIDE

The apartment is fortunate to look over both the River Colne and Colchester's historic Castle Park enabling outdoor space at your fingertips.

THE LOCATION

Grosvenor Place is in the heart of Colchester and boasts an enviable location combining urban convenience with serene surroundings. Just a stone's throw away from the vibrant city centre, you'll find an array of shops, eclectic restaurants, bustling theatres, and a modern cinema, ensuring endless entertainment options right on your doorstep.

A leisurely stroll across the nearby park leads you to North Station, providing direct links to Stratford and London in under an hour. This connectivity makes it an ideal choice for commuters seeking a tranquil home life with easy access to the capital's opportunities. Enjoy the best of both worlds with this perfectly positioned property.



1



1



1



B



B





FLOORPLAN

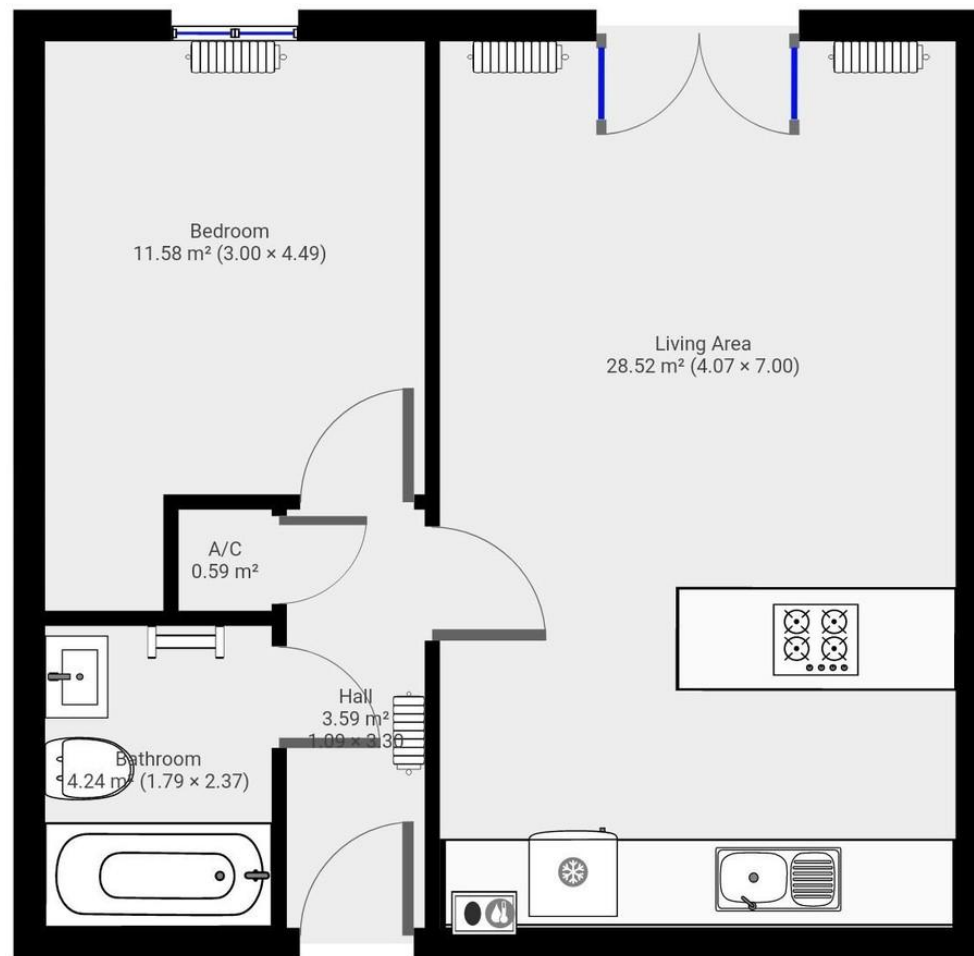

THIS FLOORPLAN IS PROVIDED WITHOUT WARRANTY OF ANY KIND. SENSOPIA DISCLAIMS ANY WARRANTY INCLUDING, WITHOUT LIMITATION, SATISFACTORY QUALITY OR ACCURACY OF DIMENSIONS.

DIRECTIONS

CONTACT

99 London Road
Stanway
Colchester
Essex
CO3 0NY

E sales@john-alexander.co.uk

T 01206 656007

www.john-alexander.co.uk

Find us on..

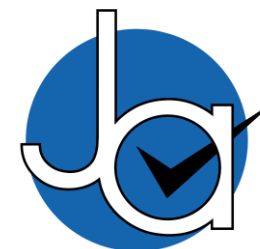

JOHN ALEXANDER
ESTATE AGENTS