



11 Yonder Way, Wanborough

Swindon

£500,000

McFarlan
property.co.uk

11 Yonder Way

Wanborough, Swindon

A well presented detached house offering generous accommodation in the popular Wanborough area. To the ground floor there is a generous sitting room, fitted kitchen/ breakfast room, dining room, utility, study and cloakroom. To the first floor there are three double bedrooms, all of which benefit from built in storage and with the master benefitting from an en-suit shower room. Additionally there is a generous single bedroom and a family bathroom. Externally the property is tucked away down a quiet cul-de-sac with driveway parking, double garage and a private landscaped garden.

Council Tax band: F

Tenure: Freehold

EPC Energy Efficiency Rating: D

EPC Environmental Impact Rating: D





11 Yonder Way Wanborough, Swindon

- DETACHED HOUSE
- FOUR BEDROOMS
- GENEROUS GARDEN
- SOUGHT AFTER LOCATION
- THREE RECEPTION ROOMS
- ONWARD CHAIN COMPLETE



11 Yonder Way
Wanborough, Swindon



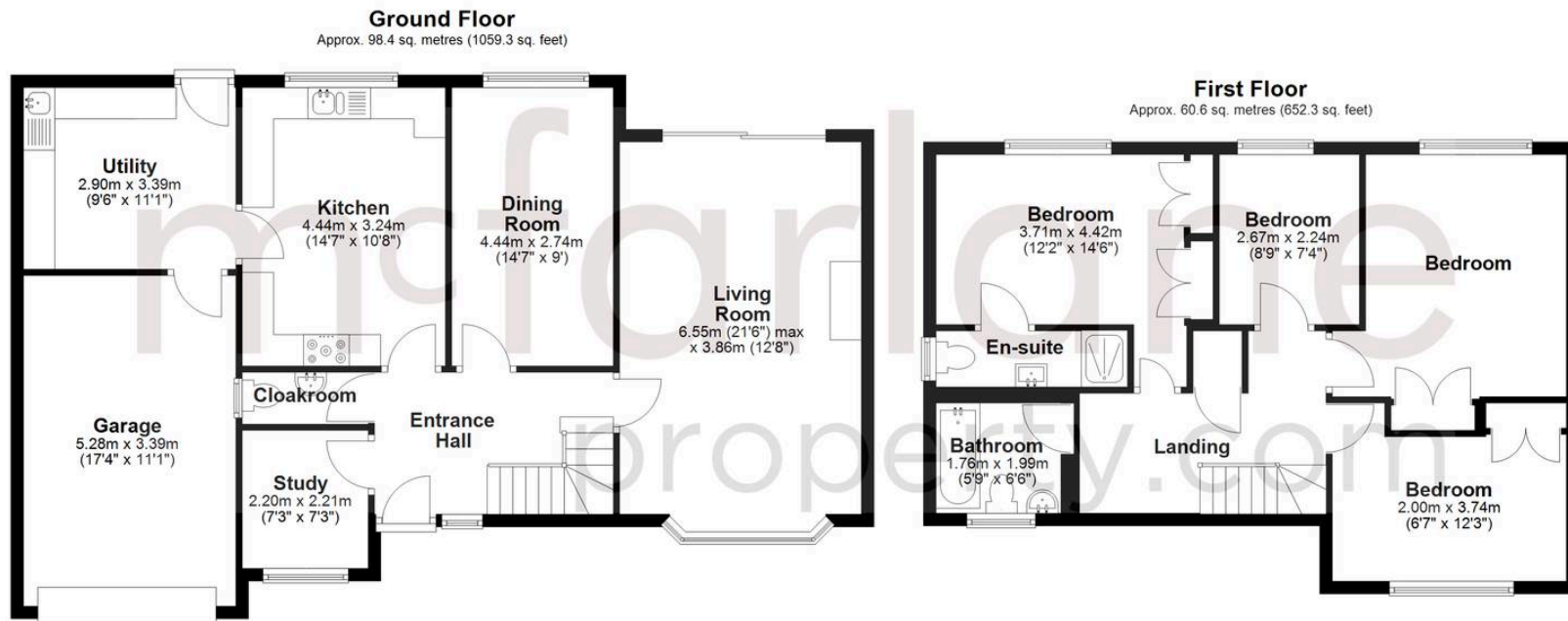

Total area: approx. 159.0 sq. metres (1711.6 sq. feet)

McFarlane Sales & Lettings

McFarlane Sales & Letting Ltd, 28-30 Wood Street – SN1 4AB

01793 296880 • oldtown@mcfarlaneproperty.com • www.mcfarlaneproperty.com/

mcfarlane
property.com