



£190,000

OFFERS IN REGION OF

HIGHFIELD DRIVE
CARLTON

- TWO BEDROOMS
- MODERN KITCHEN
- TWO RECEPTION ROOMS
- MODERN BATHROOM
- POPULAR LOCATION
- SOUTH FACING GARDEN
- EPC D



Beautifully Presented Two-Bedroom Mid-Terrace in Carlton

THIS CHARMING TWO-BEDROOM MID-TERRACED HOUSE OFFERS A DELIGHTFUL BLEND OF COMFORT AND CONVENIENCE, IDEAL FOR FIRST-TIME BUYERS OR INVESTORS. THIS PROPERTY ALSO BENEFITS FROM NO UPWARD CHAIN.

NESTLED IN THE HIGHLY SOUGHT-AFTER AREA OF CARLTON, THIS PROPERTY ENJOYS EXCELLENT ACCESS TO LOCAL AMENITIES, REGULAR BUS ROUTES AND SEAMLESS TRAVEL INTO NOTTINGHAM CITY CENTRE.

UPON ENTERING THROUGH A WELCOMING PORCH, YOU'RE GREETED BY A COSY LIVING ROOM. THE SEPARATE DINING ROOM PROVIDES A GREAT SPACE FOR ENTERTAINING OR FAMILY MEALS AND FEATURES STAIRS LEADING TO THE FIRST FLOOR AND HANDY UNDER-STAIRS STORAGE CUPBOARD ADDS EXTRA PRACTICALITY. A MODERN FITTED KITCHEN OFFERS AMPLE WORKSPACE, SPACE FOR APPLIANCES AND DIRECT ACCESS TO THE PRIVATE REAR GARDEN.

UPSTAIRS, THE FIRST FLOOR OFFERS TWO DOUBLE BEDROOMS AND A STYLISHLY DESIGNED BATHROOM SUITE.

OUTSIDE, THE LOW-MAINTENANCE REAR GARDEN FEATURES A PAVED PATIO AREA IDEAL FOR OUTDOOR DINING.

EARLY VIEWING IS STRONGLY RECOMMENDED.

- FREEHOLD
- COUNCIL TAX; BAND A
- LOCAL AUTHORITY; GEDLING BOROUGH COUNCIL
- MEASUREMENTS; 75 SQ METERS

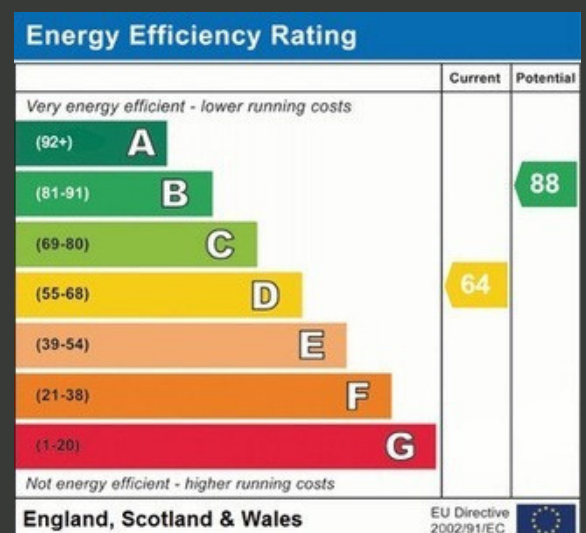



LESLEY

GREAVES

estate & letting agents



LESLEY

GREAVES

estate & letting agents

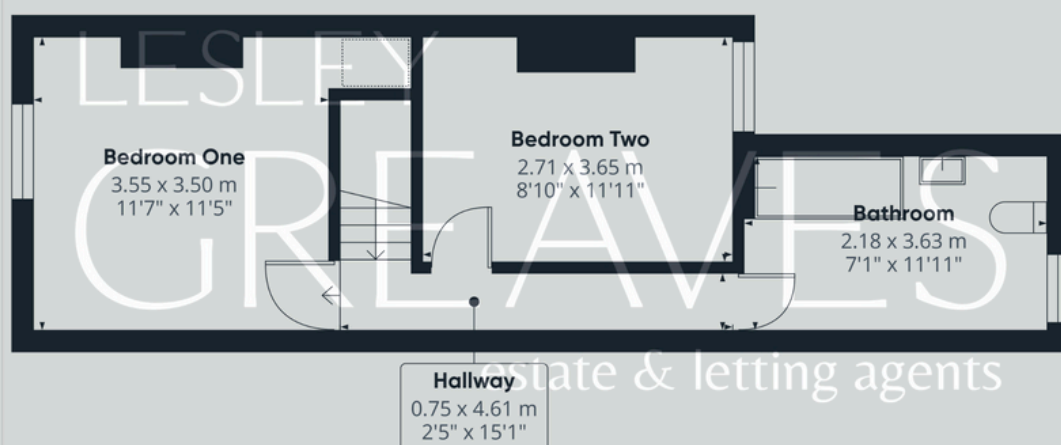

Agent's Note: These particulars have been prepared in good faith and are provided for guidance purposes only. While every effort has been made to ensure their accuracy, they should not be relied upon as exact. All measurements are approximate, and floor plans are for illustrative purposes only. Prospective buyers or tenants are advised to verify all details independently, conduct their own due diligence, and note that services, systems, and appliances have not been tested.

Lesley Greaves Estate & Lettings Agents

22 Main Road ,Gedling, Nottingham, NG4 3HP

0115 987 7337

sales@lesleygreaves.co.uk