

# Brick Kiln Lane

Ashby-de-la-Zouch, LE65 2WH

John  
German









# Brick Kiln Lane

Ashby-de-la-Zouch, LE65 2WH

£270,000

Stunning modern Ashberry home with open plan living, sleek finishes, and a stylish outdoor entertaining area. Set on a private drive near scenic countryside walks to Blackfordby, this beautifully upgraded home offers contemporary comfort and impressive indoor-outdoor flow.



John German 



This beautifully remodelled and upgraded Ashberry home offers exceptional modern living, featuring an open-plan ground floor layout designed to suit a contemporary lifestyle. Set along a shared private drive with generous parking, it also enjoys a picturesque position with a footpath opposite leading to scenic countryside walks into the charming village of Blackfordby - perfect for a relaxing stroll and a cosy pub lunch.

The entrance lobby welcomes you with a view straight through to the garden, setting the tone for the light-filled and flowing interior. To the left is a handy guest cloakroom, and stairs rise to the first floor with a useful storage cupboard to one side. Practical and stylish LVT flooring runs throughout the ground floor.

The kitchen area is well-equipped with sleek white high-gloss cabinetry, contrasting countertops, and a stainless steel sink with mixer tap and garden views. Appliances are fully integrated and include a gas hob with extractor, oven, fridge freezer, dishwasher, and washing machine.

There's ample space for both dining and lounge, all centred around the show-stopping bi-fold doors that bring the outdoors in and lead to a bespoke timber garden outdoor decked living room with slatted screening, ideal for year-round outdoor entertaining and perfect for alfresco dining or relaxing.

Upstairs, the principal bedroom benefits from its own private en-suite shower room and has two recessed spaces ideal for wardrobes. Two further bedrooms overlook the rear garden and are served by a modern family bathroom, which includes a white suite with panelled bath, mixer tap, electric shower, glazed screen, and WC.

Outside, the property is located on a shared private drive with ample off-road parking. The rear garden is larger than average, enjoying a sunny southerly aspect, mainly laid to lawn with a paved patio area - ideal for summer months.

**Tenure:** Freehold (purchasers are advised to satisfy themselves as to the tenure via their legal representative).

**Please note:** It is quite common for some properties to have a Ring doorbell and internal recording devices.

**Property construction:** Standard. **Parking:** Drive.

**Electricity supply:** Mains. **Water supply:** Mains. **Sewerage:** Mains. **Heating:** Gas  
(Purchasers are advised to satisfy themselves as to their suitability).

**Broadband type:** See Ofcom link for speed: <https://checker.ofcom.org.uk/>

**Mobile signal/coverage:** See Ofcom link <https://checker.ofcom.org.uk/>

**Local Authority/Tax Band:** North West Leicestershire District Council / Tax Band B

**Useful Websites:** [www.gov.uk/government/organisations/environment-agency](http://www.gov.uk/government/organisations/environment-agency)

**Our Ref:** JGA/15052025

The property information provided by John German Estate Agents Ltd is based on enquiries made of the vendor and from information available in the public domain. If there is any point on which you require further clarification, please contact the office and we will be pleased to check the information for you, particularly if contemplating travelling some distance to view the property. Please note if your enquiry is of a legal or structural nature, we advise you to seek advice from a qualified professional in their relevant field.

We are required by law to comply fully with The Money Laundering Regulations 2017 and as such need to complete AML ID verification and proof / source of funds checks on all buyers and, where relevant, cash donors once an offer is accepted on a property. We use the Checkboard app to complete the necessary checks, this is not a credit check and therefore will have no effect on your credit history. With effect from 1<sup>st</sup> March 2025 a non-refundable compliance fee of £30.00 inc. VAT per buyer / donor will be required to be paid in advance when an offer is agreed and prior to a sales memorandum being issued.









Ground Floor

Approximate total area<sup>(1)</sup>

895 ft<sup>2</sup>

83.1 m<sup>2</sup>

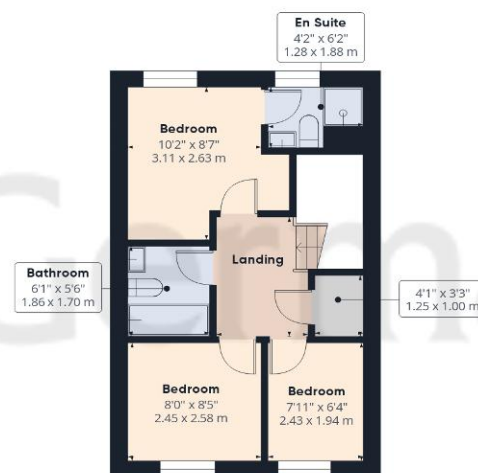

Floor 1

(1) Excluding balconies and terraces

While every attempt has been made to ensure accuracy, all measurements are approximate, not to scale. This floor plan is for illustrative purposes only.

Calculations were based on RICS IPMS 3C standard. Please note that calculations were adjusted by a third party and therefore may not comply with RICS IPMS 3C.

GIRAFFE360



## Agents' Notes

These particulars do not constitute an offer or a contract neither do they form part of an offer or contract. The vendor does not make or give and Messrs. John German nor any person employed has any authority to make or give any representation or warranty, written or oral, in relation to this property. Whilst we endeavour to make our sales details accurate and reliable, if there is any point which is of particular importance to you, please contact the office and we will be pleased to check the information for you, particularly if contemplating travelling some distance to view the property. None of the services or appliances to the property have been tested and any prospective purchasers should satisfy themselves as to their adequacy prior to committing themselves to purchase.

## Referral Fees

**Mortgage Services** - We routinely refer all clients to APR Money Limited. It is your decision whether you choose to deal with APR Money Limited. In making that decision, you should know that we receive on average £60 per referral from APR Money Limited.

**Conveyancing Services** - If we refer clients to recommended conveyancers, it is your decision whether you choose to deal with this conveyancer. In making that decision, you should know that we receive on average £150 per referral.

**Survey Services** - If we refer clients to recommended surveyors, it is your decision whether you choose to deal with this surveyor. In making that decision, you should know that we receive up to £90 per referral.

| Score | Energy rating | Current | Potential |
|-------|---------------|---------|-----------|
| 92+   | A             |         | 97 A      |
| 81-91 | B             | 84 B    |           |
| 69-80 | C             |         |           |
| 55-68 | D             |         |           |
| 39-54 | E             |         |           |
| 21-38 | F             |         |           |
| 1-20  | G             |         |           |



## John German

63a Market Street, Ashby-De-La-Zouch, Leicestershire, LE65 1AH

01530 412824

ashbysales@johnngerman.co.uk



Ashbourne | Ashby de la Zouch | Barton under Needwood  
Burton upon Trent | Derby | East Leake | Lichfield  
Loughborough | Stafford | Uttoxeter

JohnGerman.co.uk Sales and Lettings Agent



