





16 Lea Road

Hayfield, High Peak

Council Tax band: C

Tenure: Freehold

- Large garden
- Double garage and workshop
- Desirable location
- Kitchen extension
- Semi-detached
- Chain-free







Floor 0

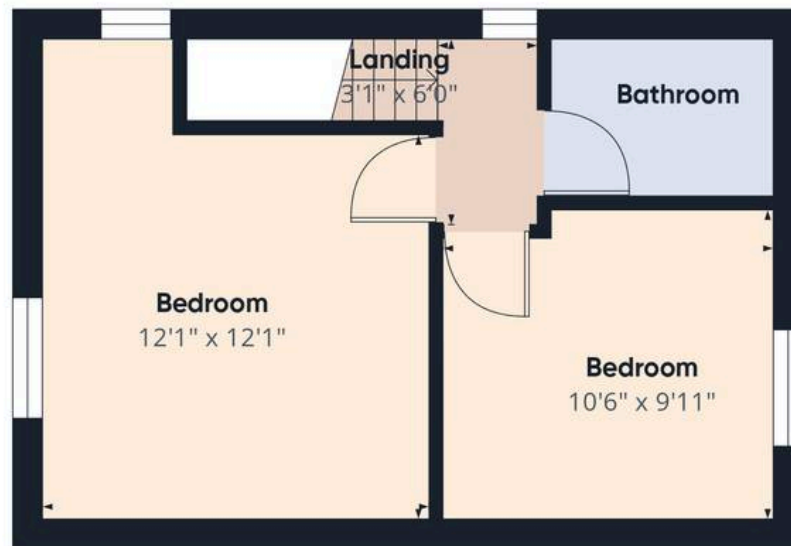

Floor 1

Approximate total area⁽¹⁾

787 ft²

Reduced headroom

9 ft²

(1) Excluding balconies and terraces

Reduced headroom

..... Below 5 ft

While every attempt has been made to ensure accuracy, all measurements are approximate, not to scale. This floor plan is for illustrative purposes only.

Calculations are based on RICS IPMS 3C standard.

GIRAFFE360

AWARD WINNING ESTATE
& LETTING AGENTS

SCAN THE QR CODE
FOR MORE DETAILS
OR BOOK A VIEWING

