



3 Bedroom Penthouse Apartment Hollyfield Road, Surbiton. £610,000 Share of Freehold / 999 year lease

The Penthouse - Hollyfield Road, Surbiton

Foyle Court, a brand new boutique development of just 7 luxury homes.

The 3 bedroom penthouse apartment is located on the 3rd/Top Floor, 920 sq ft of internal living space with a full width terrace accessed via 2 sets of double doors from the reception room and double doors from one of the bedrooms.

An exclusive development of just 7 brand new apartments ideally situated on Hollyfield Road, directly opposite Fishponds Conservation area, a haven and tranquil retreat with parkland, ponds and wildlife.

All 7, high specification apartments have been finished to an exemplary standard within the art deco designed development reflecting the style of Surbiton and Surbiton Station and are located within a short walk to Surbiton Station with frequent

high speed trains, taking just 19 minutes to London Waterloo.

Please note floorplans and images are for illustration purposes only.

WWW.STACKANDBONNER.COM

020 8974 8844

sales@stackandbonner.com



Foyle Court,
 Hollyfield Road, KT5
 Approximate Gross Internal Area
 85.43 sq m / 920 sq ft

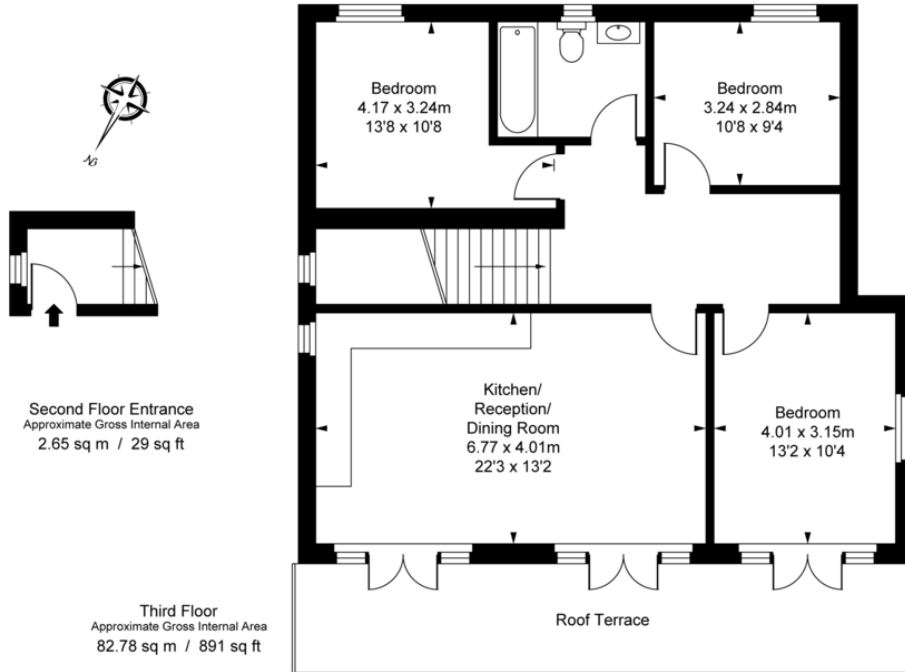

ILLUSTRATION FOR IDENTIFICATION PURPOSES ONLY
 ALL MEASUREMENTS AND AREA FIGURES SUPPLIED BY OTHERS. ACCURACY IS NOT GUARANTEED.
 THIS PLAN MUST NOT BE REPRODUCED BY ANY OTHER PERSON WITHOUT PERMISSION

- 3 Bedroom Penthouse Apartment
- Brand New Boutique Development of 7 Luxury Homes
- Private Full Width Terrace
- Open Plan Living/ Kitchen / Dining Room
- Luxury Bathroom
- High Specification Throughout
- 920 Sq ft
- 3rd / Top Floor
- Located Opposite Fishponds Conservation Area
- Close to Local Amenities and within a short walk of Surbiton Station
- Predicted Service Charge: £1,775 per annum
- Share of Freehold with a 999 year underlying lease