



## 23 Deridene Court, Totton – SO40 8WS

£270,000 Freehold

An excellent opportunity to acquire an appealing end of terrace home set within a popular, cul-de-sac location. Internally, this property boasts a well-thought-out layout, featuring two double bedrooms (with fitted wardrobes) alongside a shower room. The ground floor comprises of an entrance hall, a kitchen and a living room, creating a comfortable flow throughout the home. Outside, there is an enclosed rear garden enjoying natural screening to the rear. Additionally, you will find allocated parking within an adjacent courtyard, and a front garden modified to allow hard standing for a parking space, ensuring practicality for residents. Further features include gas central heating and UPVC double glazed windows. The property is offered for sale with no onward chain, presenting an attractive option for those seeking a well-located home they can put their own stamp on.



GROUND FLOOR

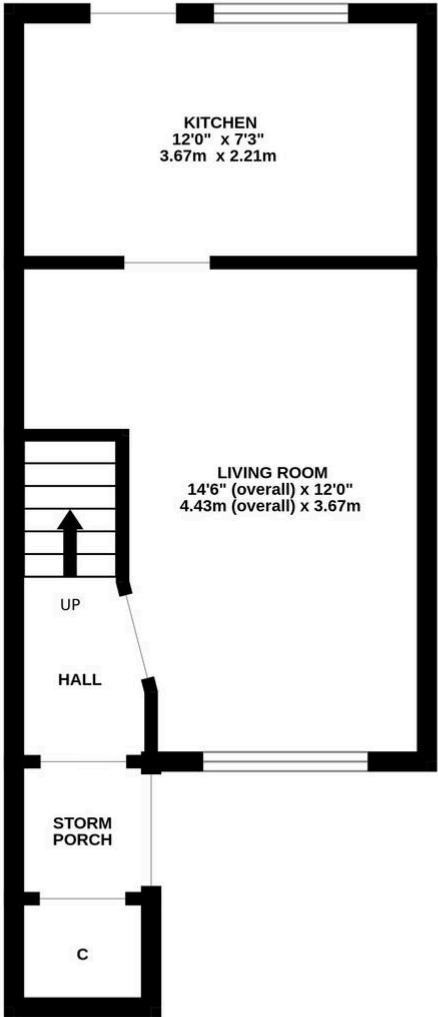

1ST FLOOR

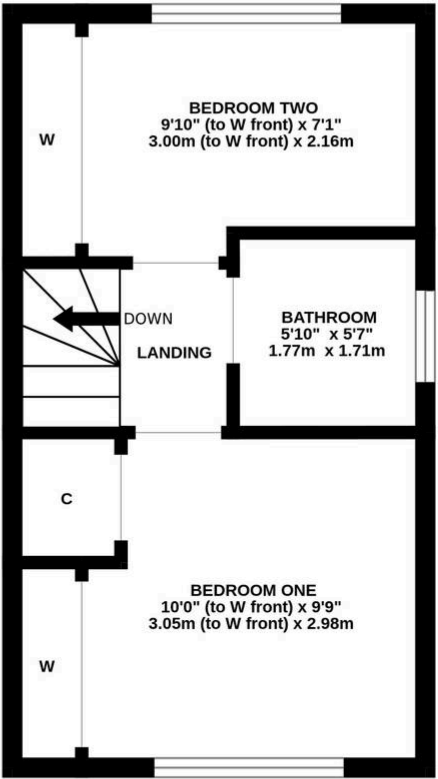

Whilst every attempt has been made to ensure the accuracy of the floorplan contained here, measurements of doors, windows, rooms and any other items are approximate and no responsibility is taken for any error, omission or mis-statement. This plan is for illustrative purposes only and should be used as such by any prospective purchaser. The services, systems and appliances shown have not been tested and no guarantee as to their operability or efficiency can be given.  
Made with Metropix ©2025

You can include any text here. The text can be modified upon generating your brochure.