

Davidson



ORION BIRMINGHAM, B5 4AE

£975 PCM

ORION BUILDING | One Bedroom + Study | Furnished | Secure Parking |
Communal Terrace | 24 hour Concierge | Fantastic location | Available 10th
February 2026
Council Tax Band: E EPC: B



ORION BUILDING | One Bedroom + Study | Furnished | Secure Parking | Communal Terrace

Full Description

Davidson Estates are delighted to present this modern one bedroom apartment with separate study room located within the Orion Building.

The apartment is contemporary by design and comprises of a large entrance hallway leading beautifully through to the open-plan living area boasting views of the city. There is a fully integrated kitchen with appliances included.

The bedroom comes with plenty of storage space and also a separate study room and a large separate bathroom with shower over bath.

The property benefits from secure entrance, communal courtyard and 24 hour concierge service.

City Centre Location

Ideally located in Birmingham City Centre, the property is within easy reach of a wide range of amenities, including the renowned Bullring Shopping Centre. Excellent transport links are on hand, with trams and buses providing access to key areas such as

Brindleyplace, Colmore Row, and Edgbaston. Grand Central Station, the UK's busiest station outside London, offers national rail connections, making this an ideal location for commuters. With the upcoming HS2 Curzon Street station, the city continues to evolve, reinforcing Birmingham City Centre as a highly desirable place to live and invest.

Council Tax Band: E

EPC Rating: B



24 hour Concierge | Fantastic location | Shower over Bath | Available 10th February

2026 |



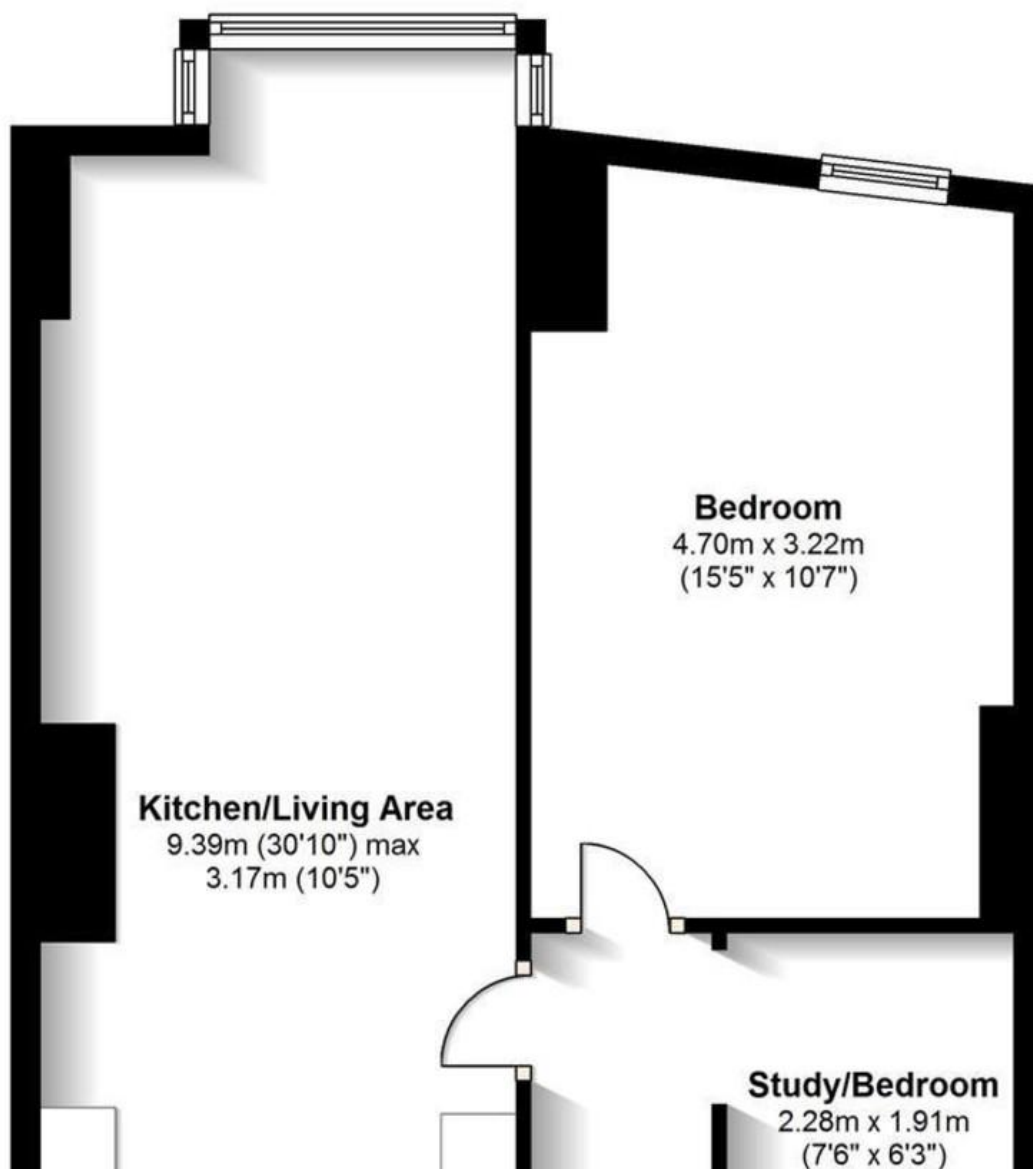

| Score | Energy rating | Current | Potential |
|-------|---------------|---------|-----------|
| 92+ | A | | |
| 81-91 | B | 82 B | 87 B |
| 69-80 | C | | |
| 55-68 | D | | |
| 39-54 | E | | |
| 21-38 | F | | |

Davidson

OFFICE
22 Harborne Road
Birmingham
West Midlands

0121 455 7727
info@davidsonstates.co.uk
www.davidsonstates.co.uk

Agents Note: Whilst every care has been taken to prepare these particulars, they are for guidance purposes only. All measurements are approximate and are for general guidance purposes only and whilst every care has been taken to ensure their accuracy, they should not be relied upon and potential buyers/tenants are advised to recheck the measurements