

The Middleton

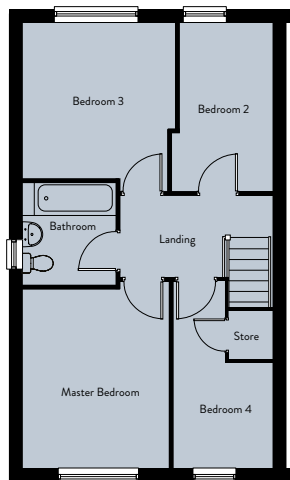
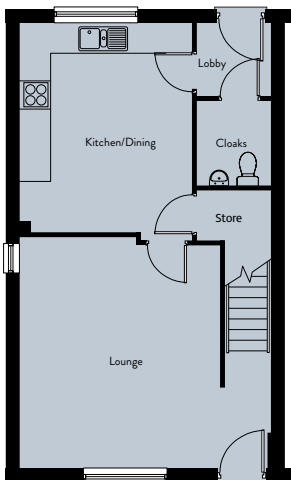

Ground Floor

Lounge	4.31m x 4.87m	14'2" x 16'0"
Kitchen/Dining	3.71m x 4.46m	12'2" x 14'8"

First Floor

Master Bedroom	3.15m x 3.77m	10'4" x 12'4"
Bedroom 2	1.96m x 3.60m	6'5" x 11'10"
Bedroom 3	3.27m x 3.31m	10'9" x 10'10"
Bedroom 4	2.17m x 2.10m	7'2" x 6'9"