



15 Shaftesbury Mount
Camberley, GU17 9JR

£315,000 Offers In Excess Of

Property Details

-  2 bedrooms
-  1 baths
-  EPC Rating C
- 
-  Station Name (0.0 miles)
- Freehold house
 - Refurbished and modernised and repainted
 - Reduced to below suggested price due to work relocation
 - Pet and smoke free home
 - Popular estate location
 - Recent Gas safety and boiler certificate
 - 2024
- Ideal buy for First timers or investors

NO ONWARD CHAIN COMPLICATIONS.A superbly presented and modernised two bedroom freehold home which has been thoroughly insulated and is located in this quiet close on this sought after development near to Hawley woods but also ideally situated for local shops amenities and transport links.

Our clients comment. "I've loved living here. Surrounded by a fantastic community spirit with so many warm friendly and welcoming neighbours. Nicely tucked away in a quiet close and right next to a large open green and Hawley Woods, perfect for scenic walks and bike rides. Working in Central London this location is perfect for commuting with fast trains from Farnborough Main. I've invested my heart in this house completing a full renovation giving it the TLC it deserves. The property comes with private residential parking space directly outside the house. It is a freehold home so no nasty charges! I bought this house to stay here long term but sadly relocating for work purposes.

Schooling Facilities

School Name: x minute drive
School Name: x minute drive
School Name: x minute drive

Council Tax Band: Tax band
Local Authority:
Tenure: Freehold

Viewings

[insert text here]
[01276 534100 / james@seymours-blackwater.co.uk](mailto:james@seymours-blackwater.co.uk)

Transport Links
Name: 0.0 miles | Name: 0.0 miles | Name: 0.0 miles

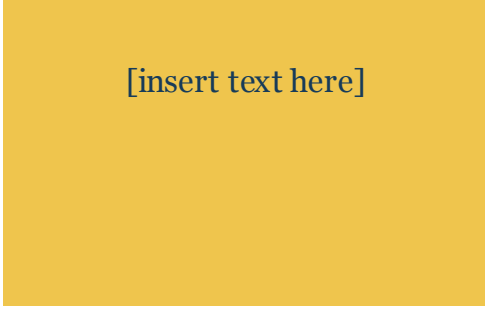

Property Details

Shaftesbury Mount

Approximate Gross Internal Area = 54.7 sq m / 589 sq ft (excludes store)

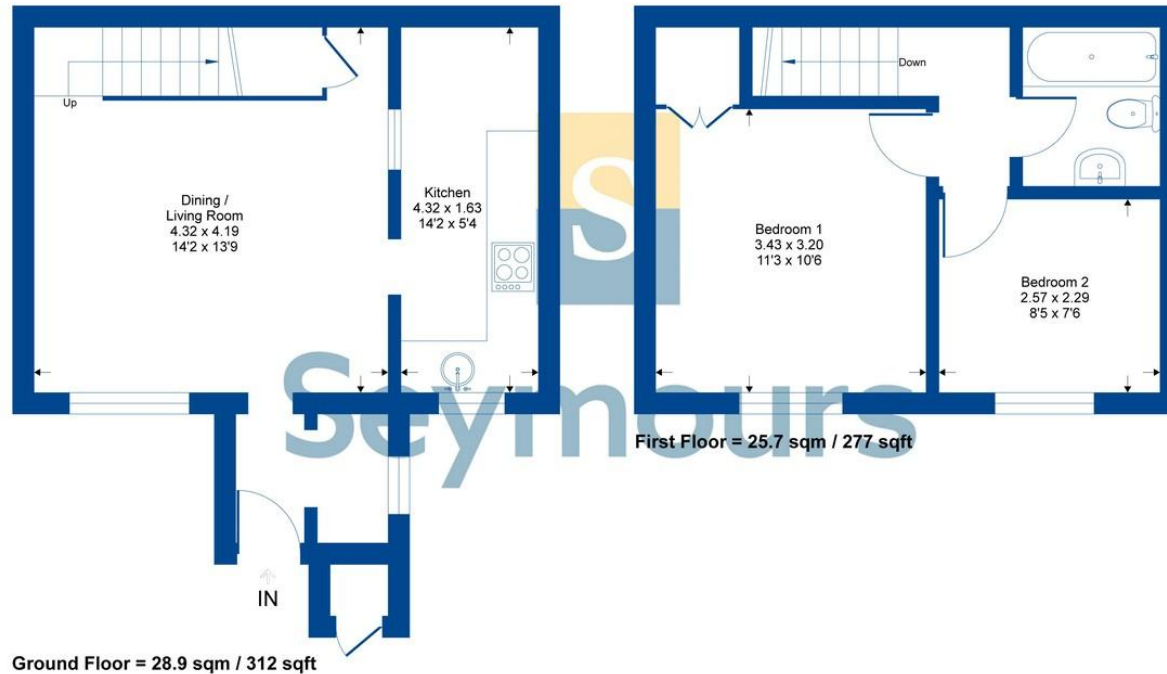

Whilst every attempt has been made to ensure the accuracy of the floor plan contained here, measurements of doors, windows, rooms and any other items are approximate and no responsibility is taken for any error, omission or mis-statement. This plan is for illustrative purposes only and should be used as such by any prospective purchaser.



Seymours Blackwater Office 6 Kings Parade, 34 London Road, Blackwater, Camberley, Surrey, GU17 9AA

01276 534100 / james@seymours-blackwater.co.uk / seymours-estates.co.uk

The information contained in these Sales Particulars does not form part of any contract neither is any warranty given or implied by Seymours or their clients as to the accuracy of measurements of details stated. Every effort is made to ensure that our Sales Particulars are correct and reliable. We do not test service, systems and appliances and we are unable to verify they are in working order.