

Longs Mill, Brookbridge Court, Derby

aksresidential.com

Offers in the region of
£145,000



This property at a glance:



1



2



1



1



B



Watch the video



Longs Mill, Brookbridge Court, Derby



Sam says:

"This apartment is lovely and full of unique detail! Originally built in the 1800's it has undertaken a luxury mill conversion into a complex of modern and spacious apartments. There are large, bright windows and tall ceilings creating a space filled with natural light, making the apartment feel grand and spacious. The living room and kitchen are spacious and open plan. There is an integrated dishwasher and space for a free standing washing machine too. There is even an alcove area off the living room for additional storage which is really handy! With two generous double bedrooms and a three piece suite bathroom this is a great space! Being in a prime location near to the city, the apartment is within a gated complex with secure parking. With lift access to the apartment, anyone can enjoy this homely property which would suit working professionals and students alike!"



aksresidential.com



Longs Mill, Brookbridge Court, Derby



Did you spot...

The old windows,
a great feature
capturing the
1800's charm?



A message from the seller:

"This was my first home and I fell in love with it the instant I walked through the door. The large windows allow so much fresh sunlight and air, I always felt safe and calm, and ready to enjoy whatever city life would send my way. Being so close to the city, date nights, brunch and shopping were always easy to plan, yet it was quick and convenient to get out of the city as it is so well positioned for joining the road network. I moved out of the city after 3 years and decided to rent the apartment out. Due to all the positive things above, the flat has been constantly occupied, and as the fittings were upgraded before I left, the apartment takes care of itself. As I enter a new chapter in my life, it is sad to part with such a beautiful home, but it is time for it to be a happy part of someone else's story."





Floor Plan



aksresidential.com

Floor Plan

Approx. 61.3 sq. metres (659.8 sq. feet)

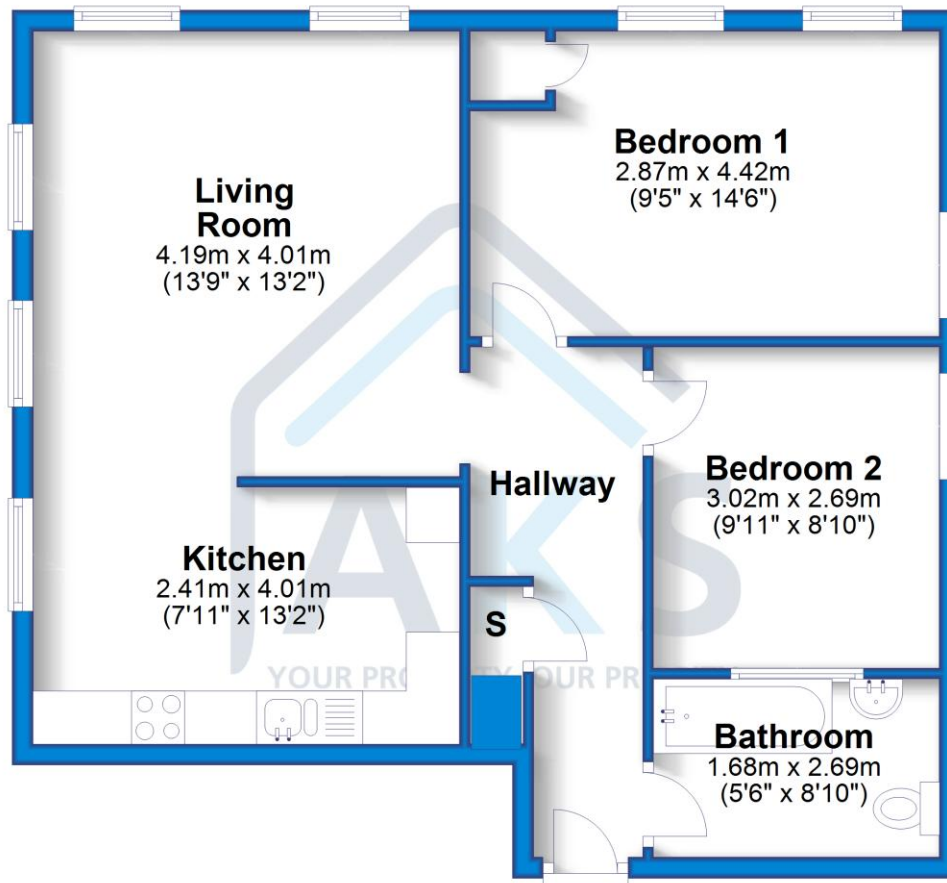

Total area: approx. 61.3 sq. metres (659.8 sq. feet)



Energy Performance Certificate

Score	Energy rating	Current	Potential
92+	A		
81-91	B	81 B	81 B
69-80	C		
55-68	D		
39-54	E		
21-38	F		
1-20	G		



200+ 5 star Google Reviews



Key Features:

- TWO DOUBLE BEDROOM APARTMENT WITHIN A CONVERTED MILL
- OPEN PLAN LIVING
- LIFT ACCESS
- SECURE GATED PARKING
- SITUATED ON THE EDGE OF THE CITY CENTRE
- EPC RATING: B



About the area:

This apartment is situated just off Brook and Bridge Street meaning its only a 5 minute walk to the city centre, a 30 minute walk to Derby Railway Station and has a range of bus stops 0.1 - 0.2 miles away which take you across the whole of Derby.

The apartment also offers a range of amenities nearby with a Coop, Sainsburys and ASDA Express less than 0.2 miles down the road.

If you also want a break from the excitement of city life you are only 1 mile from Marketon Park, Darley Park and Derby Arboretum which are all family friendly places to take a stroll around!



Schools:

Along with a range of educational institutions such as Ashgate Primary School, Derby Cathedral School and parts of the University of Derby all within walking distance.



Don't miss out on the chance to own this incredible property!

To book a viewing with **Sam** call
01332 30 30 30

Click [here](#) to watch the property video

