



4 Hatfield House Teesdale Road, London

London

Guide Price £395,000



## 4 Hatfield House Teesdale Road

London, London

Discover this three-bedroom flat in Leytonstone, chain-free status, share of freehold, and proximity to the underground tube station. Spacious interiors, three double bedrooms, shared garden + garage. Council Tax band: C

Tenure: Freehold

EPC Energy Efficiency Rating: C

EPC Environmental Impact Rating: G

- Chain free
- Share of Freehold
- Within walking distance to Leytonstone underground tube station
- 3 double bedrooms
- Shared garden
- Garage
- Being Sold via Secure Sale online bidding. Terms & Conditions apply. Starting Bid £395,000



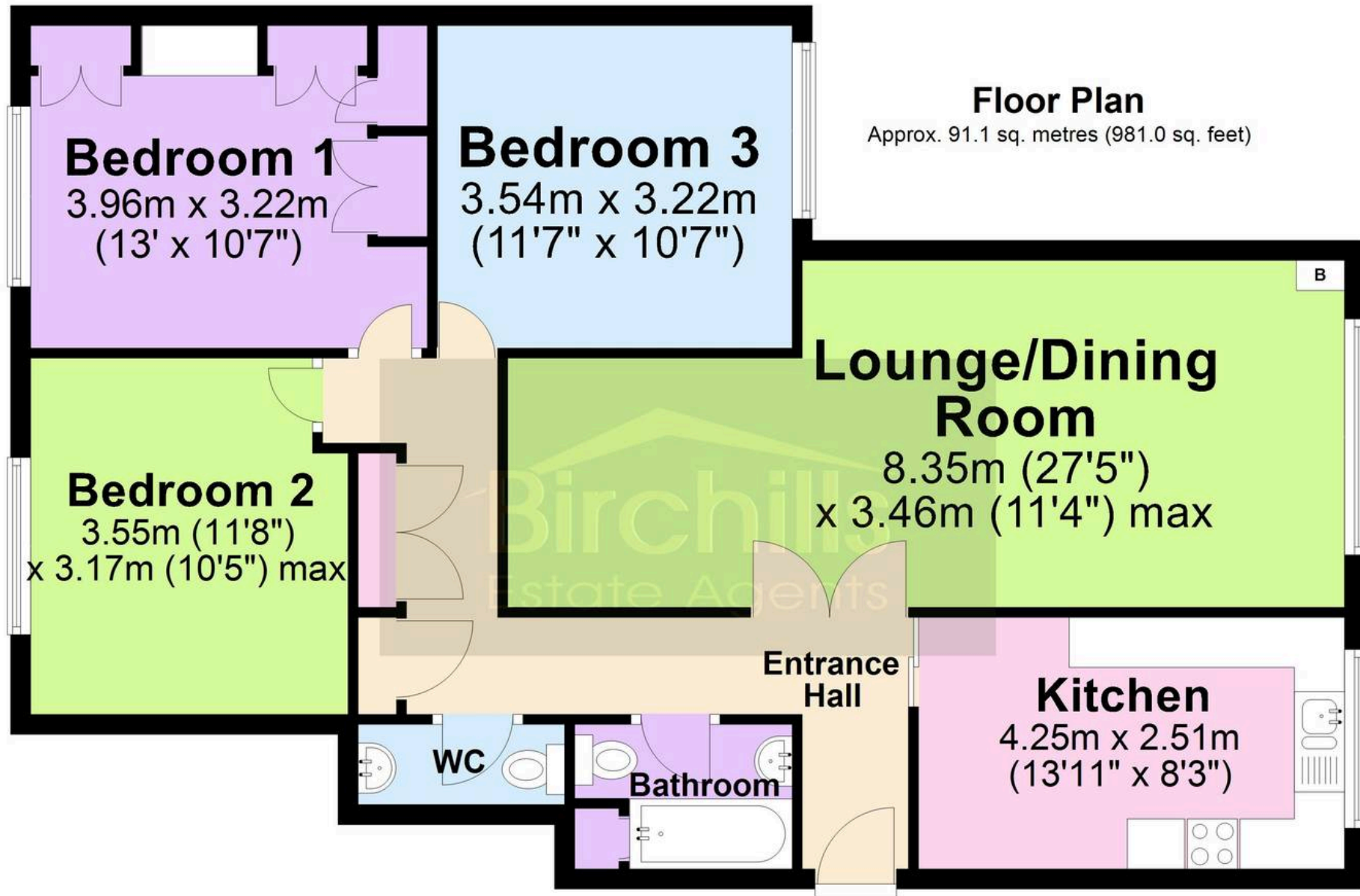

Total area: approx. 91.1 sq. metres (981.0 sq. feet)

Illustrations are for viewing purposes only. Measurements are not to scale. Property Total and Floor Totals are internal figures only and do not include Balconies, Garden, Patios or Terraces if shown. Floor Area of any Outbuilding may be included in overall Total.

Plan produced using PlanUp.