





Hiltons Estates proudly present this exceptional 6-bedroom, 6-bathroom detached home located in a quiet and peaceful luxury area. Spanning approximately 3,190 sq ft, this spacious 1940s-built property features three reception rooms, two en-suites, a modern kitchen, and ample living space throughout.

The home benefits from a large private garden and an extensive driveway with space for over eight cars, offering practicality alongside elegance. This is a perfect forever home for families seeking comfort, space, and tranquillity in one of the area's most desirable neighbourhoods.

Viewings are highly recommended!

6 spacious bedrooms

6 bathrooms including 2 en-suites

3 generous reception rooms

Driveway for 8+ cars

Large private garden



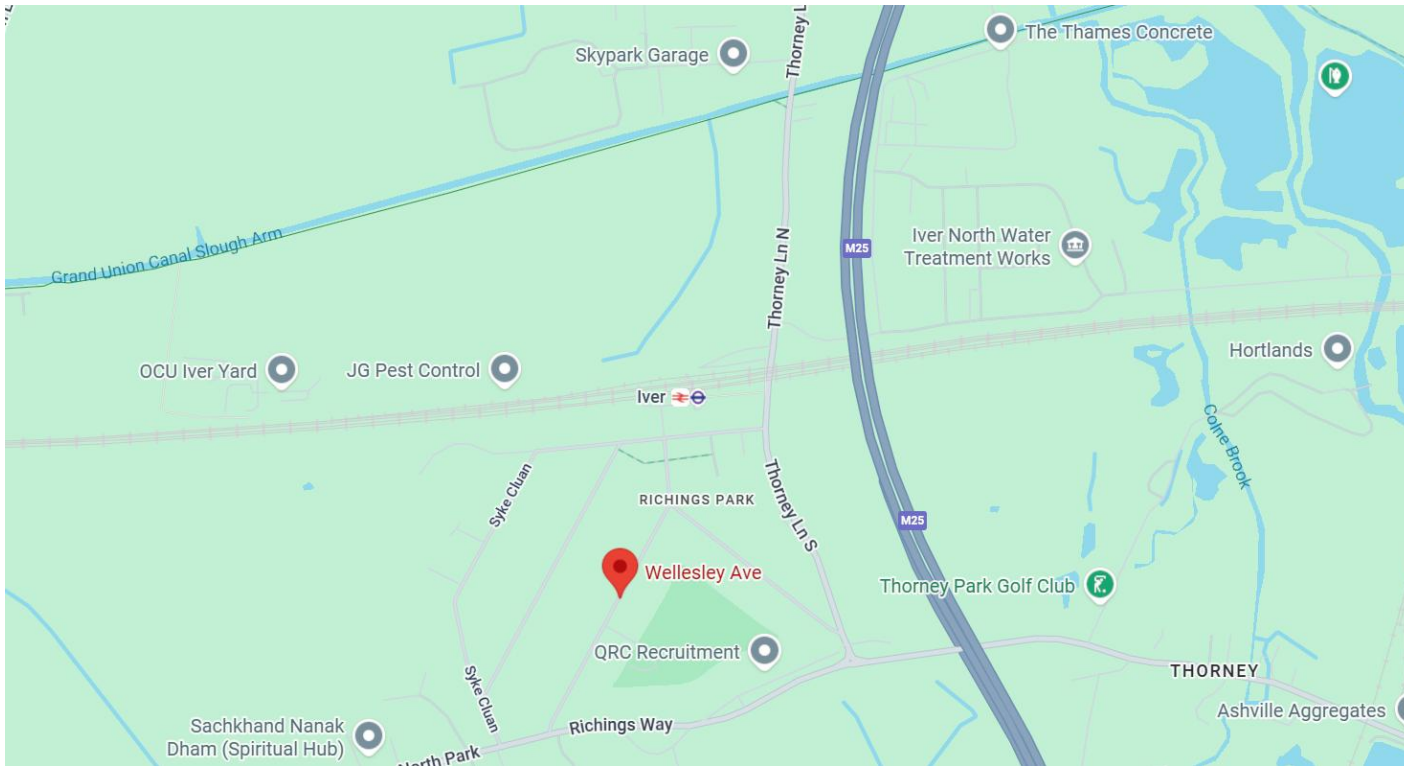

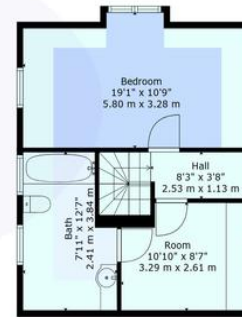

TOTAL: 2965 sq. ft, 276 m²
 FLOOR 1: 1634 sq. ft, 152 m², FLOOR 2: 1045 sq. ft, 97 m², FLOOR 3: 286 sq. ft, 27 m²
 EXCLUDED AREAS: PORCH: 19 sq. ft, 2 m², LOW CEILING: 148 sq. ft, 14 m²
 WALLS: 206 sq. ft, 18 m²

Provided For General Guidance And Illustrative Purposes Only. While Every Effort Has Been Made To Ensure Accuracy, Measurements And Layouts Are Approximate And Not To Scale. These Plans Should Not Be Relied Upon For Valuation, Legal, Or Mortgage Purposes. We Recommend All Interested Parties Carry Out Their Own Inspections And



Score	Energy rating	Current	Potential
92+	A		
81-91	B		82 B
69-80	C	80 C	
55-68	D		
39-54	E		
21-38	F		
1-20	G		

Hiltons Estates, 137 Western Road
Southall, UB2 5HN

www.hiltons-estates.com
email: harvin@hiltons-estates.com
0208 867 9555 / 07961 527301

Agents Note: Whilst every care has been taken to prepare these sales particulars, they are for guidance purposes only. All measurements are approximate are for general guidance purposes only and whilst every care has been taken to ensure their accuracy, they should not be relied upon and potential buyers are advised to recheck the measurements.