



14 Sunningdale Road

Swindon

Offers in Region of £274,000

mtarlane
property.com



14 Sunningdale Road

UNEXPECTEDLY REAVAILABLE - Welcome to this charming 60's-built 3-bedroom semi-detached house that comes with NO ONWARD CHAIN! This property boasts a classic BAY FRONTED design, adding character to the neighbourhood. Inside, you'll find a convenient DOWNSTAIRS TOILET for guests and a FAMILY BATHROOM.

The spacious and inviting interior offers a comfortable living space for the whole family. The GENEROUS SIZED GARDEN is perfect for enjoying the outdoors and entertaining friends and family. Parking will never be an issue with a GARAGE and space for 3 CARS.

This property is the perfect canvas for you to create your dream home. Don't miss out on the opportunity to make this 3-bedroom semi-detached house your own! Contact us today to schedule a viewing and make your offer before it's gone!



- NO ONWARD CHAIN
- 60'S BUILD
- BAY FRONTED
- 3 BEDROOM SEMI-DETACHED
- DOWNSTAIRS TOILET
- FAMILY BATHROOM
- GENEROUS SIZED GARDEN
- GARAGE + PARKING FOR 3 CARS



Ground Floor

Approx. 55.7 sq. metres (599.7 sq. feet)

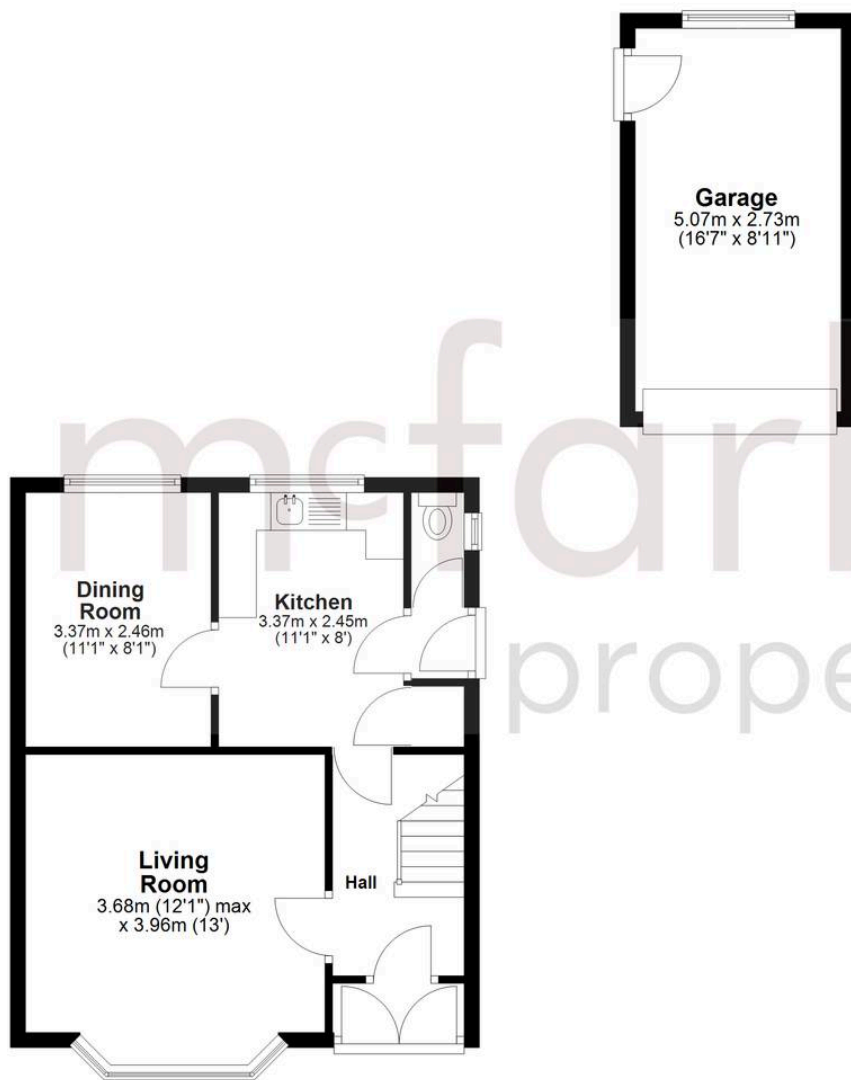

First Floor

Approx. 41.7 sq. metres (448.4 sq. feet)

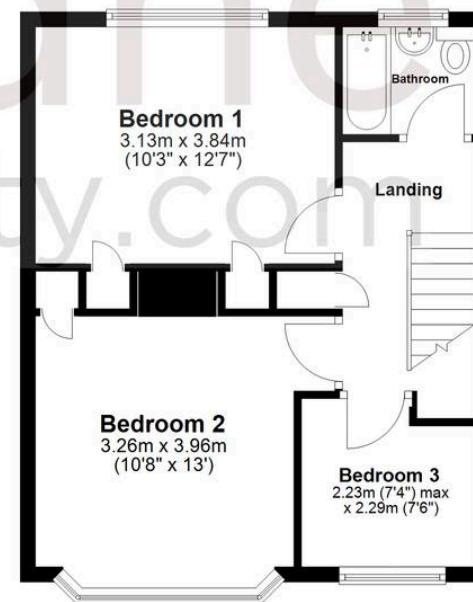

Total area: approx. 97.4 sq. metres (1048.1 sq. feet)

McFarlane Sales & Lettings

North Swindon, Redhouse Village Centre, Swindon – SN25 2FW

01793 296600 • swindon@mcfarlaneproperty.com • www.mcfarlaneproperty.com/