



GROUND FLOOR

Living Room	5490mm x 3755mm	18'0" x 12'4"
Kitchen/Dining	7230mm x 2630mm	23'9" x 8'6"
Utility	2110mm x 1990mm	6'9" x 6'5"
WC	1710mm x 1210mm	5'6" x 4'0"

◀▶ - DIMENSION LOCATION

All images used are for illustrative purpose only. Dimensions given are illustrative for this house type and individual properties may differ. Please check with your Sales Executives in respect of individual properties. We give maximum dimensions within each room and these may include areas of fixtures and fittings including fitted furniture. These dimensions should not be used for carpet or flooring sizes, appliance spaces or items of furniture. All images, photographs and dimensions are not intended to be relied upon for, nor to form part of any contract unless specifically incorporated in writing into the contract.

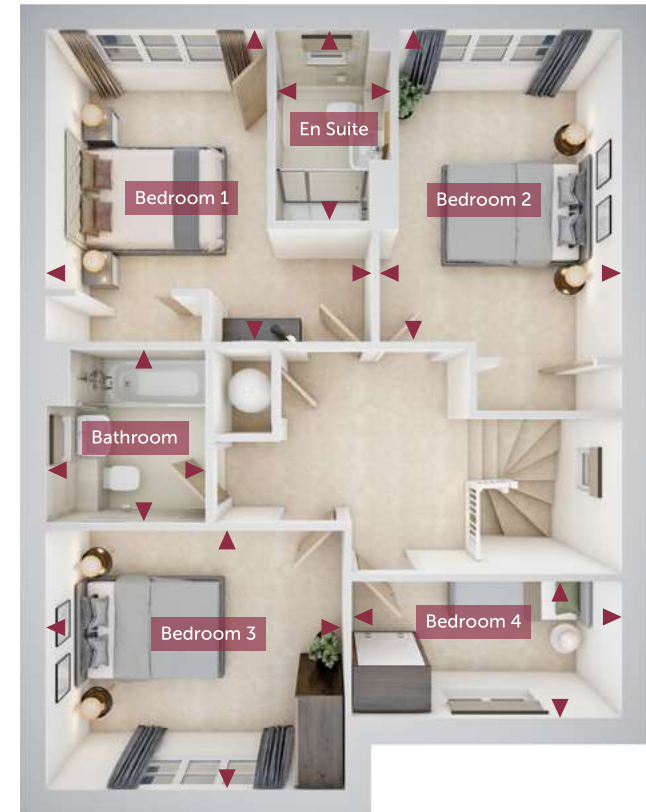

FIRST FLOOR

Bedroom 1	4100mm x 3910mm	13'5" x 12'10"
En Suite	2410mm x 1460mm	7'11" x 4'10"
Bedroom 2	4120mm x 3040mm	13'5" x 10'0"
Bedroom 3	3750mm x 3240mm	12'4" x 10'8"
Bedroom 4	3380mm x 1710mm	11'1" x 5'6"
Bathroom	2180mm x 1980mm	7'2" x 6'6"

