



Thackray House Moor Park, Beckwithshaw Harrogate

Guide Price £1,685,000



MYRINGS



Thackray House Moor Park

Beckwithshaw, Harrogate

Set within the tranquil village of Beckwithshaw, this exceptional detached barn conversion combines cutting edge contemporary design with timeless rural charm. Beautifully presented and meticulously modernised, the property offers sophisticated living in a peaceful countryside setting.

Council Tax band: G

Tenure: Freehold

- BESPOKE DETACHED COUNTRY HOME
- BEAUTIFULLY PRESENTED AND FULLY MODERNISED THROUGHOUT
- IMPRESSIVE PRINCIPAL SUITE WITH VAULTED CEILING & DRESSING AREA
- LARGE REAR GARDEN & PRIVATE WOODLAND COPSE
- DOUBLE GARAGE WITH HORMANN ELECTRIC TIMBER DOOR
- APPROXIMATELY 3.5 MILES FROM HARROGATE TOWN CENTRE



MYRINGS



Moor Park, Beckwithshaw, Harrogate, HG3

Approximate Area = 2384 sq ft / 221.4 sq m

Garage = 347 sq ft / 32.2 sq m

Total = 2731 sq ft / 253.6 sq m

For identification only - Not to scale

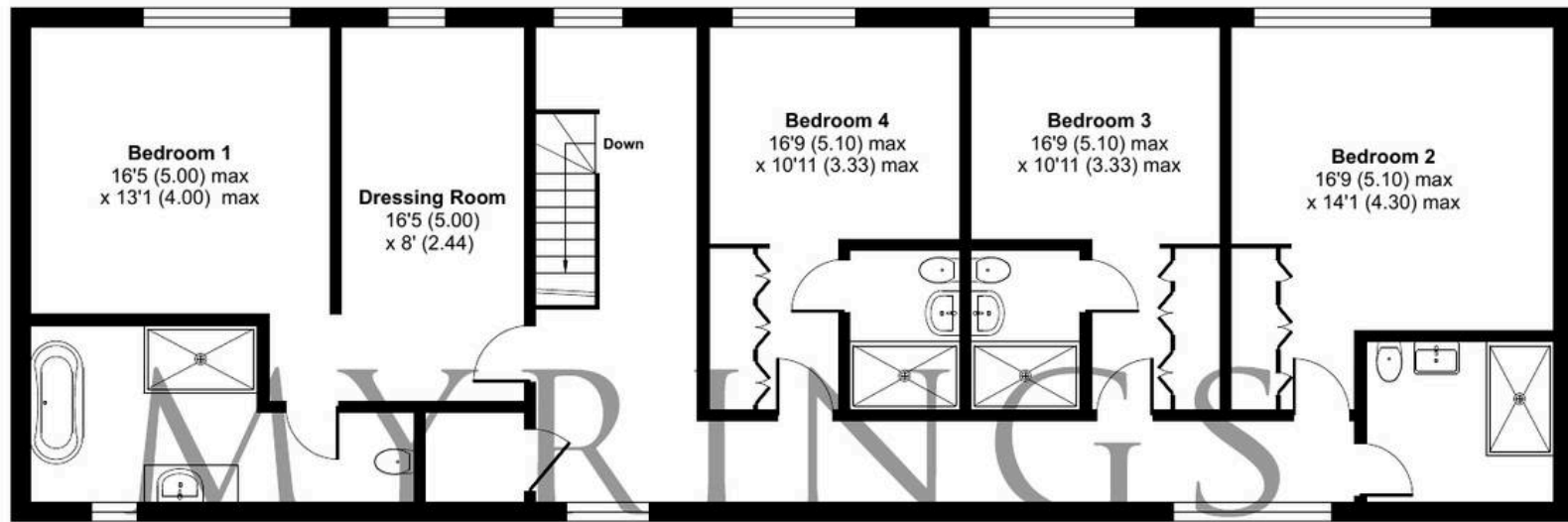

FIRST FLOOR

Harrogate's Number 1 Family Estate Agent

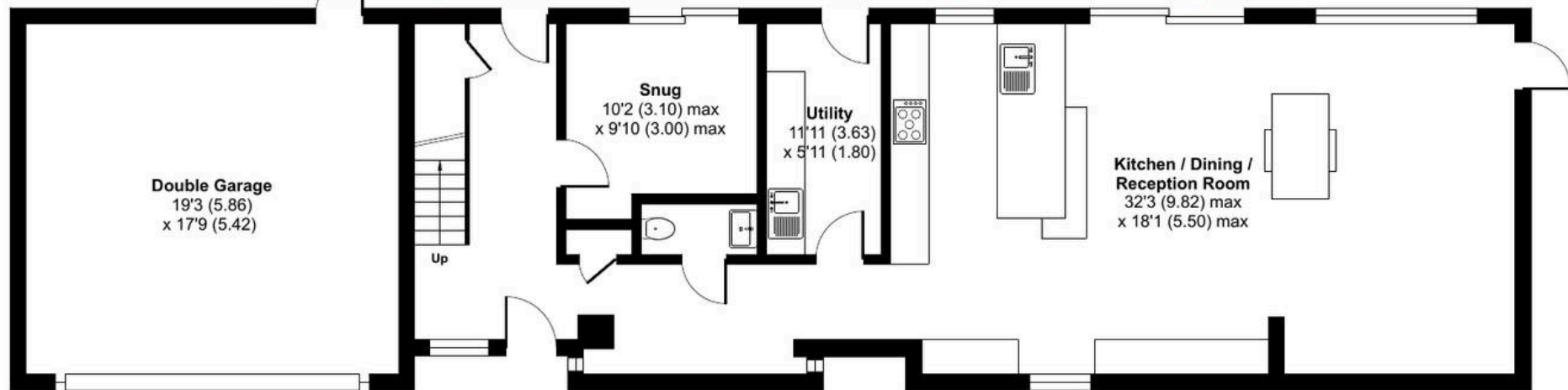

GROUND FLOOR



Floor plan produced in accordance with RICS Property Measurement 2nd Edition, Incorporating International Property Measurement Standards (IPMS2 Residential). © nichecom 2025. Produced for Myrings. REF: 1361898





Myrings Estate Agents

Myrings Estate Agents Ltd, 10 Princes Square - HG1 1LX

01423

566400

▪ enquiries@myringsestateagents.com ▪ <http://myringsestateagents.com/>

