



LESLEY
GREAVES
estate & letting agents



LESLEY
GREAVES
estate & letting agents



LESLEY
GREAVES
estate & letting agents

£210,000-£220,000

GUIDE PRICE

ARTHUR CRESCENT
CARLTON

- THREE BEDROOMS
- MODERN KITCHEN
- FOUR PIECE BATHROOM
- LARGE GARDEN
- DRIVEWAY
- CLOSE TO AMENITIES
- EPC D



LESLEY
GREAVES
estate & letting agents



LESLEY
GREAVES
estate & letting agents



LESLEY
GREAVES
estate & letting agents

Spacious Three-Bedroom Home

THIS SPACIOUS THREE-BEDROOM MID-TERRACED HOME OFFERS CONVENIENT ACCESS TO A VARIETY OF LOCAL AMENITIES, WELL-REGARDED SCHOOLS AND EXCELLENT TRANSPORT LINKS.

THE GROUND FLOOR FEATURES AN INVITING ENTRANCE HALL, A SPACIOUS LIVING ROOM AND A MODERN FITTED KITCHEN COMPLETE WITH A RANGE OF INTEGRATED APPLIANCES. A PRACTICAL REAR HALLWAY PROVIDES ACCESS TO THE GARDEN, ADDING TO THE HOME'S FUNCTIONALITY.

UPSTAIRS, THERE ARE TWO GENEROUSLY SIZED DOUBLE BEDROOMS, A COMFORTABLE SINGLE BEDROOM, AND A STYLISH FOUR-PIECE FAMILY BATHROOM COMPLETE WITH BOTH A BATH AND A SEPARATE SHOWER.

OUTSIDE, THE PROPERTY BENEFITS FROM A DRIVEWAY TO THE FRONT, PROVIDING OFF-ROAD PARKING. TO THE REAR IS A LARGE, SOUTH-FACING GARDEN PERFECT FOR OUTDOOR LIVING WITH A PAVED PATIO AND A RAISED DECKED SEATING AREA IDEAL FOR RELAXING OR ENTERTAINING.

- FREEHOLD
- COUNCIL TAX; BAND A
- LOCAL AUTHORITY; GEDLING BOROUGH COUNCIL
- MEASUREMENTS; 89 SQ METERS

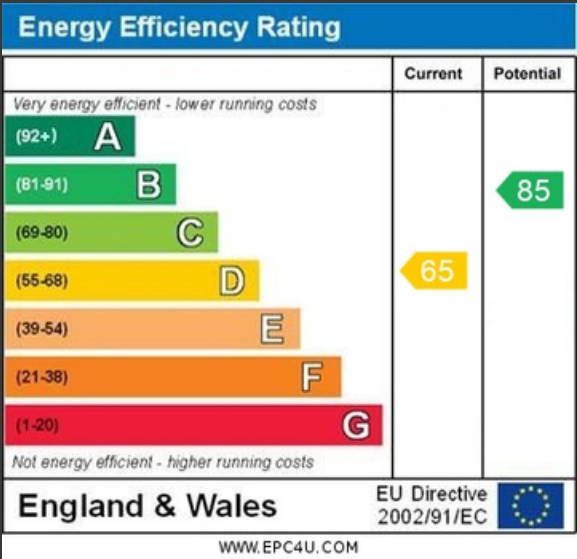



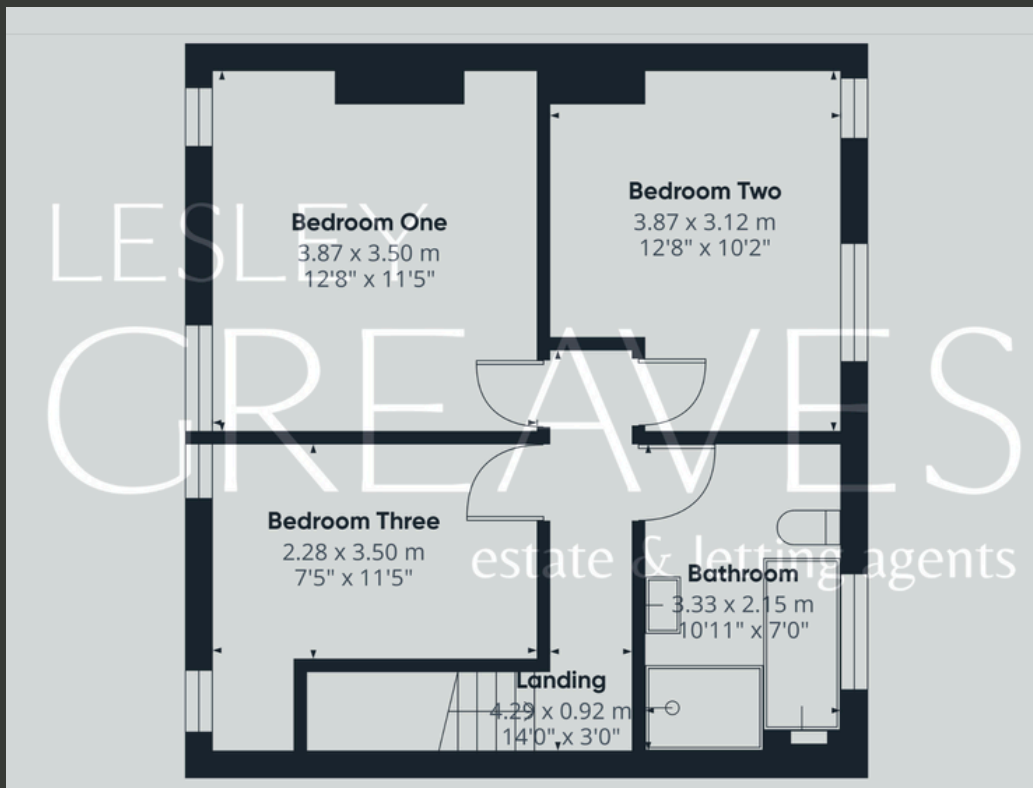
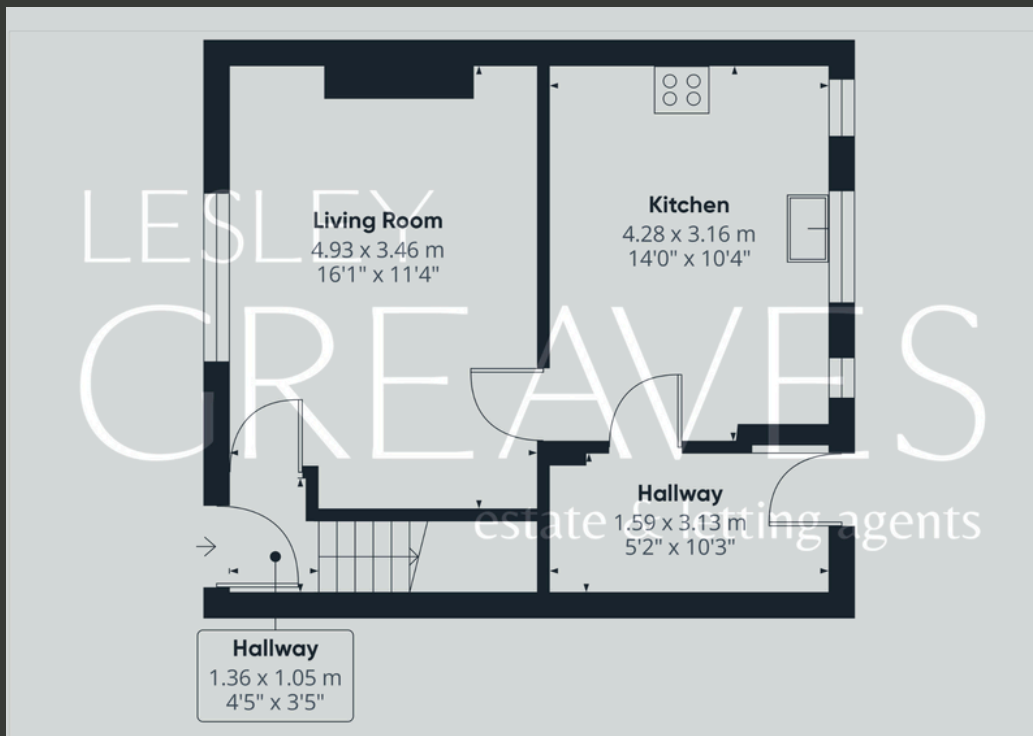

Agent's Note: These particulars have been prepared in good faith and are provided for guidance purposes only. While every effort has been made to ensure their accuracy, they should not be relied upon as exact. All measurements are approximate, and floor plans are for illustrative purposes only. Prospective buyers or tenants are advised to verify all details independently, conduct their own due diligence, and note that services, systems, and appliances have not been tested.

Lesley Greaves Estate & Lettings Agents

22 Main Road ,Gedling, Nottingham, NG4 3HP

0115 987 7337

sales@lesleygreaves.co.uk