



## 83 West Road, London – E15 3PX

£750,000 Freehold

Fully extended and refurbished Victorian terrace • Five bedrooms, two bathrooms across three floors • Spacious modern kitchen with direct garden access • Bright bay-fronted reception and separate dining area • Loft conversion providing two versatile bedrooms • Private low-maintenance garden with patio area • Over 1,450 sq ft of internal living space • Offered chain free and ready to move in • Located close to West Ham Park and Stratford amenities • Excellent transport links via Plaistow and Stratford stations



**HIGHCASTLE  
ESTATES**

**020 3026 4420**  
**sales@hceuk.com**



Beautifully extended and fully refurbished five-bedroom Victorian home in the heart of Stratford, E15. Offering over 1,450 sq ft of stylish living space with two bathrooms, a loft conversion, and a private garden—perfect for modern family life. Offered chain free.  
Council Tax band: C

Tenure: Freehold

EPC Energy Efficiency Rating: D

EPC Environmental Impact Rating: E



- Fully extended and refurbished Victorian terrace
- Five bedrooms, two bathrooms across three floors
- Spacious modern kitchen with direct garden access
- Bright bay-fronted reception and separate dining area
- Loft conversion providing two versatile bedrooms
- Private low-maintenance garden with patio area
- Over 1,450 sq ft of internal living space
- Offered chain free and ready to move in
- Located close to West Ham Park









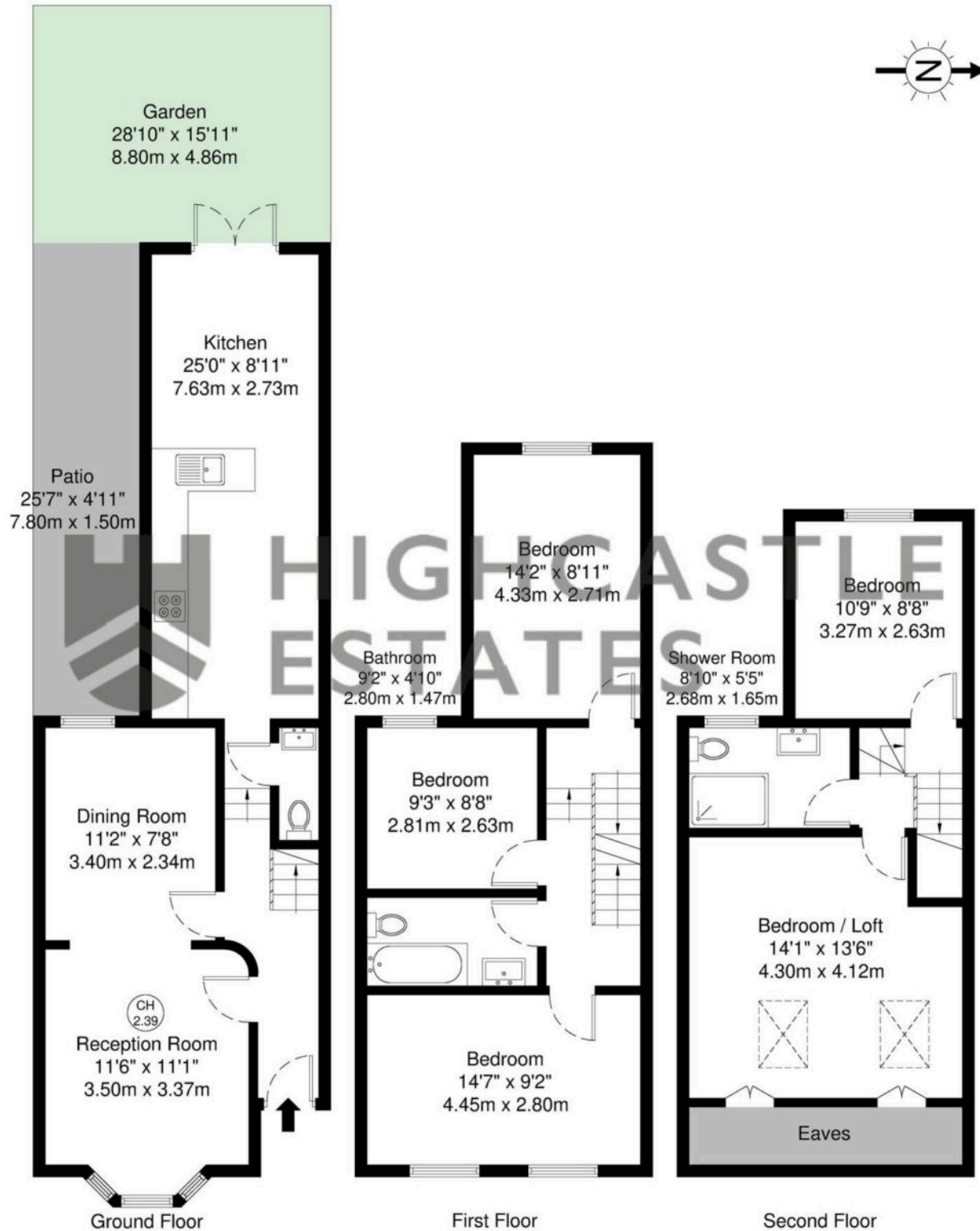

GROSS INTERNAL AREA (GIA)  
The footprint of the property  
135.5 sq m / 1458 sq ft

TOTAL STORAGE SPACE  
Storage and wardrobe total area  
0.0 sq m / 0.0 sq ft

EXTERNAL FEATURES  
Garden, Balcony, Terrace, Verandah etc.  
54.4 sq m / 585 sq ft

RESTRICTED HEAD HEIGHT  
Limited use area under 1.5m  
0.0 sq m / 0.0 sq ft

Disclaimer : Floorplan measurements are approximate and are for illustrative purposes only. While we do not doubt the floorplan accuracy and completeness, you or your advisors should conduct a careful, independent investigation of the property in respect of monetary valuation.

**Maison  
VUE**

You can include any text here. The text can be modified upon generating your brochure.