



Cherry Hinton Road, Cambridge

+44 (0) 1223 508050

lettings@cookecurtis.co.uk

www.cookecurtis.co.uk

A two-bedroom, one-bathroom, newly re-decorated fully furnished apartment located at Cambridge Leisure Park with allocated parking. Providing excellent access to Addenbrookes and Cambridge City Centre.

£1,980 pcm

Cherry Hinton Road,
Cambridge, CB1 7DZ



A fully furnished, two-bedroom apartment with one bathroom available in an excellent location in Central Cambridge, within walking distance of Cambridge train station.

Furnished as per the photographs including kitchen utensils, hair dryer and an iron. The kitchen is supplied with fridge/freezer, washer/dryer, dishwasher, hob and oven and small appliances. Linens provided on arrival.

Tenancy available for a minimum of 6 months.

Deposit is equivalent to one months rent. Utility bills are in addition to the monthly rent.

Please contact us for further information. There are several properties available and photos/floorplans may differ slightly.

Available 24th November 2025.

Please refer to the 'Tenant Guide' brochure, for more information regarding the tenancy application process, referencing, terms and conditions of the holding fee and payments due before the start of the tenancy.



Market Rise is a building located at the top of Cherry Hinton Road in the southern edge of the city centre. Convenient for commuters as it sits only 0.5miles from Cambridge Train Station with regular trains to London taking under an hour to reach the capital. Addenbrooke's Hospital and the





54 sqm / 589 sqft

2 bed, 1 recep, 1 bath

Council tax - C

EPC - C / 77

Gas central heating

Allocated parking

Min 3 month tenancy

Available 30th December

Market Rise

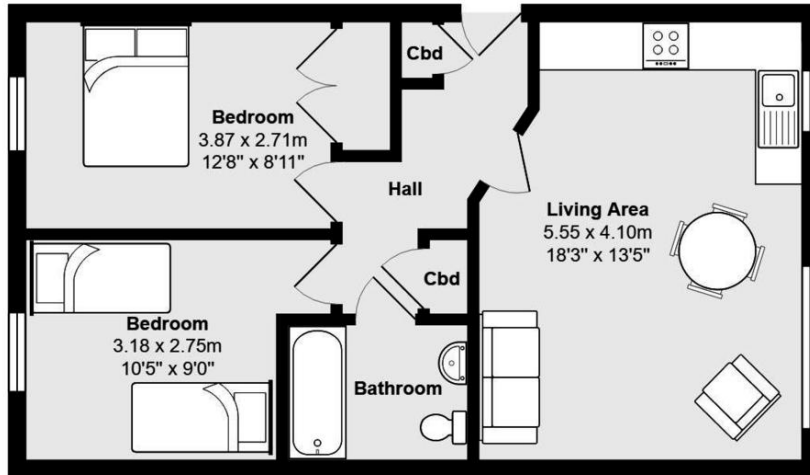

Total Area: 54.7 m² ... 589 ft²

All measurements are approximate and for display purposes only

Plan prepared by: charlesjharrison.co.uk

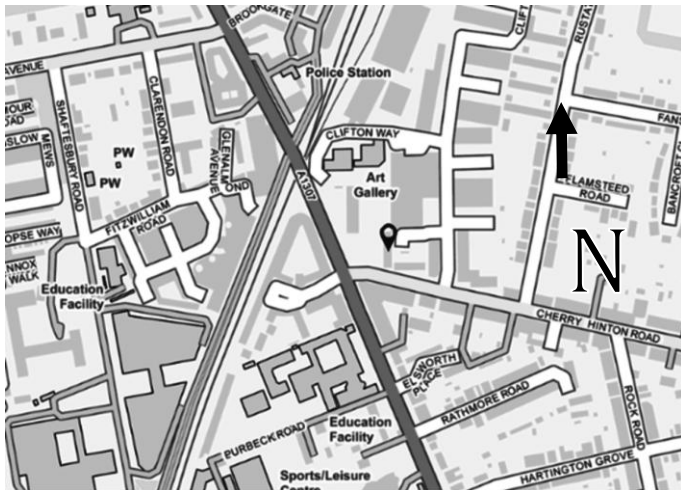

Market Rise is a building located at the top of Cherry Hinton Road in the southern edge of the city centre. Convenient for commuters as it sits only 0.5 miles from Cambridge Train Station with regular trains to London taking under an hour to reach the capital. Addenbrooke's Hospital and the Biomedical Campus is 1 mile away and there is access out to junction 11 of the M11 approx. 3 miles away. There is an excellent range of facilities in the locality, including banks, lunch time eateries, a post office and small supermarkets along with the cinema and leisure complex adjacent to the building. There are also several public houses and restaurants on the near by Hills Road.

COOKE
CURTIS
& CO