



29 Manor Road, Holbury SO45 2NQ
£262,500

ANTHONY JAMES
PROPERTIES



29 Manor Road

Holbury, Southampton

This charming three-bedroom end terrace house located in Holbury arrives on the market with no onward chain.

Gas-fired central heating and double glazing throughout. Kitchen/breakfast room, spacious living room with beautiful wood flooring. Living room and conservatory which adds extra living space. Upstairs. Three bedrooms, family bathroom, and convenient loft access from the landing.

Outside, the low-maintenance rear garden with bonus of rear access to parking and a garage.

Front garden that offers the potential to be converted into additional driveway parking (subject to planning).

Council Tax band: B

Tenure: Freehold



1 Southward House
Dibden Purlieu SO45 4PT



T: 02380 844405
info@anthonyjamesproperties.co.uk



GROUND FLOOR
441 sq.ft. (41.0 sq.m.) approx.

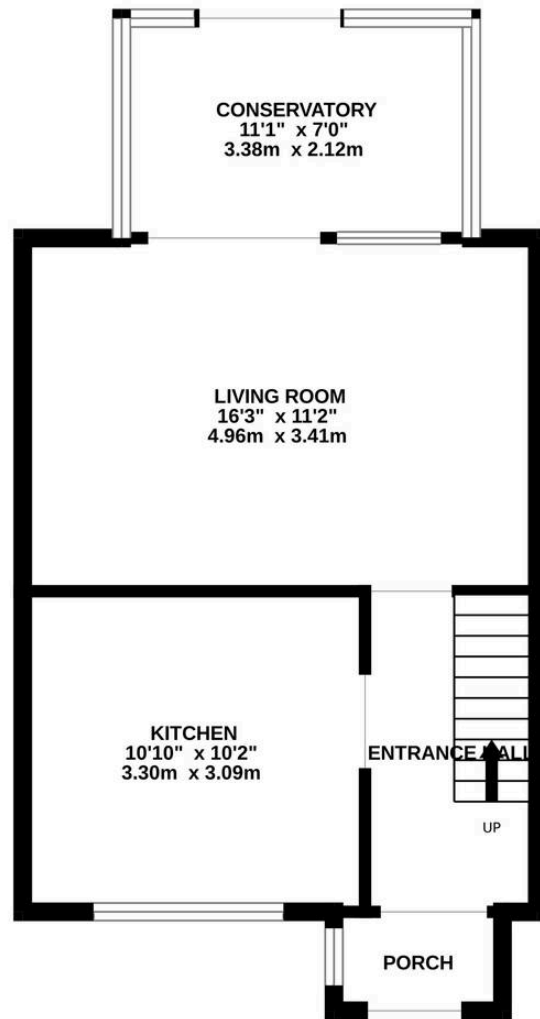

1ST FLOOR
347 sq.ft. (32.3 sq.m.) approx.

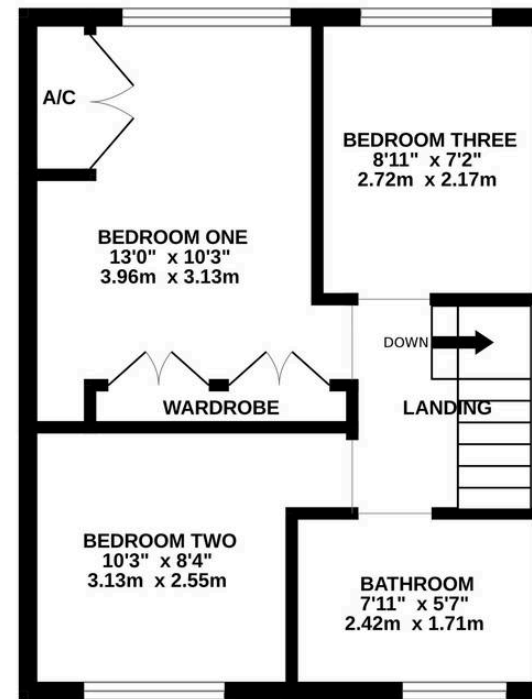

TOTAL FLOOR AREA : 789 sq.ft. (73.3 sq.m.) approx.

Whilst every attempt has been made to ensure the accuracy of the floorplan contained here, measurements of doors, windows, rooms and any other items are approximate and no responsibility is taken for any error, omission or mis-statement. This plan is for illustrative purposes only and should be used as such by any prospective purchaser. The services, systems and appliances shown have not been tested and no guarantee as to their operability or efficiency can be given.
Made with Metropix ©2025