



Lodge Farm Close, Weston Turville  
£950,000





## Lodge Farm Close

### Weston Turville

- Set in Approx 1/4 Acre
- Five Bedrooms
- Sitting Room & Large Dining Hall
- Family Room and Home Office/Study
- Shower Room and En-suite Shower Room
- Superb Kitchen/Breakfast Room
- Double Garage with Electric Doors
- Large Gated Driveway

Weston Turville is an attractive village conveniently located between Aylesbury and Wendover with a bus route linking both. There is a combined infant and junior school, small parade of shops, well attended church, three pubs/restaurants, a golf club and a village hall. There are many opportunities for recreation close to the village including Wendover Woods and Coombe Hill and most sports are available in the Aylesbury Vale. Road access to London could either be via the A413 and M40 or the A41 and M1 and the neighbouring village of Wendover has a railway station which is on the Chilterns Railway Line providing commuter services to Marylebone in 45-50 minutes. It also offers good day to day shopping facilities and has a regular weekly market on Thursdays, Health Centre, Dentists, Library. The renowned Grammar School and High Schools are in Aylesbury together with the Sir Henry Floyd co-ed Grammar School.





# Lodge Farm Close

Weston Turville

Discover this impressive 5-bedroom detached home set within approximately 1/4 acre, offering generous space and a desirable location. A large dining hall creates a welcoming entrance, complemented by a cosy family room, triple-aspect sitting room overlooking the garden, and a practical home office/study.

Upstairs, five well-sized bedrooms provide excellent family or guest accommodation. The standout main bedroom features double-aspect views and built-in furniture, while the property also benefits from a shower room, an en-suite, and a ground-floor cloakroom, all finished with modern fittings.

The superb kitchen/breakfast room is ideal for everyday living and entertaining, complete with bi-fold doors to the patio. A separate utility room offers direct access to the driveway and double garage, which features electric doors. A large gated driveway provides ample parking for residents and visitors.

Recent upgrades include new double glazing throughout, enhancing comfort and energy efficiency. This spacious and versatile home presents a fantastic opportunity for families—viewing is highly recommended.

Council Tax band: G

Tenure: Freehold

EPC Energy Efficiency Rating: C



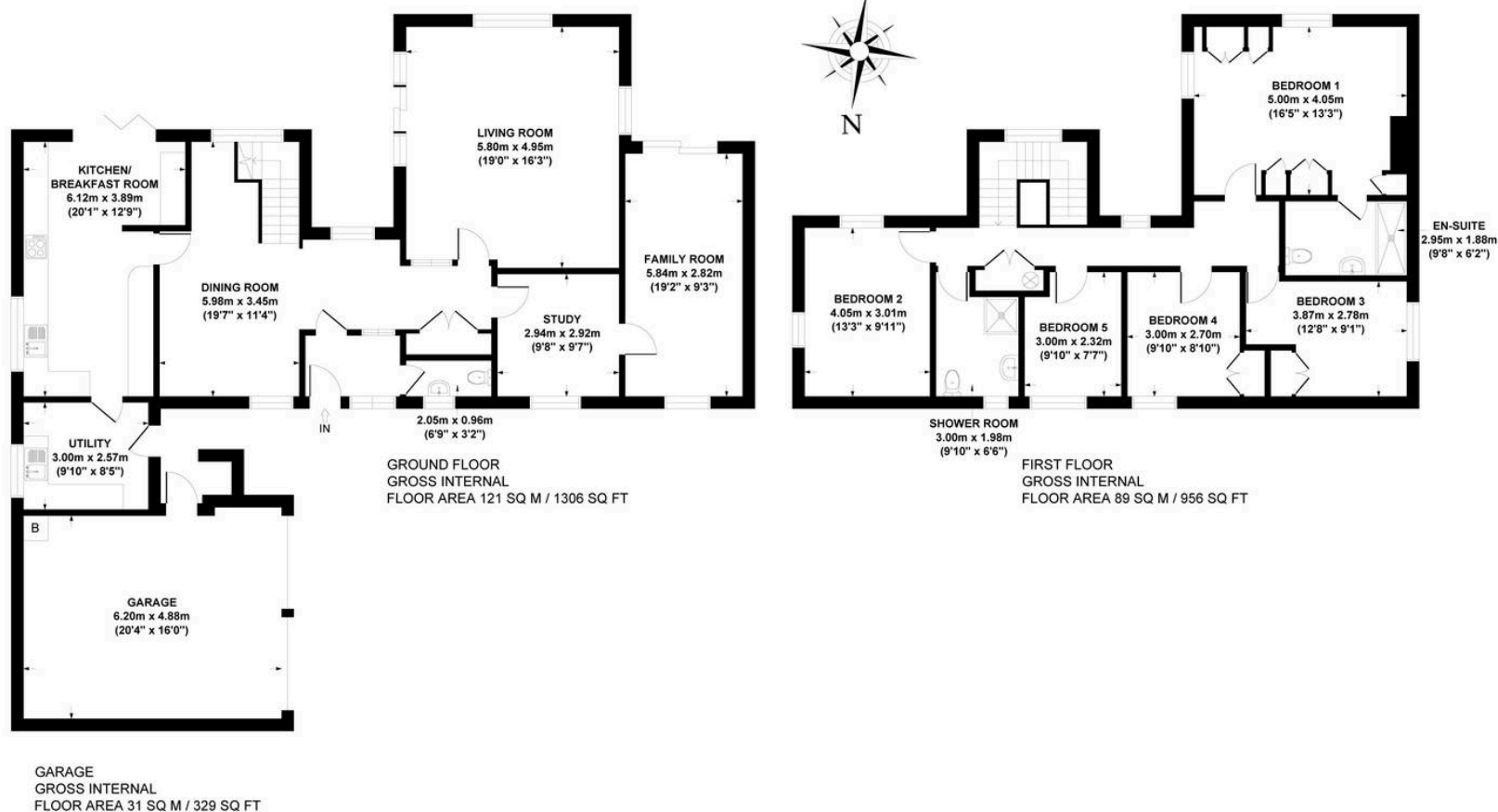

**LODGE FARM CLOSE, WESTON TURVILLE, HP22 5TH**  
**APPROX. GROSS INTERNAL FLOOR AREA 241 SQ M / 2591 SQ FT**  
**(INCLUDING GARAGE)**  
 FLOOR PLAN IDENTIFICATION PURPOSES ONLY -NOT TO SCALE

# Tim Russ and Company

Tim Russ & Co, 4 Chiltern Court Back Street - HP22 6EP

01296 621177 • wendover@timruss.co.uk • timruss.co.uk/

By law we must verify every seller and buyer for anti-money laundering purposes.  
 Checks are carried out by our partners at Lifetime Legal for a non-refundable £60 (incl. VAT) fee, paid directly to them.  
 For more information please visit our website.



Particulars described on our website and in marketing materials are for indicative purposes only; their complete accuracy cannot be guaranteed. Details such as boundary lines, rights of way, or property condition should not be treated as fact. Interested parties are advised to consult their own surveyor, solicitor, or other professional before committing to any expenditure or legal obligations.