



Hooper Street, Cambridge

+44 (0) 1223 508050

[lettings@cookecurtis.co.uk](mailto:lettings@cookecurtis.co.uk)

[www.cookecurtis.co.uk](http://www.cookecurtis.co.uk)



Fully furnished one-bedroom apartment on Hooper Street offers a cosy living area and the convenience of on-site parking. Ideally located a mile from Cambridge City Centre, with a pleasant walk through the green space of Parker's Piece.

£1,480 pcm

Hooper Street, Cambridge,  
CB1 2NZ





This charming apartment is just a short stroll from the city train station. Ideal for up to two occupants, it features a cosy living space, on-site parking, and secure bike storage, making it easy to enjoy the best of Cambridge and beyond.

The photos accurately depict the present furnishings within the apartment, including kitchen utensils, hairdryer, iron and ironing board.

Tenancy available for a minimum of 3 months.

Utility bills are in addition to monthly rent.

Available 26th November

UK Power networks suggest the electricity and gas is currently supplied by: EDF

Ofcom suggests the maximum broadband speed is: 1000 mbps

Gov.uk suggests the property is a medium to very low flood risk.

The apartment is set within a small, private development on Hooper Street, just a short walk from city centre train station and a delightful selection of independent shops along Mill Road, all within easy walking distance.

A fifteen minute walk through the green space of Parker's Piece brings you to Cambridge city centre, while the train station is just a five minute walk away, offering easy connections beyond the city.











31sqm / 338sqft

---

1 bed, 1 bath, 1 recep

---

EPC - C / 73

---

Council tax band - B

---

Gas central heating

---

Allocated parking

---

Fully furnished

---

Available December 2025

---





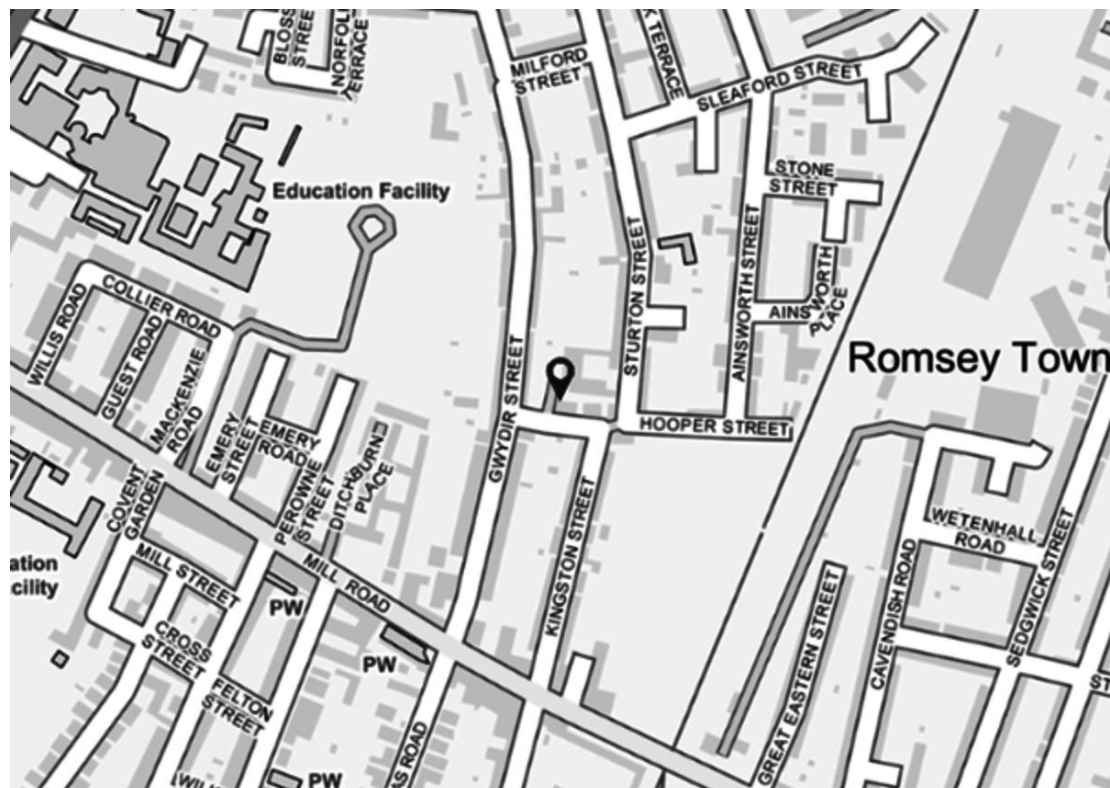



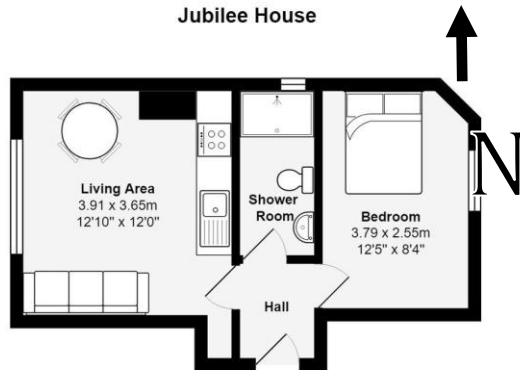

Total Area: 31.4 m<sup>2</sup> ... 338 ft<sup>2</sup>

All measurements are approximate and for display purposes only

Plan prepared by: Charlesjharrison.co.uk

Hooper Street is a particularly desirable neighbourhood in the highly regarded Petersfield wards. It is conveniently situated between East Road and Mill Road, around half a mile east of the City Centre with its combination of ancient and modern buildings, winding lanes, excellent choice of schools and wide range of shopping facilities. The property is a 12 minute walk from Cambridge Railway Station with direct links to London. Mill Road, The Grafton, Beehive Shopping Centres and Cambridge Retail Park are also a short walk away. The city centre is reached by foot in just 20 minutes. Schooling is excellent and the area falls within the catchment of St Matthews Primary School, secondary provision is at Parkside Community College both of which are Ofsted rated as outstanding.



COOKE  
CURTIS  
& CO