

Kennet Close   Wellingborough

richard james

www.richardjames.net

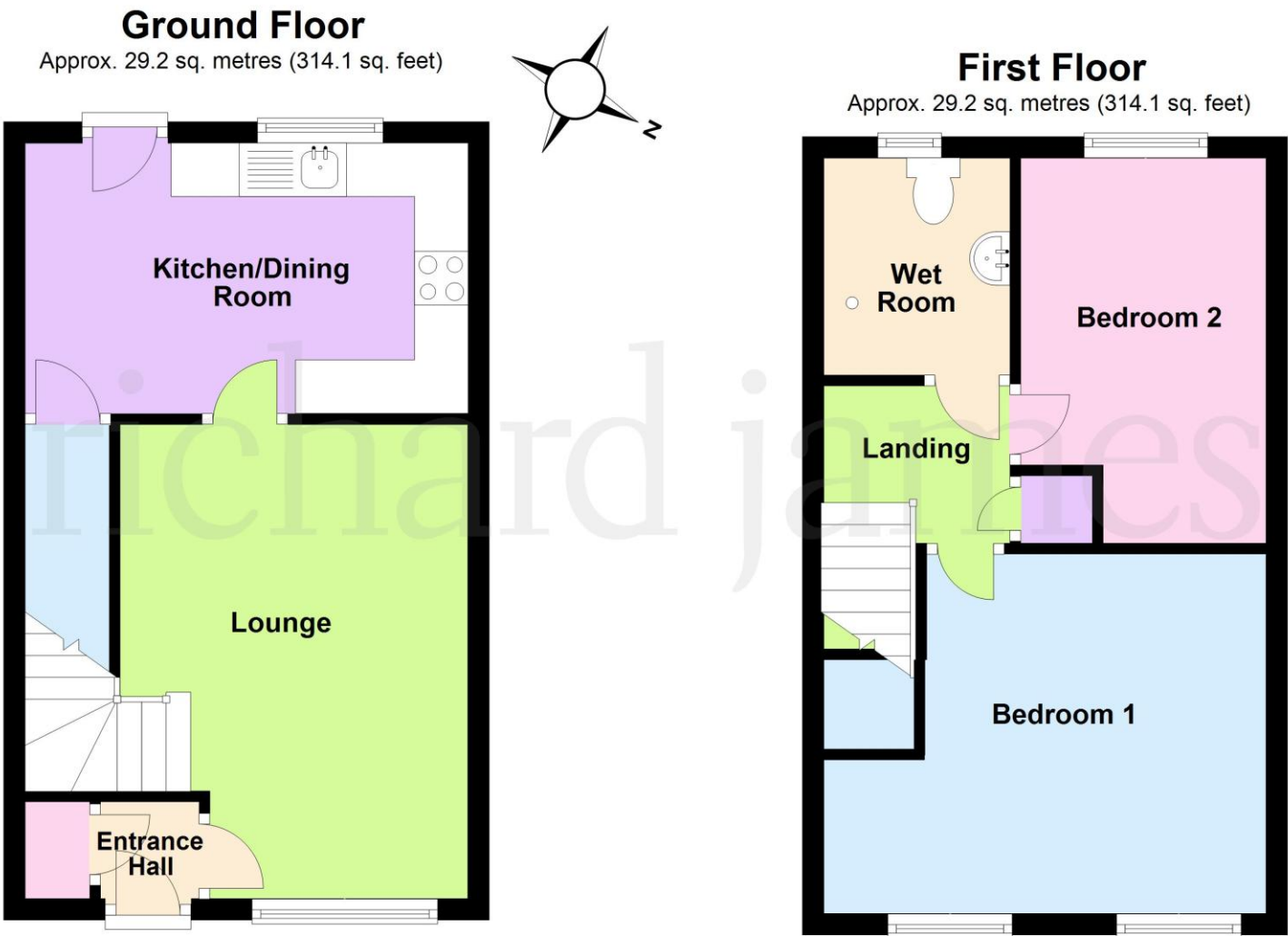

Total area: approx. 58.4 sq. metres (628.2 sq. feet)



Kennet Close Wellingborough NN8 5ZP

Freehold Price £200,000

The information given in these particulars is intended to help you decide whether you wish to view this property and to avoid wasting your time in viewing unsuitable properties. We have tried to make sure that these particulars are accurate, but to a large extent we have to rely on what the seller tells us about the property. We do not check every single piece of information ourselves as the cost of doing so would be prohibitive and we do not wish to unnecessarily add to the cost of moving house. Once you find the property you want to buy, you will need to carry out more investigations into the property than it is practical or reasonable for an estate agent to do when preparing sales particulars. For example, we have not carried out any kind of survey of the property to look for structural defects and would advise any homebuyer to obtain a surveyors report before exchanging contracts. If you do not have your own surveyor, we would be pleased to recommend one. We have not checked whether any equipment in the property (such as central heating) is in working order and would advise homebuyers to check this. You should also instruct a solicitor to investigate all legal matters relating to the property (e.g. title, planning permission etc) as these are specialist matters in which estate agents are not qualified. Your solicitor will also agree with the seller what items (e.g. carpets, curtains etc) will be included in the sale.

Wellingborough Office

27 Sheep Street Wellingborough  
Northants NN8 1BS  
01933 224400

Irthlingborough Office

28 High Street Irthlingborough  
Northants NN9 5TN  
01933 651010

Rushden Office

74 High Street Rushden  
Northants NN10 0PQ  
01933 480480





A vacant two bedroom terrace house situated just off Medway Drive that benefits from uPVC double glazed doors and windows, gas radiator central heating and built in kitchen appliances. The property offers a single garage and the bathroom has been adapted to a wet room. The accommodation briefly comprises entrance hall, lounge, kitchen/dining room, two bedrooms, wet room, gardens to front and rear and a garage.

Enter via obscured glazed entrance door to.

**Entrance Hall**

Built in cupboard, door to.

**Lounge**

14' 8" x 10' 7" up to stairs (4.47m x 3.23m)

Window to front aspect, two radiators, T.V. point, stairs to first floor landing, door to.

**Kitchen/Dining Room**

13' 4" x 8' 2" (4.06m x 2.49m) (This measurement includes area occupied by the kitchen units)

Comprising single drainer stainless steel unit with cupboards under, mixer tap, range of base and eye level units providing work surfaces, tiled splash area, built in electric oven, gas hob with extractor hood over, plumbing for washing machine, space for fridge, radiator, gas fired boiler serving central heating and domestic hot water, understairs storage cupboard, window to rear aspect, obscure glazed door to rear garden.

**First Floor Landing**

Access to loft space, built in linen cupboard, doors to.

**Bedroom One**

13' 5" narrowing to 10' 4" x 11' 1" max (4.09m x 3.38m)

Two windows to front aspect, radiator.

**Bedroom Two**

11' 11" narrowing to 9' 7" x 7' 3" (3.63m x 2.21m)

Window to rear aspect, radiator.

**Wet Room**

Comprising fitted shower, pedestal hand wash basin, low flush W.C, tiled splash areas, radiator, electric extractor vent, obscure glazed window to rear aspect.

**Outside**

Front - Lawn, open canopy porch.

Rear - Patio, lawn, shrubs and plants, wooden fence gated rear access, tap, light.

Garage - Situated to left of terrace, metal up and over door driveway for one car, further piece of lawn garden to left of driveway.

**Energy Performance Rating**

This property has an energy rating of C. The full Energy Performance Certificate is available upon request.

**Council Tax**

We understand the council tax is band B (£1,749 per annum. Charges for 2025/2026).

**Agents Note**

Please be aware that some photographs used in our particulars are obtained using a wide-angle lens.

**Conveyancing**

We are able to offer a free quotation for your conveyancing from a panel of local solicitors or licensed conveyancers.

**Offers**

For offers to be submitted in the best light, the majority of vendors require us to confirm buyers have been financially qualified. We will require a Mortgage Certificate or Agreement In Principle (A.I.P.) and proof of deposit or cash. This information will be treated confidentially and will not be seen by any other party. We are obliged by law to pass on all offers to the vendors until contracts have been exchanged.

**Money Laundering Regulations 2017 & Proceeds of Crime Act 2002**

In order to comply with the above Regulations, an intending purchaser will be required to provide official I.D; proof of address, evidence of funding and source of deposit clearly showing the name of the account holder. If funds are being provided by a third party i.e. family, we will require the same from them too. We will verify clients identity electronically from the details provided. The information will be checked against various databases. This is not a credit check of any kind and does not affect credit history. We will retain a record on file.

**General Data Protection Regulations 2018**

Should you view or offer on this property, we will require certain pieces of personal information in order to provide a professional service to you and our client.

The personal information provided by you may be shared with the seller, but it will not be shared with any other third parties without your consent.

More information on how we hold and process your data is available on our website - [www.richardjames.net](http://www.richardjames.net)

**Mortgages**

We are able to offer our clients mortgage advice through our association with an independent mortgage advisor. Written quotations are available on request. A life policy may be required.

**YOUR HOME MAY BE REPOSSESSED IF YOU DO NOT KEEP UP REPAYMENTS ON YOUR MORTGAGE.**

