



£160,000-£165,000

GUIDE PRICE

GLARAMARA CLOSE
NOTTINGHAM

- END TOWN HOUSE
- SPACIOUS LIVING ROOM
- TWO BEDROOMS
- ALLOCATED PARKING
- NO UPWARD CHAIN
- POPULAR LOCATION
- EPC D



Two-Bedroom End Townhouse Offered with No Upward Chain

STEP ONTO THE PROPERTY LADDER WITH THIS TWO-BEDROOM END TOWNHOUSE, OFFERED TO THE MARKET WITH NO UPWARD CHAIN, MAKING IT AN IDEAL PURCHASE FOR A VARIETY OF BUYERS. THIS PROPERTY IS SITUATED A STONE'S THROW AWAY FROM VARIOUS LOCAL AMENITIES INCLUDING THE VICTORIA EMBANKMENT AND REGULAR TRANSPORT LINKS INTO THE CITY CENTRE, THIS HOME COMBINES CONVENIENCE WITH EXCELLENT POTENTIAL.

THE GROUND FLOOR COMPRISES AN ENTRANCE HALL LEADING TO A KITCHEN AND A SPACIOUS LIVING ROOM WITH DIRECT ACCESS TO THE REAR GARDEN.

UPSTAIRS, THE PROPERTY OFFERS TWO GENEROUS BEDROOMS AND A THREE-PIECE FAMILY BATHROOM.

OUTSIDE, THE PROPERTY BENEFITS FROM AN ENCLOSED REAR GARDEN FEATURING A PATIO AREA, FENCED BOUNDARIES, SECURE GATED ACCESS AND OFF-STREET PARKING.

- FREEHOLD
- COUNCIL TAX; BAND A
- LOCAL AUTHORITY; NOTTINGHAM CITY COUNCIL
- MEASUREMENTS; 60 SQ METERS

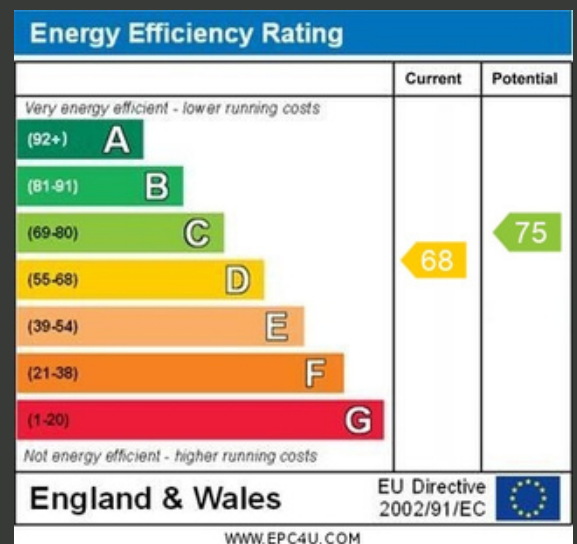



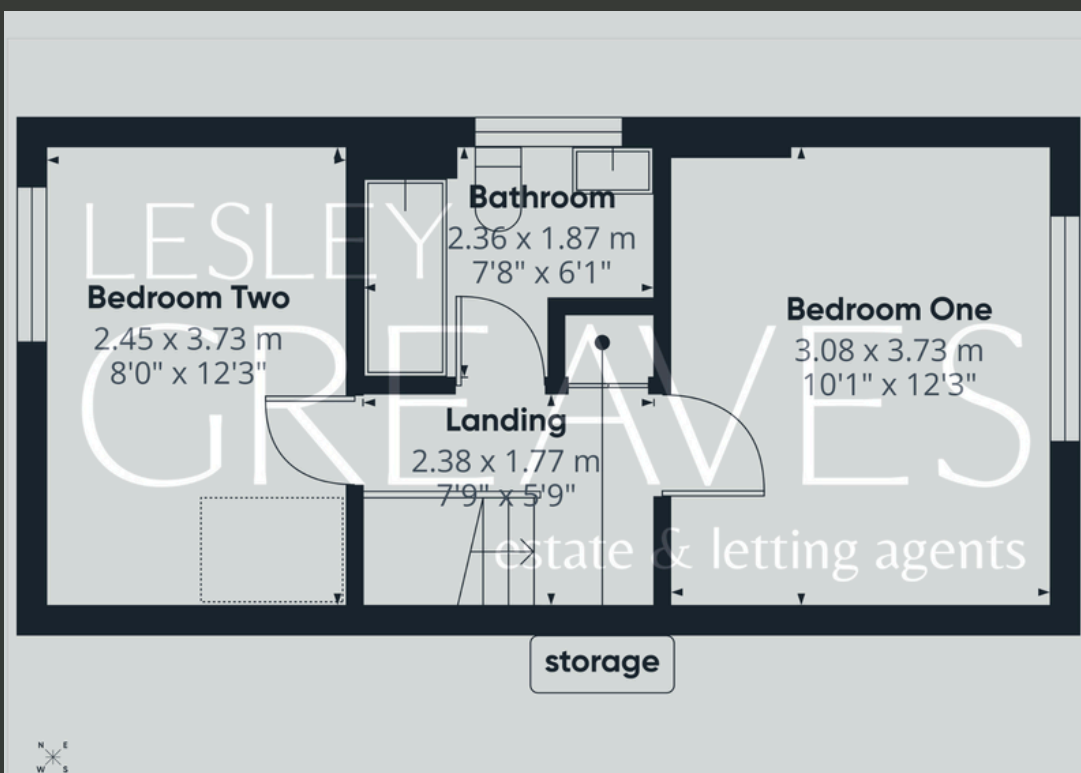

Agent's Note: These particulars have been prepared in good faith and are provided for guidance purposes only. While every effort has been made to ensure their accuracy, they should not be relied upon as exact. All measurements are approximate, and floor plans are for illustrative purposes only. Prospective buyers or tenants are advised to verify all details independently, conduct their own due diligence, and note that services, systems, and appliances have not been tested.

Lesley Greaves Estate & Lettings Agents

22 Main Road ,Gedling, Nottingham, NG4 3HP

0115 9877337

sales@lesleygreaves.co.uk