



Athena House, High Street, Horley

£280,000



**MANSELL
McTAGGART**
— Trusted since 1947 —





A selection of 24 well designed and beautifully presented 1 & 2 bedroom apartments finished to a very high specification, in the heart of Horley town centre.

The apartments have undergone extensive renovation work throughout, all finished to a very high specification. All comprise of newly installed kitchens with high end fitted appliances, refitted bathroom suites and full cosmetic refurbishments. All also include new heating systems, doors and renovated communal areas.

The development is located within the heart of Horley town centre, within close proximity of Horley station, local shops and amenities.

--

1-8 & 9-16 are the same designs (1st and 2nd floor) top floor is unique with a penthouse & quirky designs.

Lease Details

Length of Lease: 999 years

Annual Service Charge – £1,532.40

Service Charge Review Period – April

Lease details have been provided by the Vendor. This information should be confirmed by your solicitor.

- A selection of 1 & 2 bedroom apartments
- Beautifully presented throughout
- Bespoke kitchen with quartz tops and high end fitted appliances
- Stylish modern bathroom suites
- New heating systems - Lift access to all floors
- Central location - Communal parking area
- Council Tax Band 'tbc' & EPC 'C'

First Floor

Approx. 53.7 sq. metres (578.5 sq. feet)

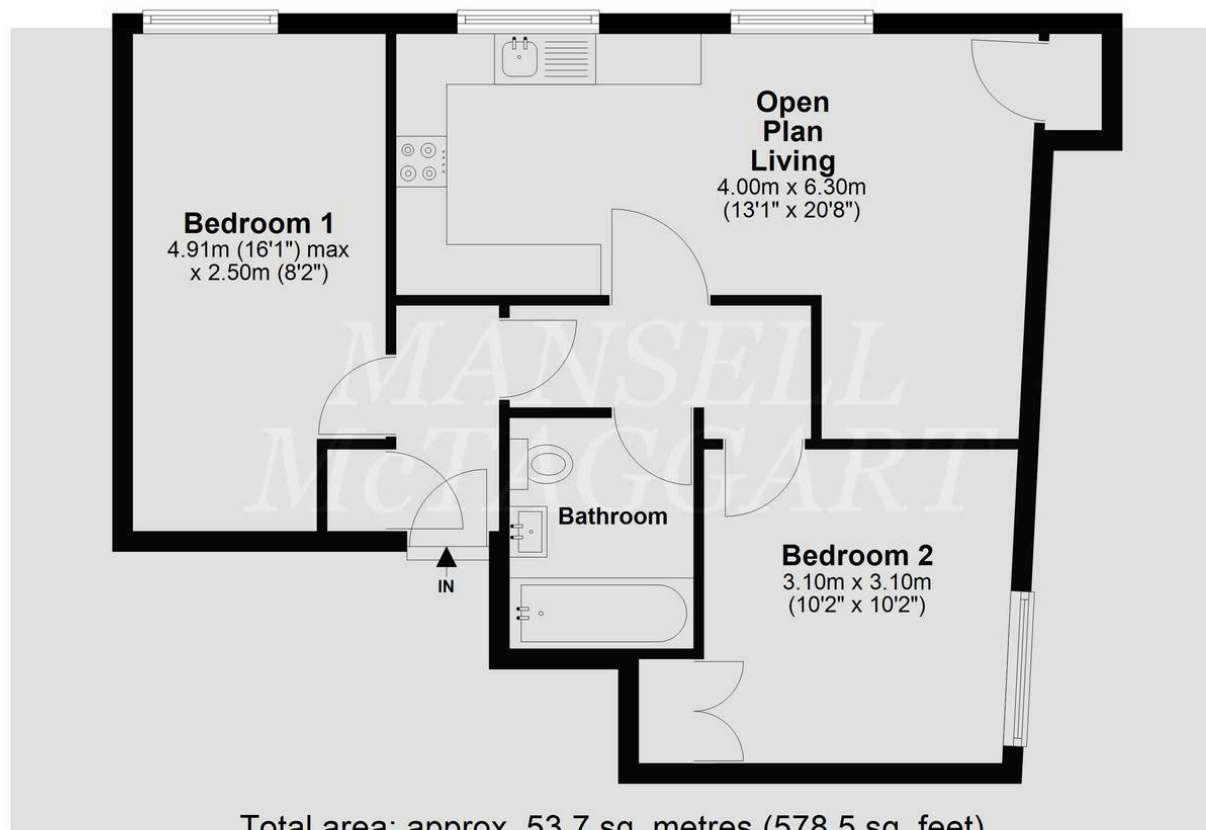

Total area: approx. 53.7 sq. metres (578.5 sq. feet)

Whilst every attempt Has been made to ensure the accuracy of the floor plan contained here, measurements of doors, windows, rooms, and any other item are approximate, and no responsibility is taken for any error, omission, or misstatement. This plan is for illustrative purposes only, and should only be used as such by any prospective buyer.

Plan produced using PlanUp.

Mansell McTaggart Horley

Mansell Mc Taggart, 3 Central Parade Massetts Road - RH6 7PP

01293 228228

horley@mansellmctaggart.co.uk

www.mansellmctaggart.co.uk/branch/horley