



**The Northfield, London Road**  
Tetbury

**£665,000**





## The Northfield, London Road

Tetbury

Presenting this OUTSTANDING ZERO CARBON ENERGY SAVING HOME, a SUBSTANTIAL 4 DOUBLE BEDROOM SEMI DETACHED HOUSE offering FLEXIBLE LIVING ACCOMMODATION OVER 3 FLOORS. Designed with contemporary family living in mind, this IMPRESSIVE property boasts a BESPOKE KITCHEN BY PETER CLINCH, complete with premium NEFF APPLIANCES, ideal for culinary enthusiasts and those who love to entertain. The principal living accommodation is conveniently located on the ground floor, featuring a light-filled open-plan space with BI-FOLD DOORS leading directly to the rear garden. Upstairs, the first and second floors provide exceptionally spacious double bedrooms, perfect for use as bedrooms, home offices, a cinema or play rooms, or even a family snug, allowing you to tailor the space to your lifestyle. The luxurious principal bedroom offers BUILT IN WARDROBE and a stylish EN-SUITE, while all bathrooms are appointed with VILLEROY & BOCH SANITARYWARE and HANSGRÖHE TAPWARE for a touch of elegance.

- ZERO CARBON ENERGY SAVING HOME WITH SOLAR PV AND AIR SOURCE HEAT PUMPS CONTRIBUTE TO PREDICTED A RATED 97 ENERGY ASSESSMENT SCORE PLUS ELECTRIC VEHICLE CHARGING POINT
- 4 DOUBLE BEDROOM SEMI DETACHED WITH FLEXIBLE LIVING
- BESPOKE KITCHEN BY PETER CLINCH WITH NEFF APPLIANCES
- BEDROOM 1 WITH BUILT IN WARDROBES AND EN-SUITE
- VILLEROY & BOSH SANITARYWARE AND HANSGRÖHE TAPWARE
- LARGE GARAGE AND 2 PARKING SPACES, SOUTH EAST FACING SPACIOUS REAR GARDEN





**Hall**

Stairs to first floor and access to understairs storage

**Living Room**

14' 4" x 9' 11" (4.36m x 3.02m)

**Kitchen/Dining**

16' 7" x 13' 3" (5.05m x 4.04m)

**Laundry****WC****Landing**

Access to airing cupboard

**Bedroom 1**

11' 11" x 13' 7" (3.64m x 4.14m)

Dimensions extend into wardrobe

**En Suite****Bedroom 4 / Study**

16' 7" x 10' 4" (5.05m x 3.14m)

**Landing****Bedroom 2**

16' 7" x 10' 8" (5.05m x 3.25m)

**Bedroom 3**

16' 7" x 10' 4" (5.05m x 3.14m)

**Bathroom**

Please note that images shown may not be of the exact external finish, handing and specification of this plot. The on site Sales Consultant(s) will be delighted to confirm plot specific finishes and finer details with you. Please note the floorplans may be in the opposite hand. As the designs maximise light and space, there may also be differences in certain window locations and positions. The on site Sales Consultant(s) will be delighted to confirm plot specific plans and layouts with you.



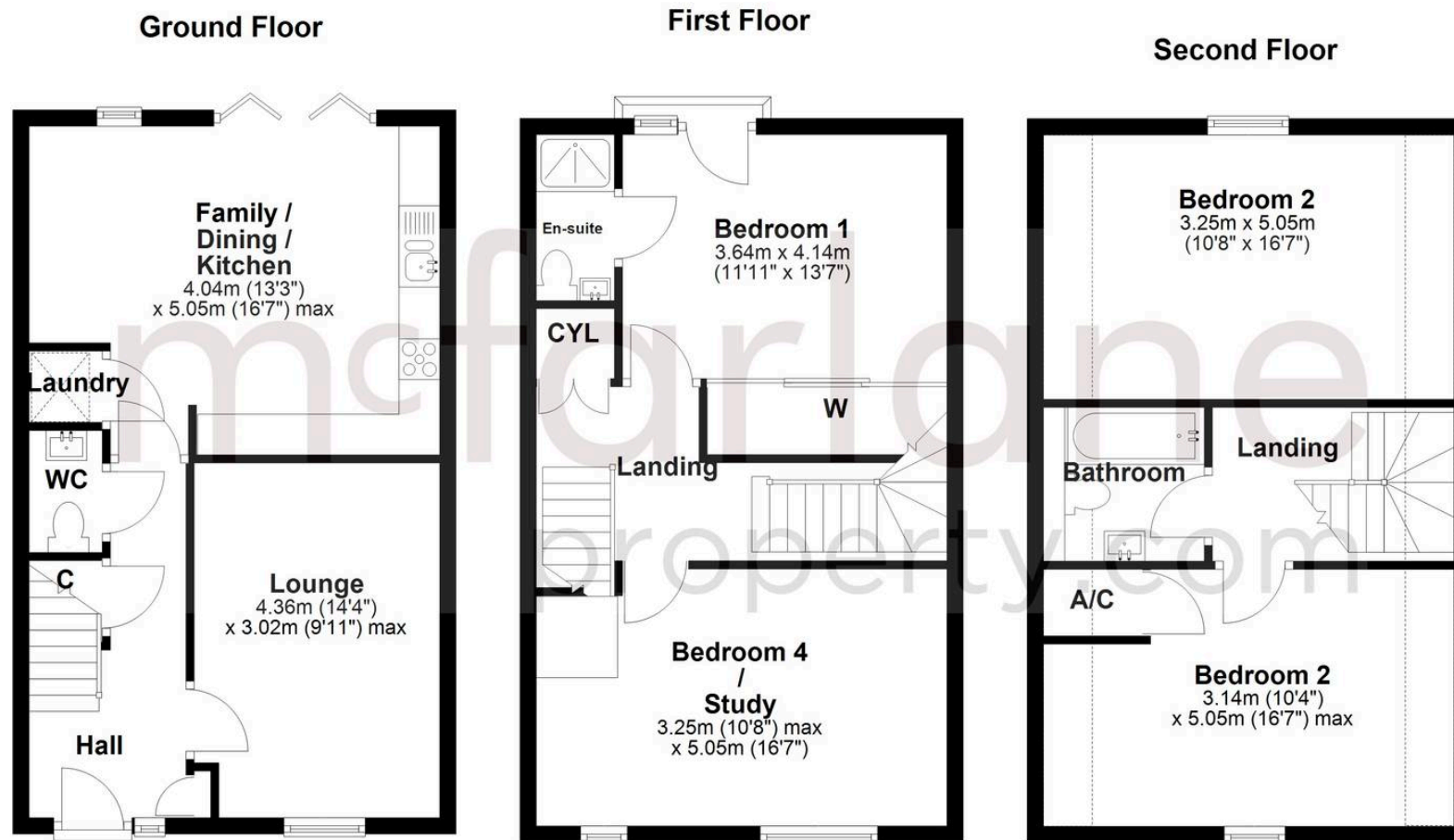

## McFarlane Sales & Lettings

Cricklade Sales 36 High Street, Cricklade - SN6 6AY

01793 751044 • [cricklade@mcfarlaneproperty.com](mailto:cricklade@mcfarlaneproperty.com) • [www.mcfarlaneproperty.com/](http://www.mcfarlaneproperty.com/)