



27 HIGHLAND CRESCENT
CRIEFF, PH7 4LH

IrvingGeddes
W.S. • Solicitors • Estate Agents

27 HIGHLAND CRESCENT, CRIEFF, PH7 4LH

Irving Geddes are delighted to offer for sale this most spacious two bedroom detached bungalow located in a highly sought after residential area of Crieff, on the western periphery of the town, bordered by open countryside. Requiring modernisation and offering huge scope to create a wonderful home.

The accommodation comprises; entrance HALL with W.C. off (with storage), central reception HALL with storage, spacious LOUNGE/DINING RM with sliding doors to rear garden, large KITCHEN, UTILITY ROOM with side door, 2 DOUBLE BEDROOMS both with built-in wardrobes, & BATHROOM with bath & separate shower. The property has gas central heating and is double glazed throughout.

No.27 sits within a good-sized gardens with a tarmac & paved driveway to the front leading to full length single garage, mature parking and area of lawn. The fully enclosed private rear is laid to lawn, with mature planting & hedge border.

A very well proportioned bungalow enjoying a prime location offering much potential for development. Early viewing advised.











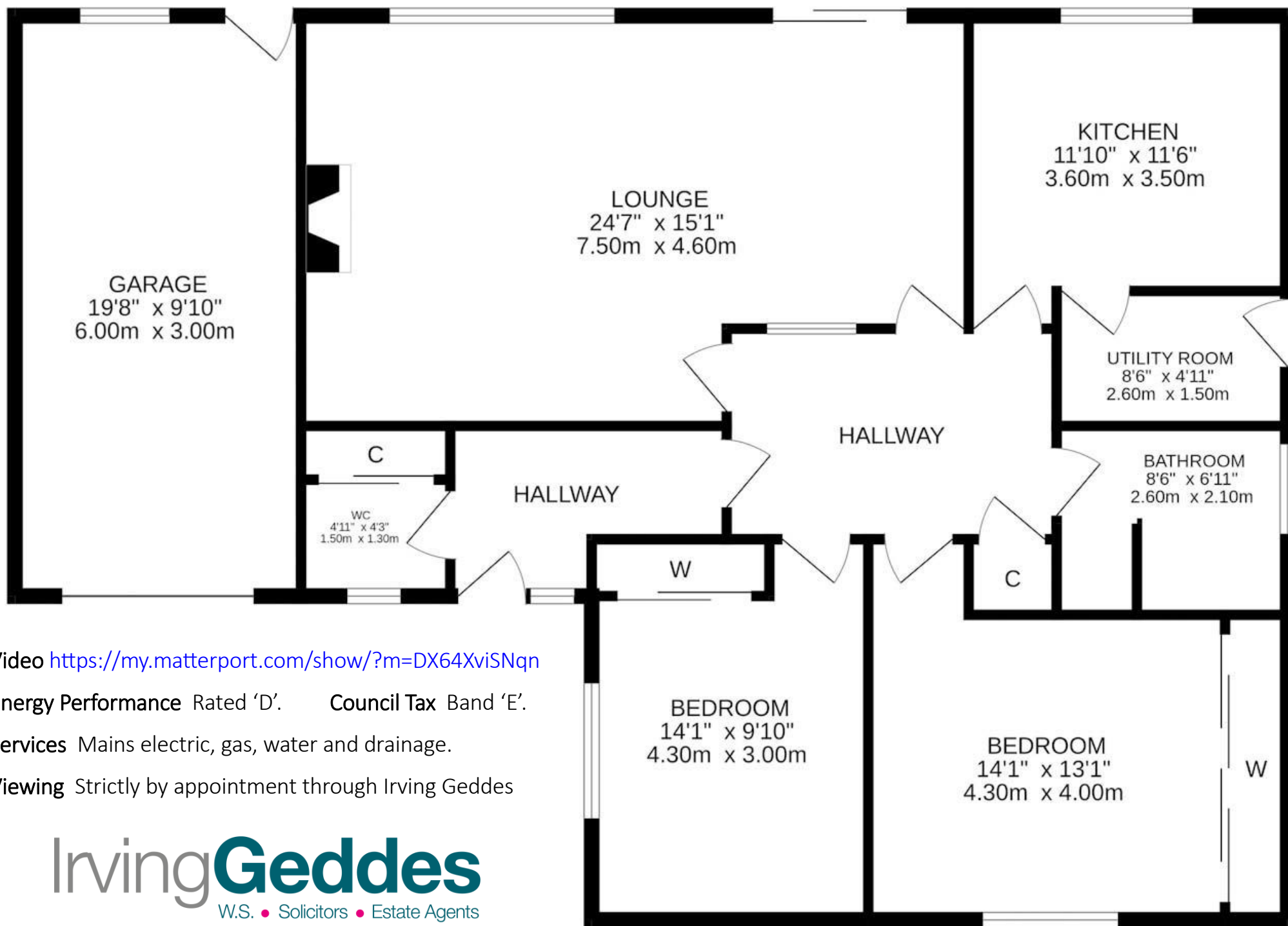

Video <https://my.matterport.com/show/?m=DX64XviSNqn>

Energy Performance Rated 'D'. Council Tax Band 'E'.

Services Mains electric, gas, water and drainage.

Viewing Strictly by appointment through Irving Geddes

IrvingGeddes
W.S. • Solicitors • Estate Agents

These particulars are believed to be correct, but their accuracy is not guaranteed and they do not form part of any contract. All measurements shown are approximate only.



Crieff

25 West High Street, PH7 4AU
Tel: 01764 653771

Crieff

14 Comrie Street, PH7 4AZ
Tel: 01764 653771

Comrie

1 Drummond Street, PH6 2DW
Tel: 01764 670325

Aberfeldy

6 The Square, PH15 2DD
Tel: 01887 822722