



The Northfield London Road
Tetbury

£625,000



The Northfield, London Road

Tetbury

Presenting this OUTSTANDING ZERO CARBON ENERGY SAVING HOME, a SUBSTANTIAL 4 DOUBLE BEDROOM END TERRACE HOUSE offering FLEXIBLE LIVING ACCOMMODATION OVER 3 FLOORS. Designed with contemporary family living in mind, this IMPRESSIVE property boasts a BESPOKE KITCHEN, complete with premium NEFF APPLIANCES, ideal for culinary enthusiasts and those who love to entertain. The principal living accommodation is conveniently located on the ground floor, featuring a light-filled open-plan space with BI-FOLD DOORS leading directly to the rear garden. Upstairs, the first and second floors provide exceptionally spacious double bedrooms, perfect for use as bedrooms, home offices, a cinema or play rooms, or even a family snug, allowing you to tailor the space to your lifestyle. The luxurious principal bedroom offers BUILT IN WARDROBE and a stylish EN-SUITE, while all bathrooms are appointed with VILLEROY & BOCH SANITARYWARE and HANSGRÖHE TAPWARE for a touch of elegance. A handy LAUNDRY CUPBOARD with space for a washing machine and tumble dryer adds further practicality. The property is equipped for the future with SOLAR PV and AIR SOURCE HEAT PUMPS, contributing to an impressive predicted A RATED 97 ENERGY ASSESSMENT SCORE, and includes an ELECTRIC VEHICLE CHARGING POINT for ultimate convenience. TWO CARPORT PARKING SPACES complete the offering, making this a truly exceptional home.

Step outside to discover a, LOVELY REAR GARDEN, the perfect setting for relaxing, entertaining, or enjoying family time in the sun.



Hall

Stairs to first floor and access to understairs storage

Living Room

14' 4" x 9' 11" (4.36m x 3.02m)

Kitchen/Dining

16' 7" x 13' 3" (5.05m x 4.04m)

Laundry**WC****Landing**

Access to airing cupboard

Bedroom 1

11' 11" x 13' 7" (3.64m x 4.14m)

Dimensions extend into wardrobe

En Suite**Bedroom 4 / Study**

16' 7" x 10' 4" (5.05m x 3.14m)

Landing**Bedroom 2**

16' 7" x 10' 8" (5.05m x 3.25m)

Bedroom 3

16' 7" x 10' 4" (5.05m x 3.14m)

Bathroom

Please note that images shown may not be of the exact finish, external handing and specification of this plot. The on site Sales Consultant(s) will be delighted to confirm plot specific finishes and finer details with you. Please note the floorplans may be in the opposite hand. As the designs maximise light and space, there may also be differences in certain window locations and positions. The on site Sales Consultant(s) will be delighted to confirm plot specific plans and layouts with you.



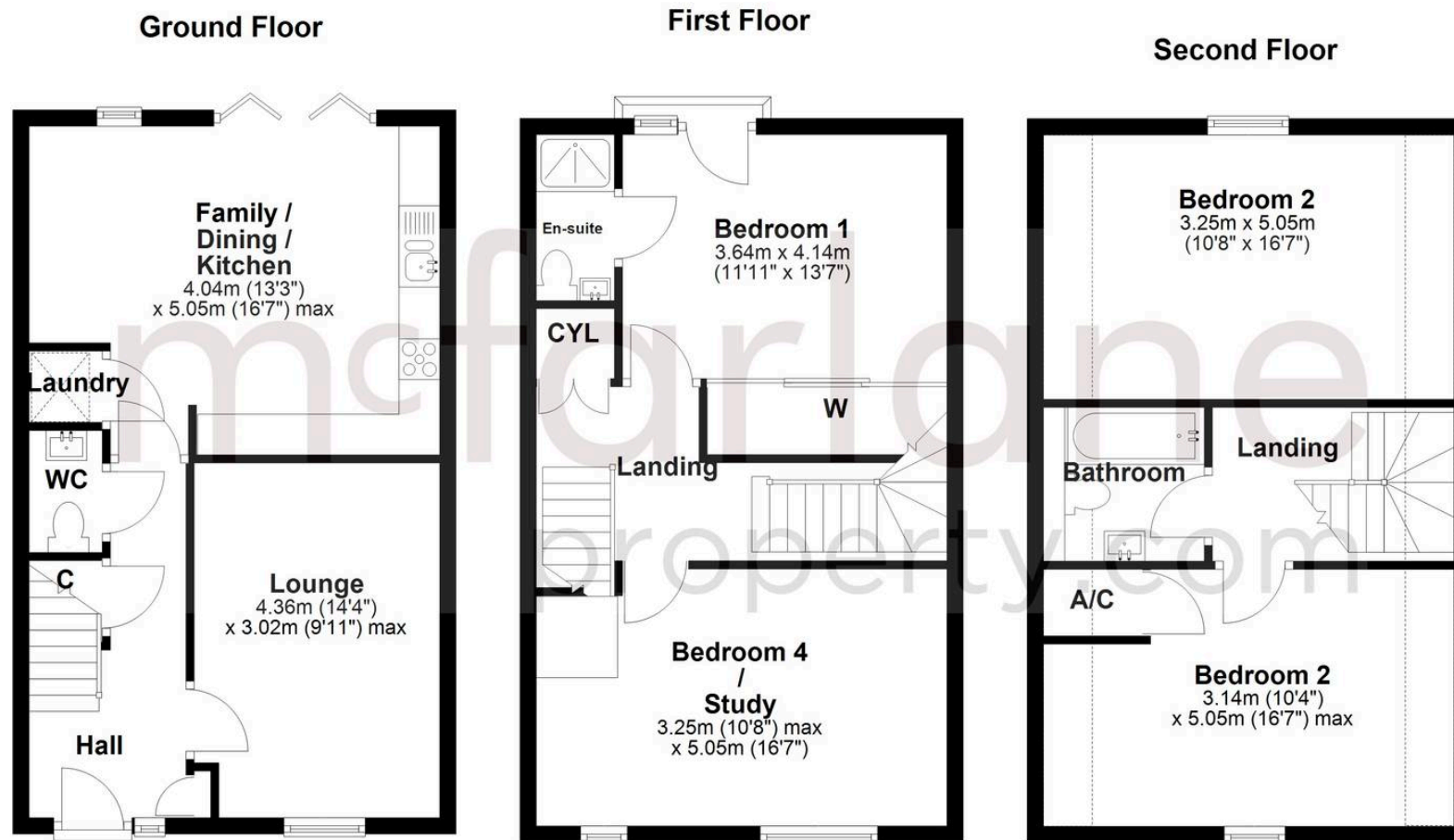

McFarlane Sales & Lettings

McFarlane Sales & Letting, 106 High Street – SN8 1LT

01672 514380 • marlborough@mcfarlaneproperty.com • www.mcfarlaneproperty.com/