



£200,000

PERLETHORPE AVENUE GEDLING

- SEMI-DETACHED HOUSE
- TWO DOUBLE BEDROOMS
- KITCHEN/DINER
- FOUR PIECE BATHROOM
- DRIVEWAY
- POPULAR LOCATION
- EPC D



Semi-Detached Home in a Popular Location

THIS TWO-BEDROOM SEMI-DETACHED HOUSE IS PERFECT FOR FIRST-TIME BUYERS, OFFERING BOTH COMFORT AND CONVENIENCE. LOCATED IN A POPULAR AREA, IT IS WITHIN EASY REACH OF LOCAL AMENITIES INCLUDING SHOPS AND SCHOOLS, AS WELL AS EXCELLENT COMMUTING LINKS.

ON THE GROUND FLOOR, YOU'LL FIND A WELCOMING LIVING ROOM WITH USEFUL UNDERSTAIRS STORAGE, ALONG WITH A SPACIOUS KITCHEN DINER IDEAL FOR EVERYDAY LIVING AND ENTERTAINING.

UPSTAIRS, THERE ARE TWO GENEROUSLY SIZED DOUBLE BEDROOMS, INCLUDING THE MAIN BEDROOM WHICH BENEFITS FROM BUILT-IN STORAGE, PLUS AN ADDITIONAL STORAGE CUPBOARD ON THE LANDING. A MODERN FOUR-PIECE BATHROOM SUITE COMPLETES THE FIRST FLOOR.

OUTSIDE, THE FRONT OF THE PROPERTY FEATURES A DRIVEWAY PROVIDING OFF-STREET PARKING, ALONG WITH A GARDEN AREA FEATURING A PATIO AND AN OUTHOUSE PROVIDING ADDITIONAL STORAGE.

- FREEHOLD
- COUNCIL TAX; BAND B
- LOCAL AUTHORITY; GEDLING BOROUGH COUNCIL
- MEASUREMENTS; 77 SQ METERS

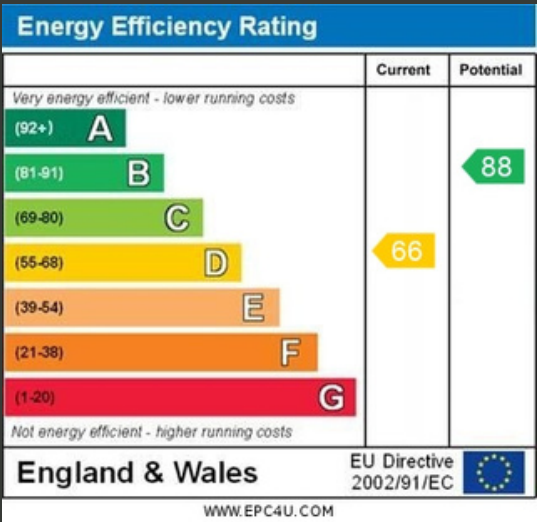



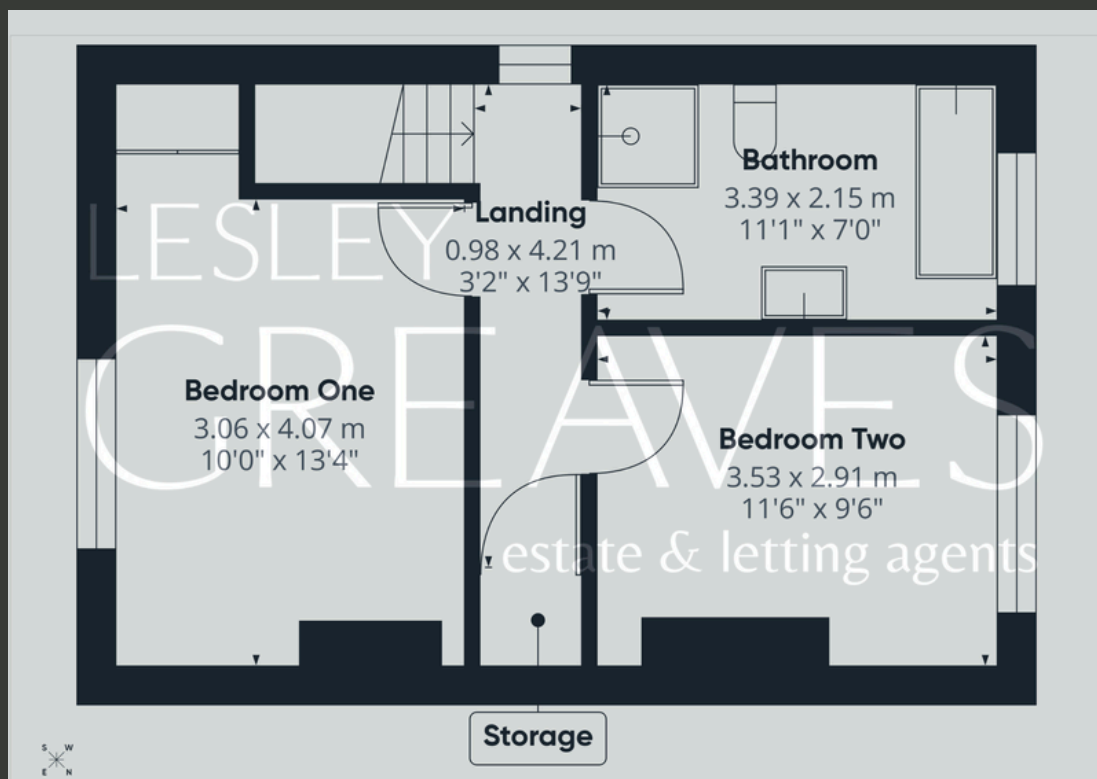
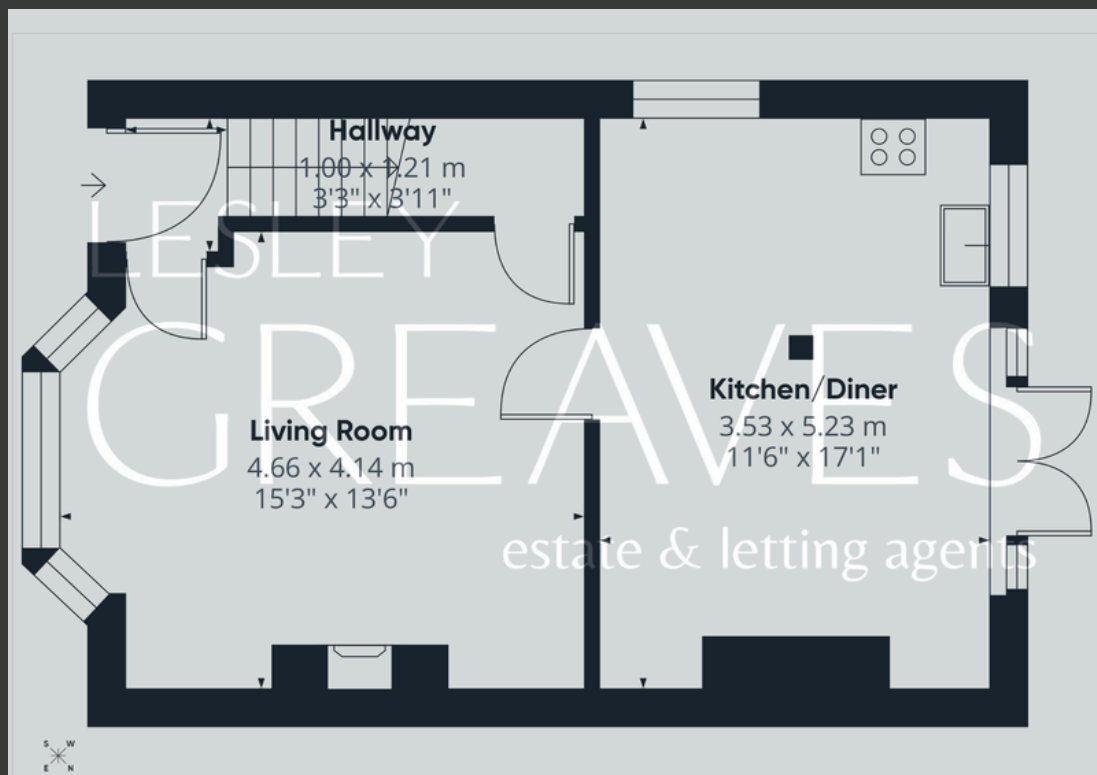

Agent's Note: These particulars have been prepared in good faith and are provided for guidance purposes only. While every effort has been made to ensure their accuracy, they should not be relied upon as exact. All measurements are approximate, and floor plans are for illustrative purposes only. Prospective buyers or tenants are advised to verify all details independently, conduct their own due diligence, and note that services, systems, and appliances have not been tested.

Lesley Greaves Estate & Lettings Agents

22 Main Road ,Gedling, Nottingham, NG4 3HP

0115 987 7337

sales@lesleygreaves.co.uk