



Fifth Avenue, London

£660,000 Share of Freehold

Welcome to Fifth Avenue - a stylish split-level apartment set on one of W10's most sought-after streets. This beautifully arranged home offers a highly desirable layout, featuring an open-plan kitchen and reception area that enjoys dual aspect light from the east and west, creating a bright and inviting living space with generous proportions. There are two well-sized double bedrooms, both thoughtfully positioned for privacy, along with two modern bathrooms and useful built-in storage throughout. The property is offered chain free with a share of freehold, providing long-term security and flexibility. Fifth Avenue sits within the heart of the historic Avenues-also known as the Queen's Park Estate-a neighbourhood celebrated for its distinctive late-Victorian architecture and strong community feel. The area's history has even been captured in a dedicated book, reflecting its cultural significance and unique character. Residents enjoy excellent proximity to transport links, including Queen's Park (Bakerloo & Overground) and Kensal Green stations, while the vibrant cafés and boutiques of Portobello Road are just a short stroll away.

- Period conversion
- Split level apartment
- Two double bedrooms
- Two bathrooms
- Fantastic location
- Great condition
- Desirable layout
- Chain free
- Share of freehold
- Close to shops and transports

FIFTH AVENUE

Approximate Gross Internal Area = 79.9 sq m / 860 sq ft

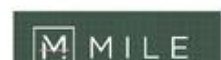
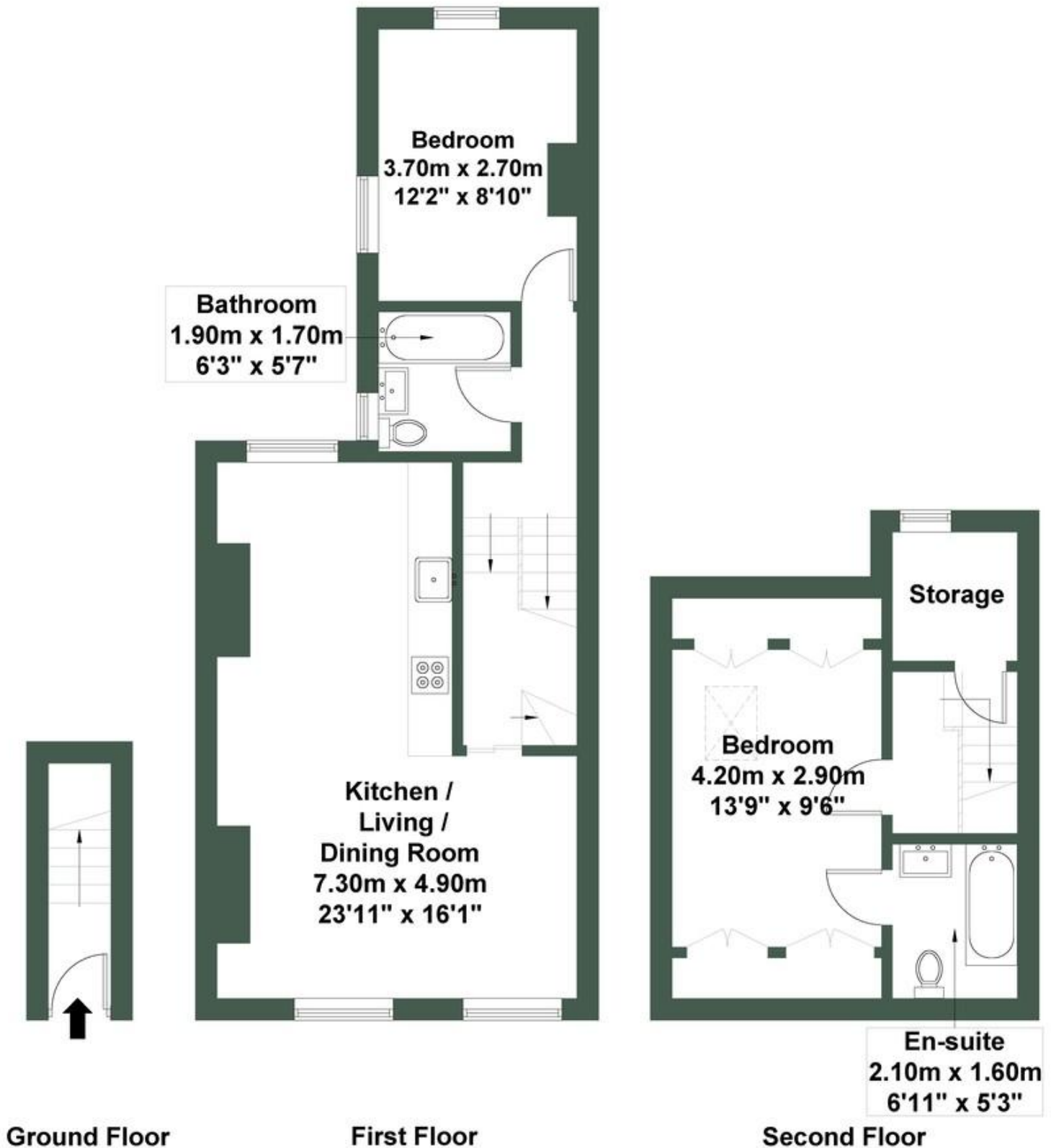
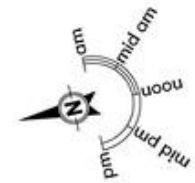

MONEY LAUNDERING REGULATIONS 2003: Intending purchasers will be asked to produce identification documentation at a later stage and we would ask for your co-operation in order that there will be no delay in agreeing the sale.

General: While we endeavour to make our sales particulars fair, accurate and reliable, they are only a general guide to the property and, accordingly, if there is any point which is of particular importance to you, please contact the office and we will be pleased to check the position for you, especially if you are contemplating travelling some distance to view the property.

Measurements: These approximate room sizes are only intended as general guidance. You must verify the dimensions carefully before ordering carpets or any built-in furniture.

Services: Please note we have not tested the services or any of the equipment or appliances in this property, accordingly we strongly advise prospective buyers to commission their own survey or service reports before finalising their offer to purchase.