



24 Hesketh Close, Cranleigh GU6 7JB
£95,000



ROGER COUPE
your local property experts

ESTATE AGENT
Est. 1991



24 Hesketh Close, Cranleigh

- Communal morning room
- Double glazed windows and gas fired heating
- For a 70% share
- Recently re-decorated
- Maintained communal grounds
- One Bedroom first floor Retirement flat
- Resident manager

For a 70% share, a first floor one bedroom apartment within this popular retirement development within a short level walk of the village centre. The property is freshly decorated throughout and features double glazing and gas fired heating. The property is set within communal grounds with a conservatory/morning room with tea and coffee making facilities, on site laundry and guest flat that can be rented for short term stays for family or friends. The property is offered for sale with no onward chain.

Council Tax band: B

Tenure: Leasehold

EPC Energy Efficiency Rating: C

EPC Environmental Impact Rating: C



Hesketh Close, Cranleigh

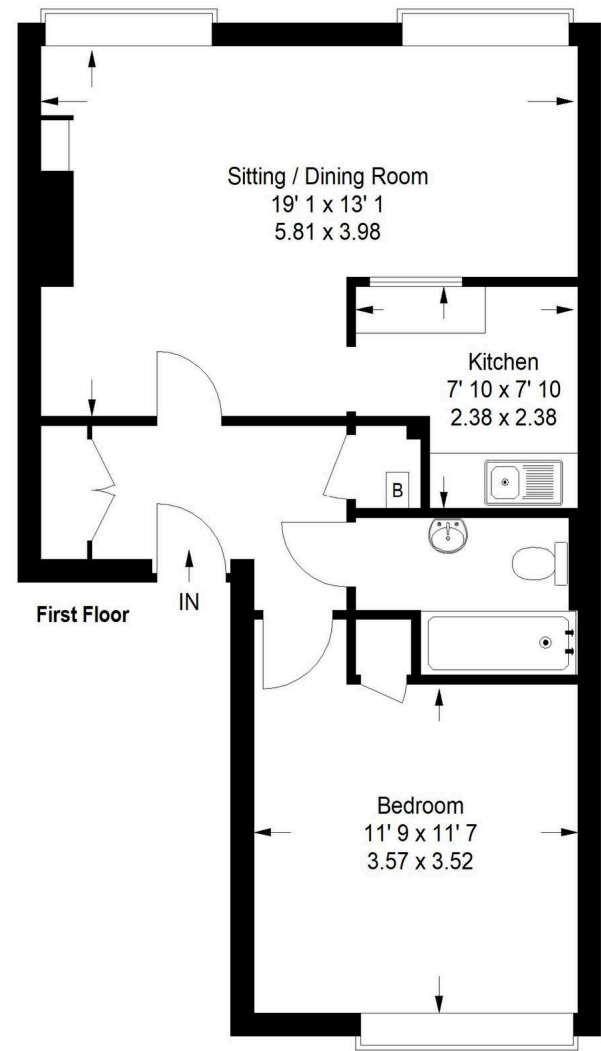

APPROX. GROSS
INTERNAL FLOOR AREA :
531SQFT / 49 SQM



This plan is for representation purposes only as defined by the RICS Code of Measuring Practice. Not drawn to scale unless stated. Please check all dimensions before making any decisions reliant upon them. No guarantee is given on square footage if quoted. Any figures if quoted should not be used as a basis for valuation.



Roger Coupe Estate Agent

Roger Coupe Estate Agent, 151 High Street - GU6 8BB

01483268555 • housesales@rogercoupe.com • www.rogercoupe.com



For clarification, these sales particulars have been prepared as a general guide. Room sizes are approximate and we have not carried out a detailed survey, nor tested any appliances, equipment, fixtures or services, so cannot verify that they are in working order, or fit for their purpose.