



5 Manor Farm Way, Seer Green

Guide Price £1,100,000

Ashington Page

Nestled in a quiet cul-de-sac in the heart of Seer Green, this beautifully presented and spacious four-bedroom detached home offers the perfect blend of comfort, style, and village living. Seer Green is a highly sought-after, picturesque village surrounded by scenic countryside walks and woodland.

Benefitting from a range of local amenities including shops, two pubs, a well-regarded primary school, a new private nursery, and a convenient train station with direct Chiltern Line services to London Marylebone, Oxford, and Birmingham.

Tenure: Freehold

EPC: C

Council Tax Band: G

These particulars are for guidance only. They are prepared and issued in good faith and are intended to give a fair summary of the property. Any description should not be relied on as a statement or representation of fact or that the property, or its services, are in good condition. The photographs show only certain parts of the property at the time they were taken. Any areas, measurements or distance given are approximate only. Any reference to alterations to, or use of, any part of the property is not a statement that any necessary planning, building regulations or other consent has been obtained. These matters must be verified by an intending purchaser. All statements contained in these particulars in relation to the property are made without responsibility of Ashington Page or its clients. Neither Ashington Page (nor any joint agents) nor any of their employees has any authority to make or give any representation or warranty whatsoever in relation to the property

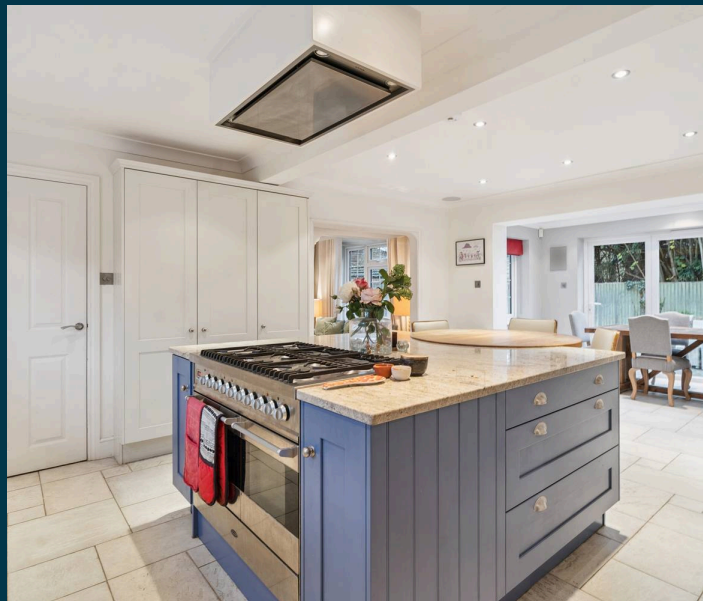
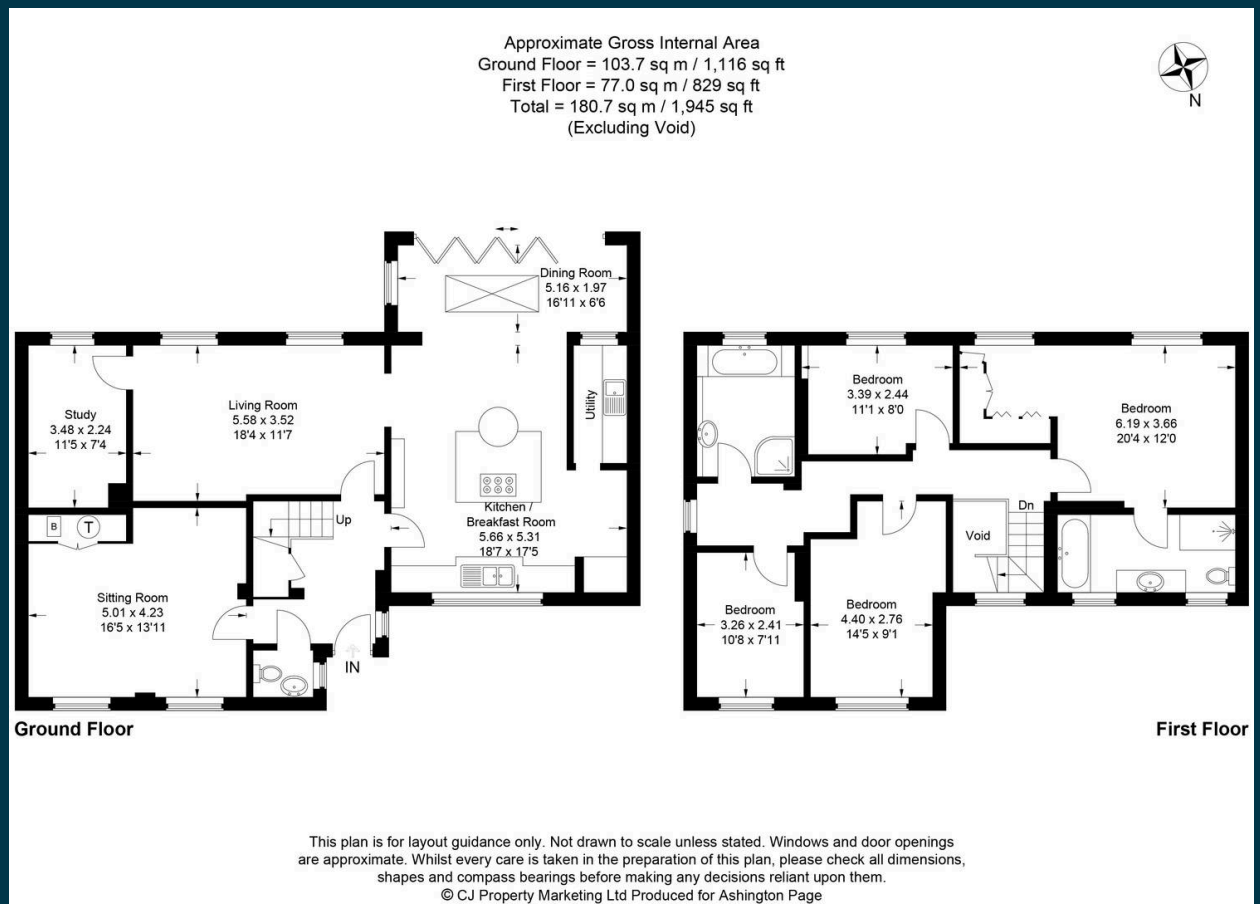

01494 680018
info@ashingtonpage.co.uk
www.AshingtonPage.co.uk

