



3 Bedroom Detached House located in Tiptree.

Find us on..



JOHN ALEXANDER
ESTATE AGENTS

Honey Lane
Tiptree
Colchester
CO5 0FR



3



2



1



EPC

TBC

£410,000

FULL DESCRIPTION

OVERVIEW

A contemporary and elegantly detached three-bedroom family residence situated in the sought-after Crest Nicholson development in the centre of Tiptree. This home is perfect for a family, providing convenient access to various schools, as well as a variety of nearby shops and amenities. The renowned Jam Factory and tea rooms in Tiptree are just steps away. Boasting three bedrooms, stylish modern decor, and ample parking, we strongly recommend scheduling a viewing to fully appreciate the charm and features of this remarkable property.

PROPERTY DETAILS

HALLWAY

KITCHEN

9' 11" x 15' 8" (3.02m x 4.78m)
LOUNGE

16' 3" x 13' 3" (4.95m x 4.04m)
CLOAKROOM

LANDING

BEDROOM ONE

8' 9" x 12' 9" (2.67m x 3.89m)
ENSUITE

BEDROOM TWO

8' 8" x 11' 5" (2.64m x 3.48m)

BEDROOM THREE

10' 5" x 7' 3" (3.18m x 2.21m)

FAMILY BATHROOM

7' 4" x 5' 7" (2.24m x 1.7m)

REAR GARDEN: Mainly laid to lawn, porcelain tiles, flower and shrub borders, shed to remain.





GROUND FLOOR
575 sq. ft. (53.4 sq. m.) approx.

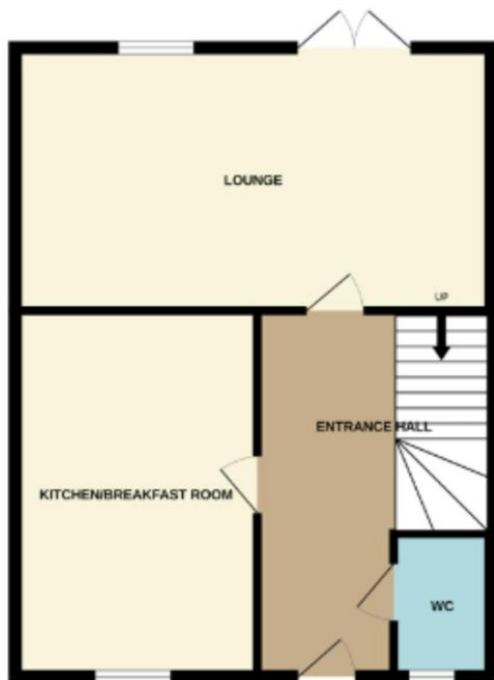

1ST FLOOR
565 sq. ft. (54.3 sq. m.) approx.

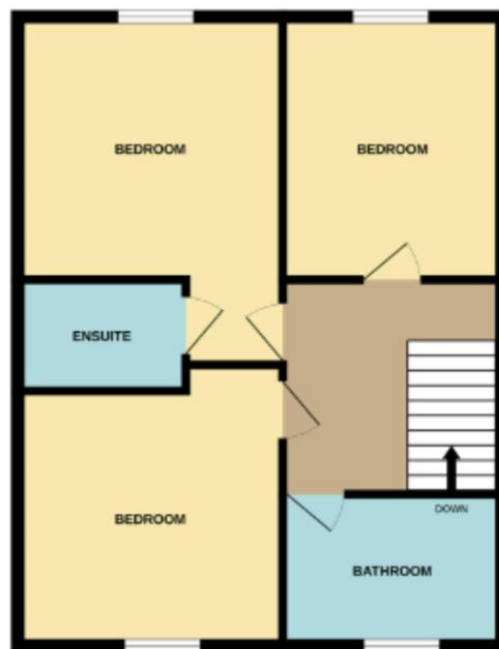

50 Honey Lane, Tiptree CO5 0FR

