



Lexington Place, Plumptre Street
£1,325 pcm

 **Comfort**
Estates



Lexington Place

Plumpton Street, Nottingham

Stunning penthouse apartment located on Plumpton Street in Nottingham's sought-after Lace Market district.

This impressive property features two double bedrooms, including a main bedroom with an en-suite, along with a further modern main bathroom. The fully fitted kitchen comes complete with all appliances, and the spacious living/dining area offers an ideal space for relaxing. The standout feature is the fabulous private balcony boasting far-reaching views across Nottingham.

Perfectly positioned, the apartment is just a short walk from Nottingham Train Station, plenty of other transport links and all the shops, bars, cafés and amenities of the City Centre. Position in the Lace Market, which is a historic quarter-mile square area in the centre of Nottingham. It was once the centre of the world's lace industry, which is now home to many apartments and offices.

Additional benefits include one allocated, secure parking space.

Offered furnished and available from 6th February 2026.





Kitchen

10' 6" x 9' 0" (3.19m x 2.74m)

Fully fitted kitchen featuring cream gloss wall and base cabinets, wood-effect worktops, and a stainless steel sink with draining board. Appliances include an electric hob, oven, extractor fan, fridge/freezer, dishwasher and washing machine – everything you need for convenient, modern living.

Hallway

13' 3" x 12' 9" (4.05m x 3.89m)

Neutrally decorated hallway with freestanding shelving unit.

Bedroom

16' 10" x 10' 10" (5.13m x 3.30m)

A spacious double bedroom complete with an en-suite bathroom and built-in storage cupboard (housing the hot water tank). The room benefits from large windows that allow plenty of natural light in and comes furnished with a bed, mattress and generous wardrobe.

En-suite Bathroom

8' 1" x 5' 7" (2.47m x 1.70m)

En-suite bathroom fitted with a shower cubicle, toilet, wash basin, heated towel rail, wall-mounted mirror and shelving. The room is finished with white tiles, white walls and easy-to-maintain vinyl flooring.

Bedroom 2

10' 1" x 9' 11" (3.07m x 3.03m)

A further double bedroom featuring floor-to-ceiling windows that flood the space with natural light. The room comes furnished with a bed, mattress and desk.



Bathroom

7' 3" x 6' 4" (2.20m x 1.94m)

The main bathroom is located between the two bedrooms, neutrally decorated with marble effect wall tiles, white walls and vinyl flooring. The bathroom has a shower over bath, toilet, wash basin, heated towel rail, wall mounted mirror and shelves.

Lounge/Diner

21' 5" x 9' 7" (6.53m x 2.91m)

Spacious and bright living/dining area, benefiting from its penthouse position with floor-to-ceiling windows on two sides, offering impressive views across Nottingham. The room is furnished with a corner sofa and coffee table and enjoys direct access to the fantastic balcony space.







Approximate Gross Internal Area
753 sq ft - 70 sq m

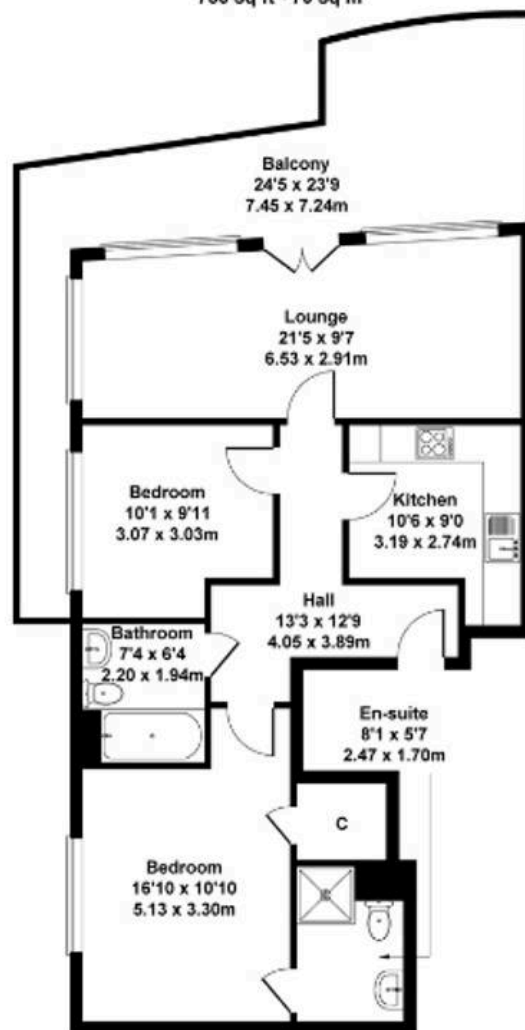

Not to Scale. Produced by The Plan Portal 2025
For Illustrative Purposes Only.



Comfort Estates

Comfort Estates, 47 Derby Road - NG1 5AW

0115 9338997 • info@comfortestates.co.uk • www.comfortestates.co.uk