



## **GOREY VILLAGE 3 BED BUNGALOW**

4 THE SHEILINGS

GOREY VILLAGE MAIN ROAD, GROUVILLE, JERSEY, JE3 9EP

**Guide Price Reduced To £465,000**



# GOREY VILLAGE 3 BED BUNGALOW

4 THE SHEILINGS

GOREY VILLAGE MAIN ROAD,  
GROUVILLE, JERSEY, JE3 9EP

Ref No: JES150065 • 3 bedrooms • 1 bathroom •  
1 reception room • Utility room • Terraced patio  
garden • Outbuildings for storage • Parking x3 •  
902 sq ft • Qualified

## Situation

Quietly located in a quiet cul de sac in Gorey Village and close by to which offers a convenience stores including: post office, chemist, grocery stores, dry cleaners, butcher and gift shops. Local pubs and restaurants are only a few minutes walk away.

## Description

A detached bungalow built in the 1950's and accessed via a private road. Original features including beautiful parquet flooring and open fire place. Accommodation consists of: 2 good sized double bedrooms and a third single bedroom, 1 bathroom, spacious reception with a real fire, eat in kitchen, large storage sheds to the rear of the property.

## Outside

Attractive low maintenance terraced patio to the side of the house. Parking for 3 cars.

## Services

All mains, no gas, wired for digital TV and the Internet. Electric comfort heating.

## Viewing

Strictly by appointment with Savills.



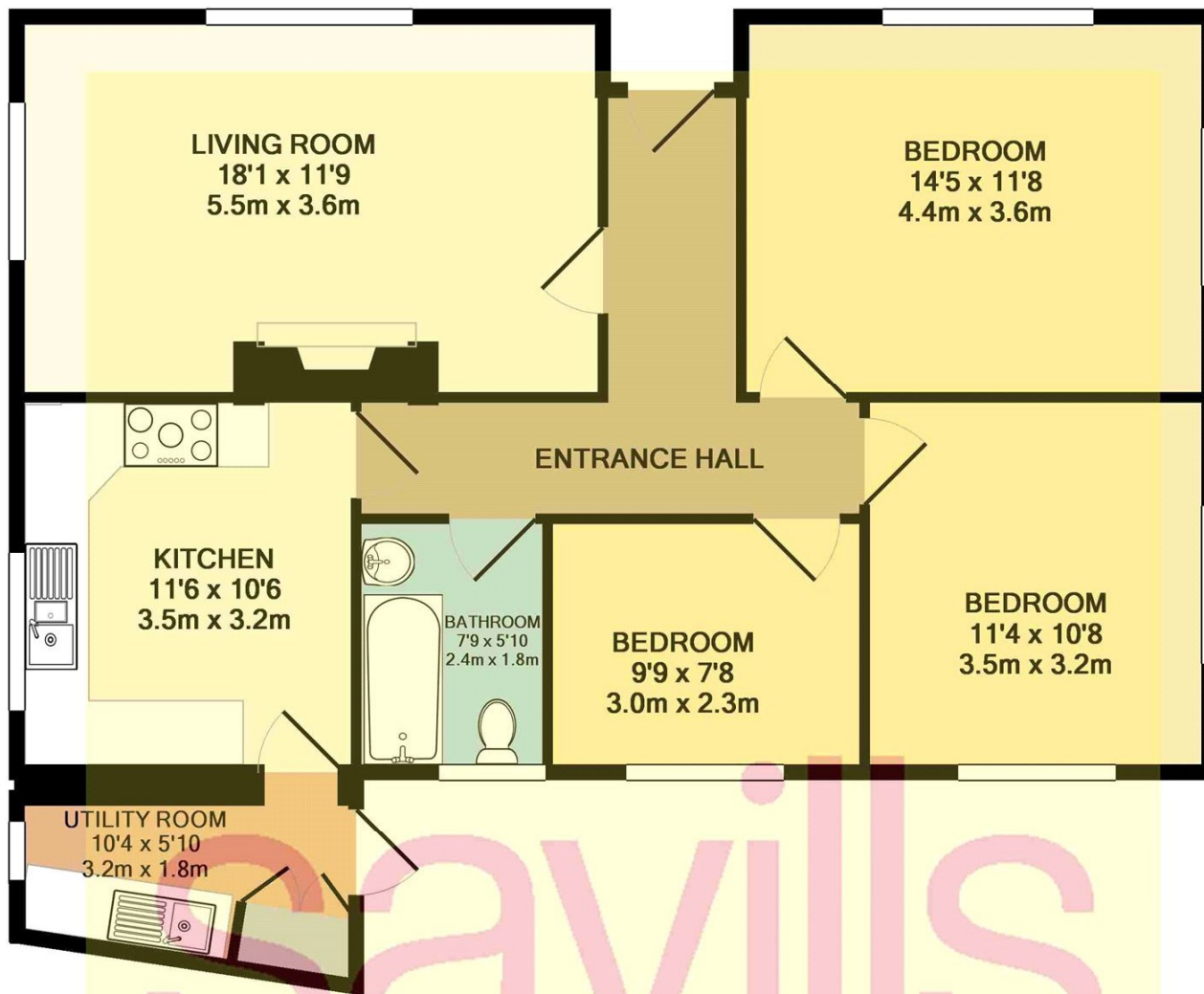

TOTAL APPROX. FLOOR AREA 902 SQ.FT. (83.8 SQ.M.)

Whilst every attempt has been made to ensure the accuracy of the floor plan contained here, all measurements are approximate and no responsibility is taken for any errors. You may not make a permanent copy of or reproduce this floor plan in any form as the intellectual rights belong to Jersey Floor Plans.  
Made with Metropix ©2015





**Savills Jersey**

**+44 (0) 1534 722 227**

**savills.je**

---

Important notice: Savills, their clients and any joint agents give notice that: 1: They are not authorised to make or give any representations or warranties in relation to the property either here or elsewhere, either on their own behalf or on behalf of their client or otherwise. They assume no responsibility for any statement that may be made in these particulars. These particulars do not form part of any offer or contract and must not be relied upon as statements or representations of fact. 2: Any areas, measurements or distances are approximate. The text, photographs and plans are for guidance only and are not necessarily comprehensive. It should not be assumed that the property has all necessary planning, building regulation or other consents and Savills have not tested any services, equipment or facilities. Purchasers must satisfy themselves by inspection or otherwise.